

2/2 Normally Closed - NPT threads

Port Size NPT	Orifice		Flow Factors		Minimum Pressure		Maximum Differential		Fluid Temp.		Seat Seal	Part Number	Description	Coil Group	Dwg. No.
	mm	inch	m ³ /h	gpm	bar	PSI	bar	PSI	Min °C	Max °C					
3/8"	13	0.51	3.0	13.23	0.1	1.45	20	290	-10	90	NBR	444107W	7321BIN90	2.0/2.1/2.2	1
	13	0.51	3.0	13.23	0.1	1.45	10	145	-10	140	EPDM	444209W ₁	7321BIH90	2.0/2.1/2.2	1
1/2"	13	0.51	3.0	13.23	0.1	1.45	20	290	-10	90	NBR	444108W	7321BAN90	2.0/2.1/2.2	1
	13	0.51	3.0	13.23	0.1	1.45	10	145	-10	140	EPDM	444210W ₁	7321BAH90	2.0/2.1/2.2	1
3/4"	20	0.78	8.4	37.04	0.1	1.45	20	290	-10	90	NBR	444109W	7321BCN90	2.0/2.1/2.2	2
	20	0.78	8.4	37.04	0.1	1.45	10	145	-10	140	EPDM	444211W ₁	7321BCH90	2.0/2.1/2.2	2
1"	25	0.98	9.6	42.34	0.1	1.45	20	290	-10	90	NBR	444110W	7321BDN90	2.0/2.1/2.2	2
	25	0.98	9.6	42.34	0.1	1.45	10	145	-10	140	EPDM	444606W ₁	7321BDH90	2.0/2.1/2.2	2
1 1/4"	35	1.37	25.2	111.13	0.1	1.45	10	145	-10	90	NBR	444168W	7321BEN90	2.0/2.1/2.2	3
1 1/2"	40	1.56	30.0	132.30	0.1	1.45	10	145	-10	90	NBR	444169W	7321BFN90	2.0/2.1/2.2	3
2"	50	1.95	37.2	164.05	0.1	1.45	10	145	-10	90	NBR	444119W	7321BGN90	2.0/2.1/2.2	3

Notes:

1. Maximum pressure for steam: 4 bar (140 °C)

2/2 Normally Open - NPT threads

Port Size NPT	Orifice		Flow Factors		Minimum Pressure		Maximum Differential		Fluid Temp.		Seat Seal	Part Number	Description	Coil Group	Dwg. No.
	mm	inch	m ³ /h	gpm	bar	PSI	bar	PSI	Min °C	Max °C					
3/8"	13	0.51	3.0	13.23	0.1	1.45	20	290	-10	90	NBR	444234W	7322BIN90	2.0/2.1/2.2	1
	13	0.51	3.0	13.23	0.1	1.45	10	145	-10	140	EPDM ₁	444613W	7322BIH90	2.0/2.1/2.2	1
1/2"	13	0.51	3.0	13.23	0.1	1.45	20	290	-10	90	NBR	444610W	7322BAN90	2.0/2.1/2.2	1
3/4"	20	0.78	8.4	37.04	0.1	1.45	20	290	-10	90	NBR	444611W	7322BCN90	2.0/2.1/2.2	2
	20	0.78	8.4	37.04	0.1	1.45	10	145	-10	140	EPDM ₁	444109W	7322BCH90	2.0/2.1/2.2	2
1"	25	0.98	9.6	42.34	0.1	1.45	20	290	-10	90	NBR	444612W	7322BDN90	2.0/2.1/2.2	2
	25	0.98	9.6	42.34	0.1	1.45	10	145	-10	140	EPDM ₁	444110W	7322BDH90	2.0/2.1/2.2	2
1 1/4"	35	1.37	25.2	111.13	0.1	1.45	10	145	-10	90	NBR	444320W	7322BEN90	2.0/2.1/2.2	3
	35	1.37	25.2	111.13	0.1	1.45	10	145	-10	140	EPDM ₁	444576W	7322BEH90	2.0/2.1/2.2	3

Notes:

1. Maximum pressure for steam: 4 bar (140 °C)

Dimensional Drawings

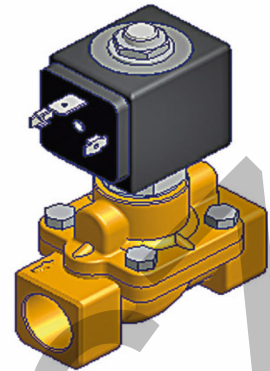
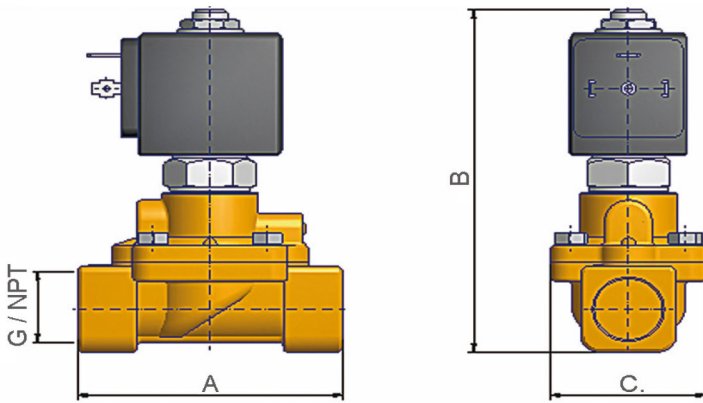

Function	Connections		A		B		C	
	BSP	NPT	mm	inch	mm	inch	mm	inch
Normally Closed	3/8"		69	2.71	99.5	3.91	40	1.57
	1/2"		72	2.83	101.5	3.99	40	1.57
Normally Open	3/8"		69	2.71	110	4.33	40	1.57
	1/2"		72	2.83	112	4.41	40	1.57

Dimensional Drawing 1

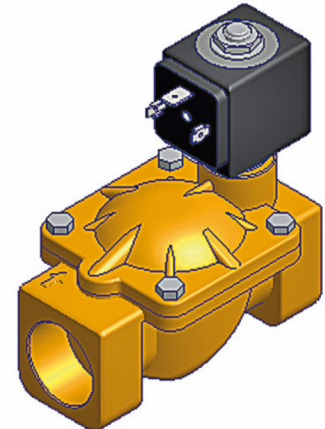
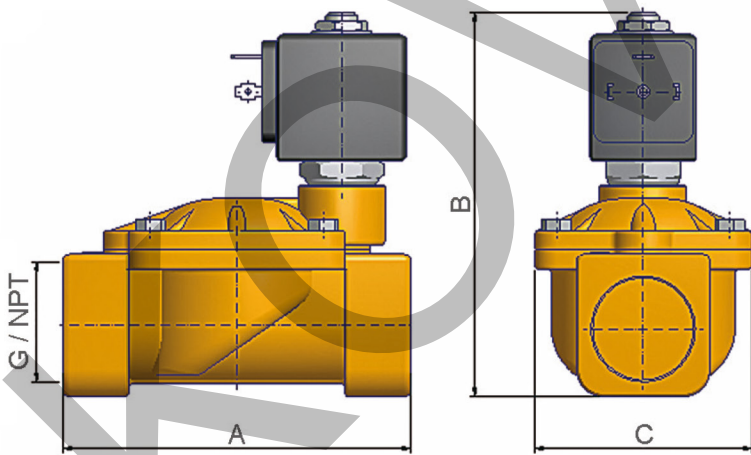

Function	Connections		A		B		C	
	BSP	NPT	mm	inch	mm	inch	mm	inch
Normally Closed	3/4"		100	3.83	107	4.21	65	2.55
	1"		104	4.09	112.5	4.42	65	2.55
Normally Open	3/4"		100	3.83	117.5	4.62	65	2.55
	1"		104	4.09	123	4.84	65	2.55

Dimensional Drawing 2

Dimensional Drawings

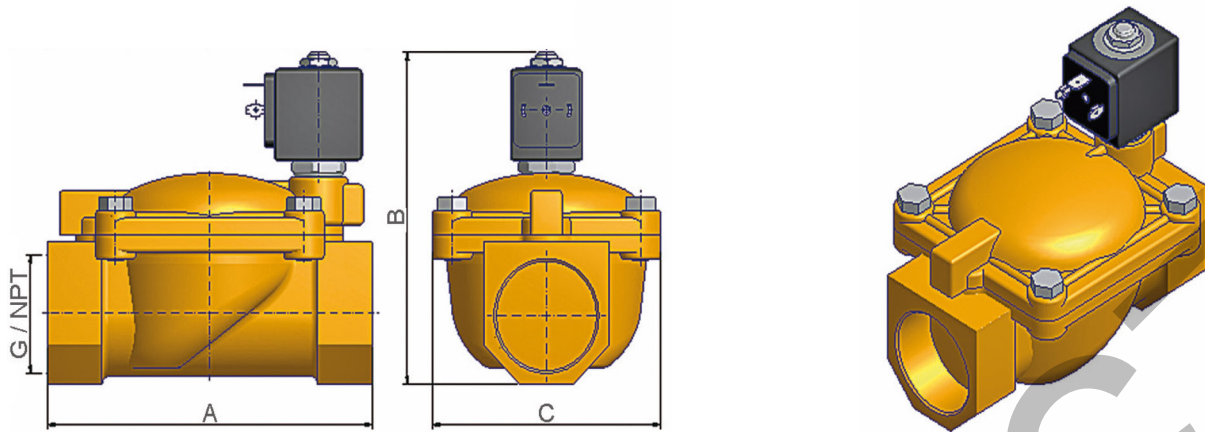

Function	Connections		A		B		C	
	BSP	NPT	mm	inch	mm	inch	mm	inch
Normally Closed	1 1/4"		145	5.70	134	5.27	102	4.01
	1 1/2"		145	5.70	134	5.27	102	4.01
	2"		173	6.81	148	5.82	118	4.64
Normal Open	1 1/4"		145	5.70	144.5	5.68	102	4.01
	1 1/2"		145	5.70	134	5.27	102	4.01
	2"		173	6.81	148	5.82	118	4.64

Dimensional Drawing 3

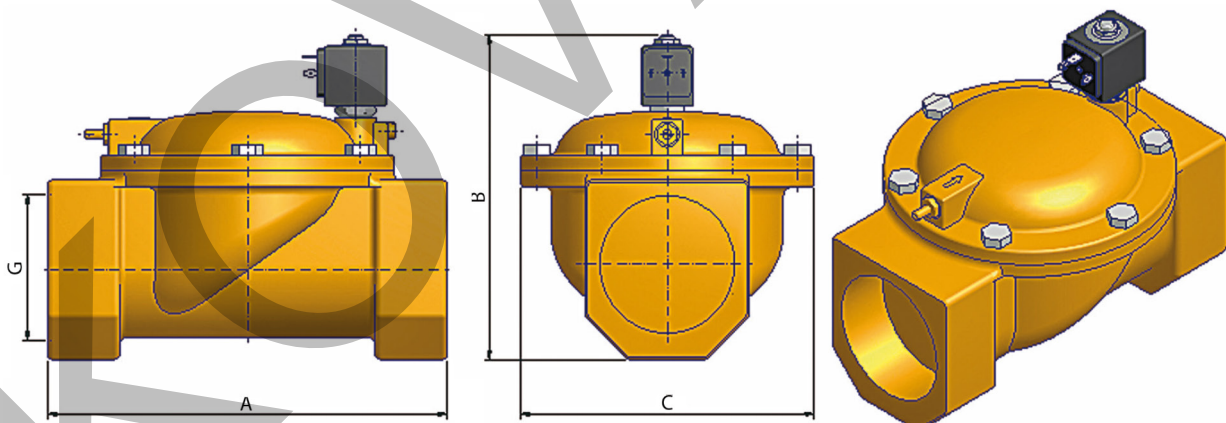

Function	Connections	A		B		C	
		mm	inch	mm	inch	mm	inch
Normally Closed	2 1/2"	245	9.64	195	7.67	184	7.24
	3"	250	9.84	195	7.67	184	7.24
Normally Open	2 1/2"	245	9.64	205	8.07	184	7.24
	3"	245	9.64	205	8.07	184	7.24

Dimensional Drawing 4