

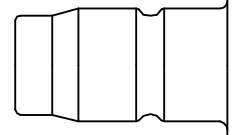

Industrial coupling with Scandinavian Profile. Coupling system with single-hand operation. High Flow valve for optimum flow and low pressure drop. Optimal for use with large pneumatic consumers due to the robust design and steel sleeve. The collar design minimises damage to the valve body.

- Available on request:
 - with additional end connections
 - other seals for different temperature ranges and fluids



Scandinavian Profile

Dust Protections (P. 357)
for Coupling Part.-No. SK27S

KA
Single Shut-Off

Working Pressure*:
up to 35 bar

Material:

- Coupling: Nickel plated brass / steel
- Plug: Nickel plated steel
- Seals: NBR

Working Temperature:
-20°C up to +100°C (NBR)

Flow Rate Air:
2.550 l/min.
inlet pressure 6 bar, pressure drop 0.5 bar

Flow Rate Water:
30 l/min.
pressure drop 0.5 bar

* maximum static working pressure with design factor 4 to 1.

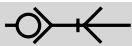

Single Shut-Off

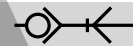

Single Shut-Off

34KAAK Coupler with valve, Male Thread

Nickel-plated brass/steel, NBR

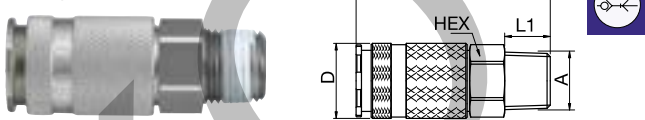

| A | | HEX | L | L1 | D |
|------|-------------|-----|----|----|----|
| R3/8 | 34KAAK17SPN | 24 | 70 | 12 | 28 |
| R1/2 | 34KAAK21SPN | 24 | 72 | 12 | 28 |
| R3/4 | 34KAAK26SPN | 27 | 72 | 12 | 28 |

34KATF Coupler with valve, Hose Barb

Nickel-plated brass/steel, NBR

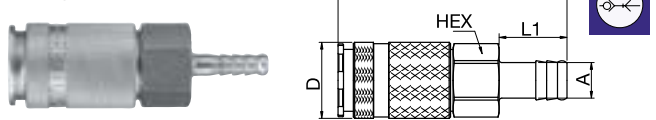

| A | | HEX | L | L1 | D |
|----|-------------|-----|----|----|----|
| 10 | 34KATF10SPN | 24 | 84 | 25 | 28 |
| 13 | 34KATF13SPN | 24 | 84 | 25 | 28 |
| 16 | 34KATF16SPN | 24 | 84 | 25 | 28 |
| 19 | 34KATF19SPN | 24 | 84 | 25 | 28 |

34KAIW Coupler with valve, Female Thread

Nickel-plated brass/steel, NBR

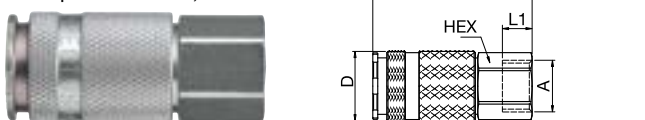

| A | | HEX | L | L1 | D |
|------|-------------|-----|------|----|----|
| G3/8 | 34KAIW17SPN | 24 | 64 | 12 | 28 |
| G1/2 | 34KAIW21SPN | 24 | 64 | 12 | 28 |
| G3/4 | 34KAIW26SPN | 32 | 68.5 | 14 | 28 |

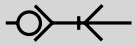

Single Shut-Off

34SFAK Plug without valve, Male Thread

Nickel-plated steel

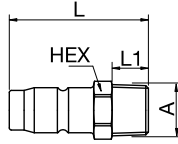

A

HEX L L1

| | | | | |
|------|--------------------|----|----|----|
| R1/4 | 34SFAK13SXN | 17 | 46 | 12 |
| R3/8 | 34SFAK17SXN | 19 | 46 | 12 |
| R1/2 | 34SFAK21SXN | 22 | 52 | 17 |

34SFIW Plug without valve, Female Thread

Nickel-plated steel

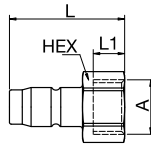

A

HEX L L1

| | | | | |
|------|--------------------|----|----|----|
| G3/8 | 34SFIW17SXN | 19 | 40 | 9 |
| G1/2 | 34SFIW21SXN | 24 | 44 | 12 |

34SFTF Plug without valve, Hose Barb

Nickel-plated steel

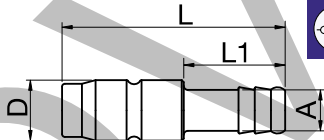

A

L L1 D

| | | | | |
|----|--------------------|----|----|----|
| 10 | 34SFTF10SXN | 55 | 25 | 15 |
| 13 | 34SFTF13SXN | 55 | 25 | 15 |