

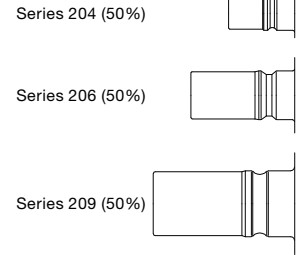

Dry-break coupling system for applications in sensitive environments, for example in analysis technology, in cooling systems, in transport systems and many applications with aggressive media. Coupling system with single-hand operation, extremely low leakage rates and minimal dead space volume. Absolutely no air pockets when coupling and only a barely noticeable film of the medium being channelled on the valve bodies when uncoupling. Ergonomic sleeve design. Low coupling forces. Valve body protected by collar design.

- Available on request:
 - other seals for different temperature ranges and fluids



Working Pressure*:
up to 15 bar

Material:

- Coupling: Nickel plated brass or AISI 316L
- Plug: Nickel plated brass or AISI316L
- Seals: NBR or FKM

Working Temperature:

-20°C up to +100°C (NBR)
-15°C bis +200°C (FKM)

Flow Rate Water:

- Series 204: 4.5 l/min.
 - Series 206: 8.9 l/min.
 - Series 209: 27 l/min.
- pressure drop 0.5 bar

* maximum static working pressure with design factor 4 to 1.



Dry-Break

200KLAW Coupler with valve, Male Thread

Nickel-plated brass or stainless steel, NBR or FKM

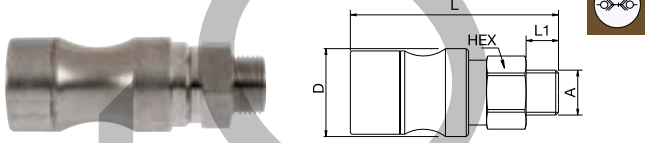

DN	A	Version	HEX	L	L1	D
4	G1/8	204KLAW10MPN	14	45	7	19
4	G1/8	204KLAW10EVX	14	45	7	19
4	G1/4	204KLAW13MPN	17	47	9	19
4	G1/4	204KLAW13EVX	17	47	9	19
6	G3/8	206KLAW17MPN	22	69	9	25.5
6	G3/8	206KLAW17EVX	22	69	9	25.5
6	G1/2	206KLAW21MPN	22	72	12	25.5
6	G1/2	206KLAW21EVX	24	72	12	25.5



Dry-Break

200KLIW Coupler with valve, Female Thread

Nickel-plated brass or stainless steel, NBR or FKM

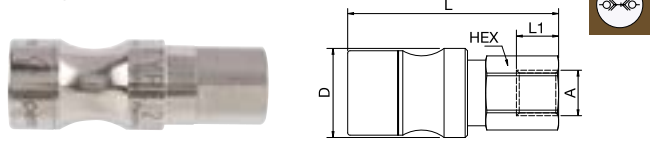

DN	A	Version	HEX	L	L1	D
4	G1/8	204KLIW10MPN	14	45	9	19
4	G1/8	204KLIW10EVX	14	45	9	19
4	G1/4	204KLIW13MPN	17	47	9	19
4	G1/4	204KLIW13EVX	17	47	9	19
6	G3/8	206KLIW17MPN	22	69	7	25.5
6	G3/8	206KLIW17EVX	22	69	9	25.5
6	G1/2	206KLIW21MPN	24	72	10	25.5
6	G1/2	206KLIW21EVX	24	72	12	25.5
9	G1/2	209KLIW21MPN	27	92	14	33
9	G1/2	209KLIW21EVX	27	92	16	33
9	G3/4	209KLIW26MPN	32	94	14	33
9	G3/4	209KLIW26EVX	32	94	16	33

Series 200 - Dry-break



Dry-Break

200SLAW Plug with valve, Male Thread

Nickel-plated brass or stainless steel, NBR or FKM

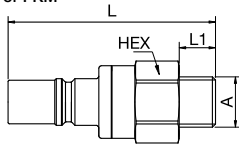

DN	A		HEX	L	L1	Version
4	G1/8	204SLAW10MPN	14	40	7	Nickel-plated brass
4	G1/8	204SLAW10EVX	14	40	7	AISI 316L
4	G1/4	204SLAW13MPN	17	42	9	Nickel-plated brass
4	G1/4	204SLAW13EVX	17	42	9	AISI 316L
6	G3/8	206SLAW17MPN	22	51	9	Nickel-plated brass
6	G3/8	206SLAW17EVX	22	55	9	AISI 316L
6	G1/2	206SLAW21MPN	22	54	12	Nickel-plated brass
6	G1/2	206SLAW21EVX	24	54	12	AISI 316L

200SLIW Plug with valve, Female Thread

Nickel-plated brass or stainless steel, NBR or FKM

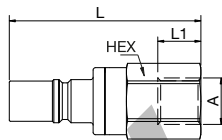

DN	A		HEX	L	L1	Version
4	G1/8	204SLIW10MPN	14	40	9	Nickel-plated brass
4	G1/8	204SLIW10EVX	14	40	9	AISI 316L
4	G1/4	204SLIW13MPN	17	42	7	Nickel-plated brass
4	G1/4	204SLIW13EVX	17	42	9	AISI 316L
6	G3/8	206SLIW17MPN	22	51	7	Nickel-plated brass
6	G3/8	206SLIW17EVX	22	51	9	AISI 316L
6	G1/2	206SLIW21MPN	24	54	10	Nickel-plated brass
6	G1/2	206SLIW21EVX	24	54	12	AISI 316L
9	G1/2	209SLIW21MPN	27	80	14	Nickel-plated brass
9	G1/2	209SLIW21EVX	27	80	16	AISI 316L
9	G3/4	209SLIW26MPN	32	82	14	Nickel-plated brass
9	G3/4	209SLIW26EVX	32	82	16	AISI 316L



Dry-break cartridge couplings without locking mechanism made of stainless steel. Available in five different sizes for modular block/plate assembly in sensitive environments. Different coupling sizes can be combined to one multicoupling depending on the application requirements.



Working Pressure*:
up to 15 bar

Material:

- **Coupling:** Nickel plated brass or Stainless Steel
- **Plug:** Nickel plated brass or Stainless Steel
- **Seals:** NBR or FKM

Working Temperature:
-20°C up to +100°C (NBR)
-15°C bis +200°C (FKM)

Flow Rate Water:

- **Series 203:** 1.2 l/min.
- **Series 204:** 4.5 l/min.
- **Series 206:** 8.9 l/min.
- **Series 209:** 27 l/min.
- **Series 212:** 32l/min. pressure drop 0.5 bar

* maximum static working pressure with design factor 4 to 1.



Dry-Break

200KLIWEK Coupler with valve, Female Thread

Stainless Steel AISI 316 L, FKM

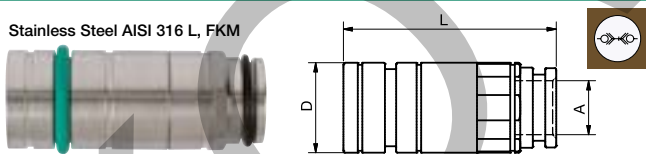

DN	A		L	D
3	G1/16	203KLIW08EVXEK	23	11
4	G1/8	204KLIW10EVXEK	35	16
6	G1/4	206KLIW13EVXEK	54	21
9	G3/8	209KLIW17EVXEK	59	25
12	G1/2	212KLIW21EVXEK	71	32



Dry-Break

200SLIWEK Plug with valve, Female Thread

Stainless Steel AISI 316 L, FKM

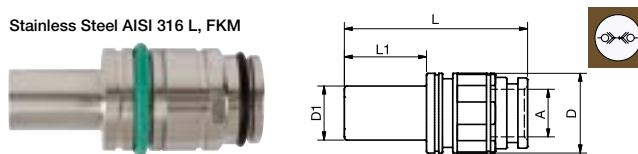

DN	A		L	L1	D	D1
3	G1/16	203SLIW08EVXEK	30	12	11	5.3
4	G1/8	204SLIW10EVXEK	42	15	16	8.4
6	G1/4	206SLIW13EVXEK	51	19	21	12.5
9	G3/8	209SLIW17EVXEK	56	26	25	17
12	G1/2	212SLIW21EVXEK	70	28	30	20

Series 200 - Dry-break - Cartridge Couplings

Technical Features for block- and plate assembly – Tolerances for production of the holder on request.

Block Assembly

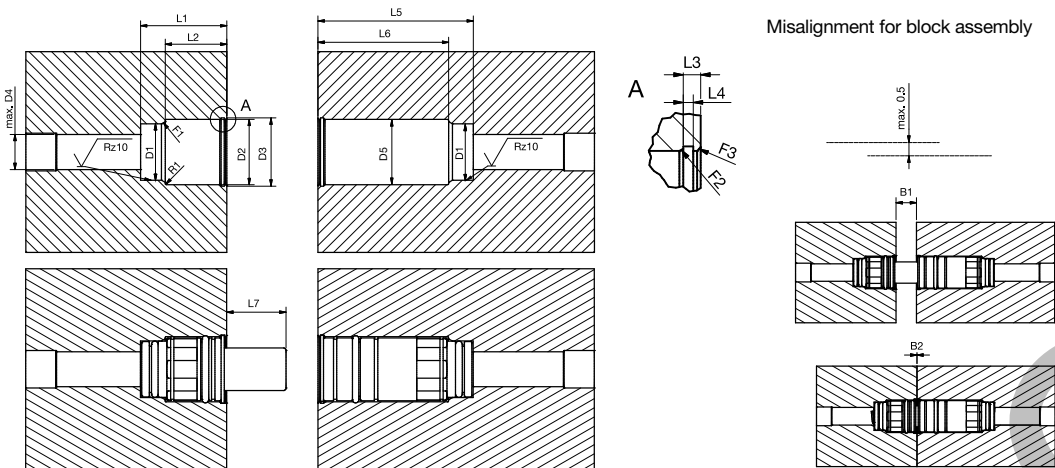
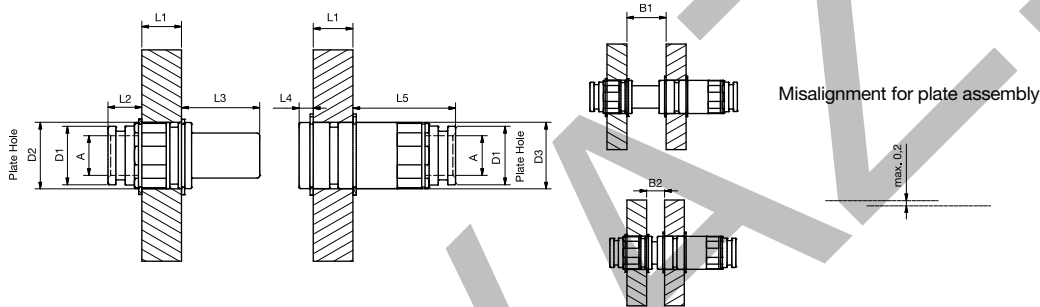

Plate Assembly



Block Assembly

DN mm	L1 mm	L2 mm	L3 mm	L4 mm	L5 mm	L6 mm	L7 mm	D1 mm	D2 mm	D3 mm	D4 max. mm	D5 mm	R1 max. mm	F1	F2	F3	B1	B2
3	20,10	15,00	2,10	1,10	23,60	18,50	8,75	10,00	12,00	12,50	8,00	12,00	0,50	0,8x30°	–	0,5x45°	5,00	0
4	29,00	22,50	2,10	1,10	37,80	31,35	13,00	14,00	17,00	17,80	10,00	17,00	0,50	1,2x30°	0,5x30°	0,5x45°	8,65	0
6	34,25	26,65	2,10	1,10	55,80	48,20	17,00	18,50	22,00	23,00	12,00	22,00	0,50	1,3x30°	0,5x30°	0,5x45°	11,40	0
9	33,80	24,30	2,30	1,30	61,30	51,80	23,60	22,50	26,00	27,20	14,00	26,00	0,50	1,5x30°	0,5x30°	0,5x45°	16,30	0
12	44,00	34,40	2,30	1,30	73,20	63,60	25,80	28,00	31,00	32,70	16,00	33,00	0,50	1,5x30°	0,8x30°	0,5x45°	15,80	0
19	53,15	41,50	3,15	1,85	80,20	68,50	29,25	33,00	42,00	44,50	23,00	45,00	1,50	1,5x30°	1,0x30°	0,8x45°	20,30	0

Plate Assembly

DN mm	L1 mm	L2 mm	L3 mm	L4 mm	L5 mm	L6 mm	L7 mm	D1 mm	D2 mm	D3 mm	Connection A	F1	F2	F3	B1	B2
3	5,00	11,00	12,75	5,50	11,00			9,80	11,2	11,2	G 1/16				16,70	11,70
4	15,00	9,80	17,20	5,50	15,35			13,80	16,2	16,2	G 1/8				20,50	12,70
6	15,00	13,15	23,00	5,50	33,20			18,30	21,2	21,2	G 1/4				25,00	13,50
9	15,00	12,80	29,60	5,30	38,80			22,30	25,2	25,2	G 3/8				29,80	13,50
12	15,00	22,90	31,80	5,30	50,60			27,80	30,2	32,2	G 1/2				29,40	12,30
19	15,00	32,00	35,40	4,40	57,60			32,80	41,2	44,2	G 3/4				33,85	12,30



Modular integrated coupling and plug for installation in multi-coupling systems. High resilience, low coupling forces and great resistance to liquid media due to the special coating of the coupling body

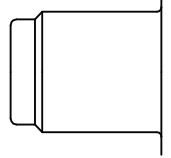

KF Straight-Through

Working Pressure*:
up to 15 bar

Material:

- Coupling: Nickel plated brass, PTFE coated steel
- Plug: Nickel plated brass, PTFE coated steel
- Seals: FKM

Working Temperature:
-15°C up to +100°C (FKM)

Flow Rate Water:
46 l/min.
pressure drop 0.5 bar

KL Dry-break

Working Pressure*:
up to 15 bar

Material:

- Coupling: Nickel plated brass, PTFE coated steel
- Plug: Nickel plated brass, PTFE coated steel
- Seals: FKM

Working Temperature:
-15°C up to +100°C (FKM)

Flow Rate Water:
20 l/min.
pressure drop 0.5 bar

* maximum static working pressure with design factor 4 to 1.



Straight-Through



Dry-Break

93KFIW Coupler without valve, Female Thread

Nickel-plated brass, Steel PTFE coated, FKM

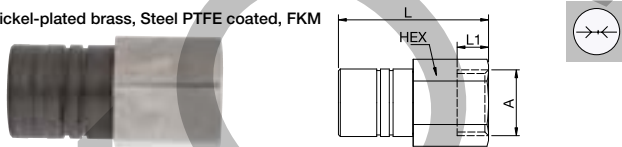

DN	A	HEX	L	L1
8.1	G1/2	24	48	12

93KLIW Coupler with valve, Female Thread

Nickel-plated brass, Steel PTFE coated, FKM

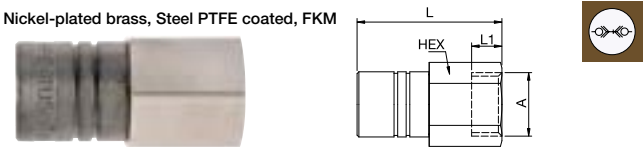

DN	A	HEX	L	L1
8.1	G1/2	24	48	12

93SFIW Plug without valve, Female Thread

Nickel-plated brass, Steel PTFE coated

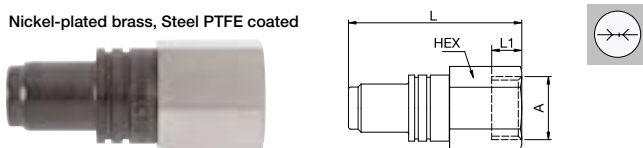

DN	A	HEX	L	L1
8.1	G1/2	24	57.5	12

93SLIW Plug with valve, Female Thread

Nickel-plated brass, Steel PTFE coated, FKM

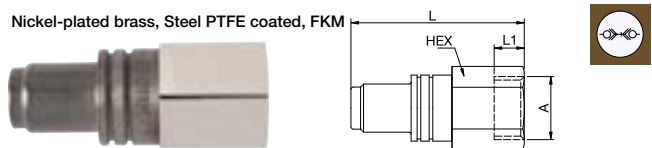

DN	A	HEX	L	L1
8.1	G1/2	24	57.5	12

94KX Locking Coupling

Nickel-plated steel

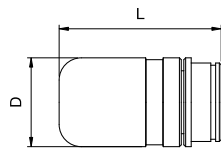

L D

94KX

45 25

94SX Locking Bolt

Nickel-plated steel

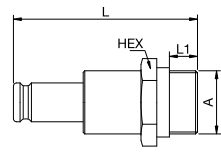

HEX L L1

94SX

24 58 13

KROVANZ.COM