

**Limit Switches and Bleed Sensors**

<b>Limit switches Control and process only</b>	<b>Bleed Sensors</b>
--	--------------------------

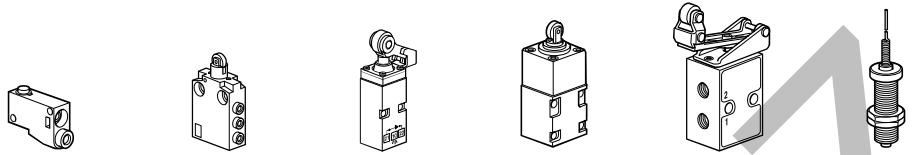

Series	Miniature	Compact	K-series	J-series	M43	PXF
Connection, * Push-in	Ø4*	Ø4*	Ø4* or M5	Ø4*	M5	Ø4* or M5
Flow at 6 bar, Qn l/s Qmax l/s Cv	1	4,2	2	3,5	1 1,89 0,127	3
Pipeable exhaust		No	Yes	No	Yes	No
Working temperature	-15 to +60°C	-15 to +60°C	-15 to +60°C	-15 to +60°C	-10 to +80°C	-15 to +60°C
Pneumatic switching	3/2 NC	3/2 NC	3/2 NC 3/2 NO	3/2 NC 3/2 NO	3/2 NC	
Construction material	Zinc die cast	Zinc die cast	Zinc die cast	Turrethead Zinc die cast, brass	Zinc die cast	Brass
Interchangeable with electrical version		Yes	Yes	Yes		
Actuator type						
Air hydraulic oil, fresh water, brine						
Plunger	●	●	●	●	●	
Roller		●		●	●	
Roller plunger		●	●	●		
Roller lever	●		●		●	
Whisker			●	●		
Variable offset lever			●	●		
Ball operated						
Cam				●		
Refer to page	5	5	6	8	15	16

- High durability
- Very good repeat accuracy
- Design for process duty cycle
- Push-in or threaded connection
- Versatile and easily maintained
- Wide range of body size and actuator style



**Operating information**

Working pressure;  
 PXC-M101, PXC-M111, PXC-M121,  
 PXC-M521, PXC-M601,  
 PXC-J: 3-8 bar  
 PXC-K: 3-9 bar



Working temperature -15 °C to +60 °C

	<b>PXC-M101</b>	<b>PXC-M111</b>	<b>PXC-M121</b>	<b>PXC-M521/ PXC-M601</b>
Flow: (acc. to ISO 6358)	Qmax= 60	60	85	250 l/s
Flow: (acc. to ISO 6358)	Qmax=	<b>PXC-K</b> 210	<b>PXC-J</b> 210 l/s	

### 3/2 miniatures limit switches

With Ø4 mm Push-in connections (M5 on request)

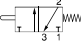
#### Bore Ø1,5 mm, flow 60 NI/min

Symbol	Actuator	Return	Operating forces at 6 bar, N	Weight kg	Order code
	Steel plunger	Spring	11	0,030	<b>PXC-M111</b>
	Steel plunger	Spring	11	0,030	<b>PXC-M101</b>
<b>Operating levers</b>	Plastic roller lever			0,008	<b>PXC-Z11</b>
	Plastic roller lever, one way trip			0,008	<b>PXC-Z12</b>

#### Bore Ø1,5 mm, flow 85 NI/min

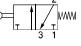
Symbol	Actuator	Return	Operating forces at 6 bar, N	Weight kg	Order code
	Plastic roller	Spring	4,5	0,040	<b>PXC-M121</b>
	Steel roller	Spring	4,5	0,045	<b>PXC-M131</b>

#### Bore Ø2,5 mm, flow 250 NI/min

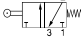
Symbol	Actuator	Return	Operating forces at 6 bar, N	Weight kg	Order code
	Plastic roller	Spring	7	0,060	<b>PXC-M521</b>

### 3/2 compact limit switches

With Ø4 mm Push-in connections with pipeable exhaust port

#### Bore Ø2,5 mm, flow 250 NI/min

With plunger head

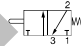
Symbol	Actuator	Return	Operating forces at 6 bar, N	Weight kg	Order code
	Steel plunger	Spring	24	0,150	<b>PXC-M601A110</b>

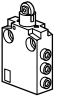
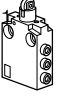
Symbol	Actuator	Return	Operating forces at 6 bar, N	Weight kg	Order code
	Steel roller plunger	Spring	24	0,160	<b>PXC-M601A102</b>
	90° steel roller plunger	Spring	24	0,160	<b>PXC-M601A103</b>

### 3/2 limit switches “K series”

With Ø4 mm Push-in connections  
with pipeable exhaust port  
snap action and low operating force

#### Bore Ø3 mm

With plunger

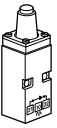
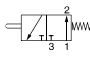
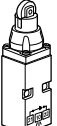
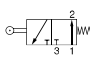
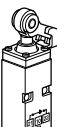
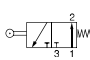
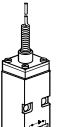
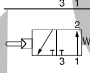
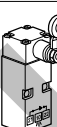
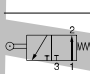
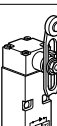
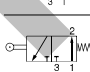
Symbol	Actuator	Return	Operating forces at 6 bar, N	Weight kg	Order code
	Steel plunger	Spring	16 N	0,270	<b>PXC-K21101</b>
	Steel plunger	Spring	16 N	0,270	<b>PXC-K22101</b>
	Steel roller plunger	Spring	16 N	0,310	<b>PXC-K21102</b>
	Steel roller plunger	Spring	16 N	0,310	<b>PXC-K22102</b>
	Plastic roller plunger	Spring	16 N	0,320	<b>PXC-K21121</b>
	Plastic roller plunger	Spring	16 N	0,320	<b>PXC-K22121</b>
	Whisker	Spring	0,05 Nm	0,270	<b>PXC-K21106</b>
	Whisker	Spring	0,05 Nm	0,270	<b>PXC-K22106</b>
	Plastic roller lever *	Spring	0,21 Nm	0,360	<b>PXC-K2110531</b>
	Plastic roller lever *	Spring	0,21 Nm	0,360	<b>PXC-K2210531</b>
	Adjustable lever with Delrin roller *	Spring	0,21 Nm	0,360	<b>PXC-K2110541</b>
	Adjustable lever with Delrin roller	Spring	0,21 Nm	0,360	<b>PXC-K2210541</b>

\* Direction of actuation can be set as required

- from right and left
- from right
- from left

Dimensions, Limit switches, Series PXC

3/2 miniature limit switches

PXC-M111

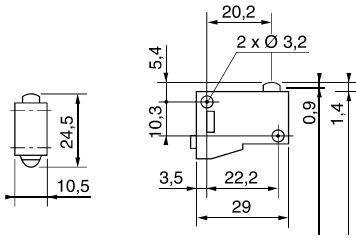

PXC-Z12

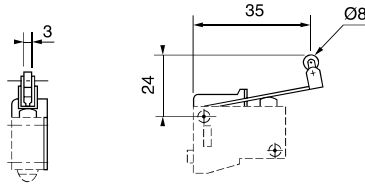

PXC-Z11

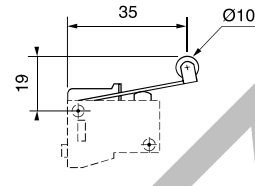

PXC-M121 - PXC-M131

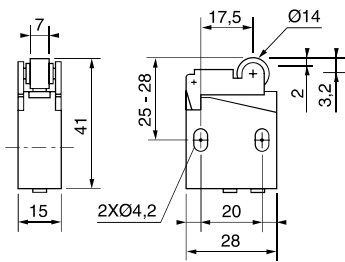

PXC-M521

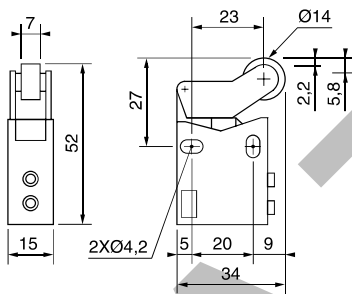

3/2 compact limit switches

PXC-M601A102

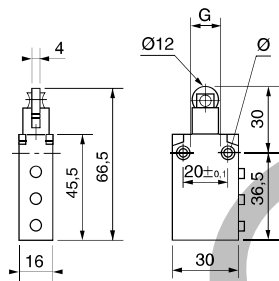

PXC-M601A103

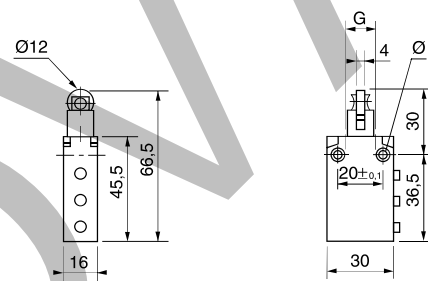

PXC-M601A110

