

3000 71 00 Tube Cutter

Technical polymer

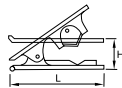

H L Kg

3000 71 00	25	79	0.029
------------	----	----	-------

This tool is designed to give a clean cut at right angles to the tube axis for all resilient polymer tubing (polyamide, polyurethane, FEP, polyethylene, etc.) from 4 mm to 16 mm diameter inclusive.

Replacement blades: part number 3000 71 00 05

A spring maintains the cutter in the closed position.

3000 71 11 Tube Cutter

Treated steel



Kg

3000 71 11	0.280
------------	-------

Replacement blades: part number 3000 71 11 05

6000 71 00 Stripping Tool for Anti-Spark Tubing

Polymère technique, acier inox



Kg

6000 71 00	0.098
------------	-------

1827 Stainless Steel Tube Support for Fluoropolymer Tubing

Stainless steel 316L

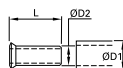

ØD1 ØD2 Kg

6	4	1827 06 00	11.5	0.001
8	6	1827 08 00	14	0.001
10	8	1827 10 00	18	0.001
12	9	1827 12 09	18	0.001
12	10	1827 12 00	18	0.001
16	13	1827 16 13	18	0.002
16	14	1827 16 00	18	0.002

This tube support is necessary when using fluoropolymer tubing at all temperatures compatible with the fitting/tubing assembly.

0127 Brass Tube Support for Polymer Tubing

Brass

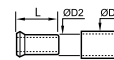

ØD1	ØD2	L	Kg
4	2	0127 04 00	11 0.001
4	2.7	0127 04 27	11 0.001
5	3	0127 05 03	11 0.001
5	3.3	0127 05 00	11.5 0.001
6	4	0127 06 00	11.5 0.001
8	5.5	0127 08 55	14 0.001
8	6	0127 08 00	14 0.001
10	7	0127 10 07	18 0.001
10	7.5	0127 10 75	18 0.001
10	8	0127 10 00	18 0.002
12	8	0127 12 08	26 0.002
12	9	0127 12 09	18 0.002
12	10	0127 12 00	18 0.001
14	11	0127 14 11	16 0.002
14	12	0127 14 00	18 0.002
15	12	0127 15 12	18 0.002
16	13	0127 16 13	18 0.003
18	14	0127 18 14	19.5 0.003
22	16	0127 22 16	21 0.005

This tube support guarantees good gripping, at high temperatures and pressures, by preventing collapsing of the tube.

CLIP Clip Strip for Tubing and Fittings

Technical polymer

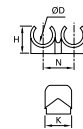

ØD	H	K	N	K	Kg	
4	CLIP 04 00	9	13.5	10.5	13.5	0.007
6	CLIP 06 00	10.5	13	10.5	13	0.008
8	CLIP 08 00	12.5	10.5	12	10.5	0.007
10	CLIP 10 00	14	12	15	12	0.005
12	CLIP 12 00	16.5	14	16.5	14	0.009
14	CLIP 14 00	18	16	20.5	16	0.009

Delivered in boxes of 10 strips of the same diameter (complete with self-tapping screws of 95 mm length) These clips can be used with metric or inch tubing.

0697 Clip for Braided Tubing

Treated steel

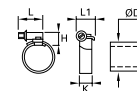

ØD	H	K	L	L1	K	Kg	
6-11	0697 00 01	7	5	12	7	5	0.004
10-16	0697 00 02	12	9	21	13	9	0.011
12-22	0697 00 03	12	9	21	13	9	0.014
16-27	0697 00 04	12	9	24	13	9	0.015
20-32	0697 00 05	12	9	24	13	9	0.016

UR Threaded Nut

Brass



C	UR	HEX	L
G1/8 right	UR10	12	11
G1/4 right	UR13	17	15.5
G3/8 right	UR17	19	16.5
G1/4 r. f. 9 mm	UR13/9*	17	15.5
G1/2 right	UR21	24	20.5

DIN EN 560 (left handed thread marked)
* only for STP13/09

STP Hose Tail, short

Brass



ØD	C	STP	L
4	G1/8	STP10/04	27.5
6	G1/8	STP10/06	28
4	G1/4	STP13/04	30.5
6	G1/4	STP13/06	35.5
9	G1/4	STP13/09*	35.5
6	G3/8	STP17/06	36
9	G3/8	STP17/09	36
9	G1/2	STP21/09	38
13	G1/2	STP21/13	44

Can be assembled with DN fittings on page 355

STD Hose Tail, long

Brass

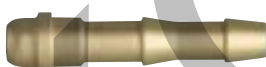

ØD	C	STD	L
4	G1/4	STD13/04	47
6	G1/4	STD13/06	47
4	G3/8	STD17/04	47.5
6	G3/8	STD17/06	47.5
9	G3/8	STD17/09	47.5

DIN EN 560

GT Hose Tail Barb

Brass



ØD	C	GT	HEX	L
3	M5	GT05/03	7	15.5
	M5	GT05/04	7	15.5
4	M6	GT06/04	8	23
6	G1/2*	GT21/06	24	39
4	G1/8*	GT10/04	14	28
6	G1/8*	GT10/06	14	33
8	G1/8*	GT10/08	14	33
9	G1/8*	GT10/09	14	33
4	G1/4*	GT13/04	17	29.5
6	G1/4*	GT13/06	17	34.5
8	G1/4*	GT13/08	17	34.5
9	G1/4*	GT13/09	17	34.5
10	G1/4*	GT13/10	17	34.5
3	G1/4*	GT13/13	17	41.5
6	G3/8*	GT17/06	19	36
8	G3/8*	GT17/08	19	36
9	G3/8*	GT17/09	19	36
10	G3/8*	GT17/10	19	36
13	G3/8*	GT17/13	19	42
9	G1/2*	GT21/09	24	39
10	G1/2	GT21/10	24	40
13	G1/2*	GT21/13	24	45
16	G1/2	GT21/16	24	53
19	G1/2	GT21/19	24	54
13	G3/4*	GT26/13	32	48.5
16	G3/4*	GT26/16	32	56.5
19	G3/4*	GT26/19	32	56.5
25	G1*	GT33/25	36	67.5

with Male Thread
(* inner cone 45°)

GT Hose Tail Barb

Stainless steel



ØD	C	GT	HEX	L	Version
6	G1/8*	GT10/06R	14	33	AISI 303
	G1/8*	GT10/06E	14	33	AISI 316L
9	G1/4*	GT13/09R	17	34.5	AISI 303
	G3/8*	GT17/09R	19	36	AISI 303
13	G1/2*	GT21/13R	24	45	AISI 303

with Male Thread (* inner cone 45°)

GI Hose Tail Barb

Brass

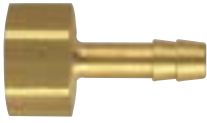

ØD	C		HEX	L
6	G1/8	GI10/06	12	31
8	G1/8	GI10/08	12	31
6	G1/4	GI13/06	17	33
8	G1/4	GI13/08	17	33
9	G1/4	GI13/09	17	33
13	G1/4	GI13/13	17	39
6	G3/8	GI17/06	19	33
8	G3/8	GI17/08	19	33
9	G3/8	GI17/09	19	33
13	G3/8	GI17/13	19	40
6	G1/2	GI21/06	24	36
8	G1/2	GI21/08	24	36
9	G1/2	GI21/09	24	36
13	G1/2	GI21/13	24	43

with Female Thread

DS Hose Repairer

Brass



ØD		L
4	DS04/04P**	50
6	DS06/06*	72
8	DS08/08*	72
9	DS09/09*	72
13	DS13/13	74

* DIN EN 560

** for Hard Hoses

DK Hose Repairer, short

Brass



ØD		L
4	DK04/04	19
6	DK06/06	19

SM Tube Nut for Plastic Hoses

Brass



ØD	C		HEX	L
3 x 4	M7x0.5	SM04	-	8.5
3 x 5	M7x0.6	SM05	-	8.5
4 x 6	M10x1	SM06	12	11
6 x 8	M12x1	SM08	14	11
8 x 10	M16x1	SM10	17	12.5
9 x 12	M16x1	SM12	17	12.5

Can be assembled with MV fittings on page 160

DV Swivelling Spring Guard

Brass

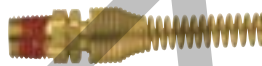

ØD	C		HEX
3.1 x 4.7	R1/8	DV10/05	11
4.8 x 6.3	R1/4	DV13/06	14
6.3 x 7.9	R1/4	DV13/08	14
7.9 x 9.5	R1/4	DV13/10	15
9.5 x 11.8	R3/8	DV17/12	19
12.7 x 15.8	R1/2	DV21/16	22

SV Fixed Spring Guard

Brass



ØD	C		HEX	L
4 x 6	G1/8	SV10/06	12	103
6 x 8	G1/8	SV10/08	12	106
4 x 6	G1/4	SV13/06	17	103
6 x 8	G1/4	SV13/08	17	106
8 x 10	G1/4	SV13/10	17	119
9 x 12	G1/4	SV13/12	17	123
	G3/8	SV17/12*	19	123

* Inner Cone 45°

KN Spring Guard completely with Tube Nut

Brass



ØD	C		HEX	L
4 x 6	M10x1	KN06	12	94
6 x 8	M12x1	KN08	14	97
8 x 10	M16x1	KN10	17	110
9 x 12	M16x1	KN12	17	114

0694 Push-In Fitting with Protection Spring, Male BSPP Thread

Nickel-plated Brass, NBR

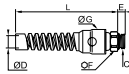

ØD	C		E	F	G	L	Kg
8	G1/4	0694 08 13	6.5	16	24	104.5	0.067
10	G1/4	0694 10 13	6.5	18	24	106.5	0.062
12	G3/8	0694 12 17	7.5	20	29.5	126	0.080

0695 Push-In Fitting with Protection Spring, Male BSPT Thread

Nickel-plated Brass, NBR

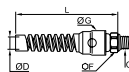

ØD	C		F	G	L	Kg
8	R1/4	0695 08 13	14	24	104.5	0.055
10	R1/4	0695 10 13	18	24	106.5	0.063
12	R3/8	0695 12 17	20	29.5	126	0.090

KB ,O'-Clips



	Spread mm	Height
KB0709	7 - 9	7
KB0911	9 - 11	7
KB1113	11 - 13	7
KB1315	13 - 15	7.5
KB1518	15 - 18	8
KB1720	17 - 20	8.5
KB2023	20 - 23	9