



The 86, 87 and 88 Rectus Moldtite coupling series were especially developed for connecting coolant lines and injection moulds. Countersunk plugs can easily be connected and disconnected because of the extended sleeve. The angular connections prevent kinks from forming in the hose.

- Available in:
  - single shut-off, double shut-off or straight-through versions
- The shut-off couplings (with valve) are equipped with nickel plated sleeves for quick and accurate visual differentiation

Series 86



Series 87

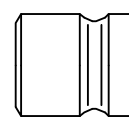

Series 88

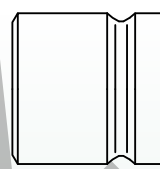

**KF** Straight-Through

**Working Pressure\*:**  
up to 15 bar

**Material:**

- Coupling: Brass
- Plug: Brass
- Seals: FKM

**Working Temperature:**  
-15°C up to +200°C (FKM)

**Flow Rate Water:**

- Series 86: 17 l/min.
- Series 87: 29 l/min.
- Series 88: 94 l/min.

pressure drop 0.5 bar

**KA** Single Shut-Off

**Working Pressure\*:**  
up to 15 bar

**Material:**

- Coupling: Brass
- Plug: Brass
- Seals: FKM

**Working Temperature:**  
-15°C up to +200°C (FKM)

**Flow Rate Water:**

- Series 86: 9 l/min.
- Series 87: 16 l/min.
- Series 88: 55 l/min.

pressure drop 0.5 bar

**KB** Double Shut-Off

**Working Pressure\*:**  
up to 15 bar

**Material:**

- Coupling: Brass
- Plug: Brass
- Seals: FKM

**Working Temperature:**  
-15°C up to +200°C (FKM)

**Flow Rate Water:**

- Series 86: 8 l/min.
- Series 87: 15 l/min.

pressure drop 0.5 bar

\* maximum static working pressure with design factor 4 to 1.

→|← Straight-Through

→|← Straight-Through

**86/87/88KFAW** Coupler without valve, Male Thread

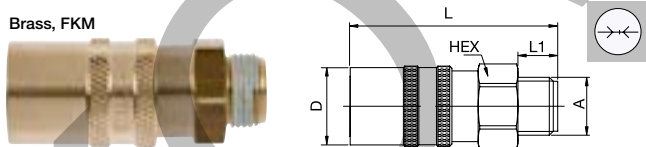

DN	Series	A	HEX	L	L1	D
6	86	G1/4	86KFAW13MVX	17	47	9 18
		G3/8	86KFAW17MVX	19	47	9 18
9	87	G1/4	87KFAW13MVX	22	56.5	9 24
		G3/8	87KFAW17MVX	22	56.5	9 24
		G1/2	87KFAW21MVX	22	59.5	12 24
13	88	G1/2	88KFAW21MVX	30	73	12 32

**86/87/88KFIW** Coupler without valve, Female Thread

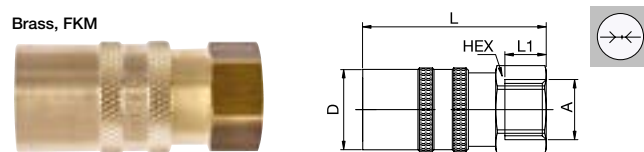

DN	Series	A	HEX	L	L1	D
6	86	G1/8	86KFIW10MVX	17	40	12 18
		G1/4	86KFIW13MVX	17	40	12 18
9	87	G1/4	87KFIW13MVX	21	51.5	10 24
		G3/8	87KFIW17MVX	21	51.5	10 24
13	88	G1/2	88KFIW21MVX	30	68	12 32



Straight-Through

## 86/87/88KFTF Coupler without valve, Hose Barb

Brass, FKM

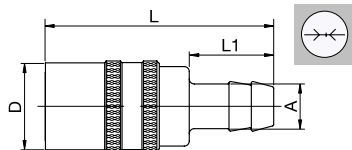

DN	Series	A		L	L1	D
6	86	6	86KFTF06MVX	46	17	18
		9	86KFTF09MVX	46	22	18
9	87	9	87KFTF09MVX	64	22	24
		13	87KFTF13MVX	66.5	25	24
13	88	19	88KFTF19MVX	89	32	32

## 86/87/88KFTR Coupler without valve, Hose Barb 90°

Brass, FKM

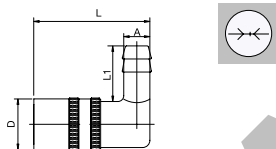

DN	Series	A		L	L1	D
6	86	6	86KFTR06MVX	40	17	18
		9	86KFTR09MVX	40	22	18
9	87	9	87KFTR09MVX	56	22	24
		13	87KFTR13MVX	56	28.5	24
13	88	19	88KFTR19MVX	77	32	32

## 86/87KFTH Coupler without valve, Hose Barb 45°

Brass, FKM

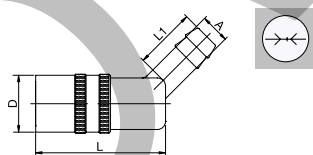

DN	Series	A		L	L1	D
6	86	6	86KFTH06MVX	40	17	18
		9	86KFTH09MVX	40	22	18
9	87	9	87KFTH09MVX	56	22	24
		13	87KFTH13MVX	56	25	24



Straight-Through

## 86/87KFTP Coupler without valve, Push-Lok

Brass, FKM

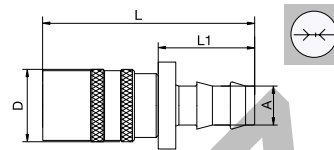

DN	Series	A		L	L1	D
6	86	6	86KFTP06MVX	49	20.4	18
		10	86KFTP10MVX	53	24.2	18
9	87	10	87KFTP10MVX	65.5	24.2	24
		13	87KFTP13MVX	69.5	27.9	24

## 86/87KFPR Coupler without valve, Push-Lok 90°

Brass, FKM

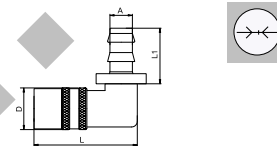

DN	Series	A		L	L1	D
6	86	6	86KFPR06MVX	45	20.4	18
		10	86KFPR10MVX	45	24.2	18
9	87	10	87KFPR10MVX	61.5	24.2	24
		13	87KFPR13MVX	61.5	27.9	24

## 86/87KFPH Coupler without valve, Push-Lok 45°

Brass, FKM

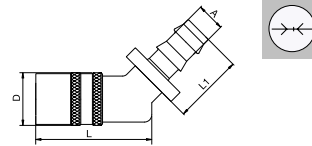

DN	Series	A		L	L1	D
6	86	6	86KFPH06MVX	40	20.4	18
		10	86KFPH10MVX	40	24.2	18
9	87	10	87KFPH10MVX	56	24.2	24
		13	87KFPH13MVX	56	27.9	24



Single Shut-off / Double shut-off

## 86/87/88KBAW Coupler with valve, Male Thread

Brass, FKM

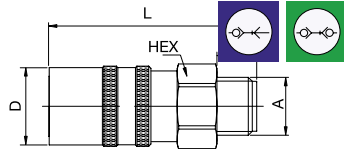

DN	Series	A		HEX	L	L1	D
6	86	G1/4	<b>86KBAW13MVX</b>	17	47	9	18
		G3/8	<b>86KBAW17MVX</b>	19	47	9	18
9	87	G1/4	<b>87KBAW13MVX</b>	22	56.5	9	24
		G3/8	<b>87KBAW17MVX</b>	22	56.5	9	24
		G1/2	<b>87KBAW21MVX</b>	22	59.5	12	24
13	88	G1/2	<b>88KAAW21MVX</b>	30	73	12	32



Single Shut-off / Double shut-off

## 86/87/88KBTR Coupler with valve, Hose Barb 90°

Brass, FKM

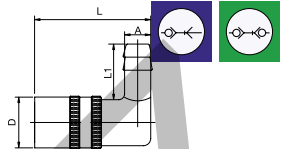

DN	Series	A		L	L1	D
6	86	6	<b>86KBTR06MVX</b>	40	17	18
		9	<b>86KBTR09MVX</b>	40	22	18
9	87	9	<b>87KBTR09MVX</b>	56	22	24
		13	<b>87KBTR13MVX</b>	56	28.5	24
13	88	19	<b>88KATR19MVX</b>	77	32	32

## 86/87/88KBIW Coupler with valve, Female Thread

Brass, FKM

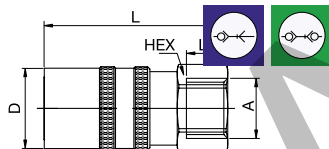

DN	Series	A		HEX	L	L1	D
6	86	G1/8	<b>86KBIW10MVX</b>	17	40	12	18
		G1/4	<b>86KBIW13MVX</b>	17	40	12	18
9	87	G1/4	<b>87KBIW13MVX</b>	21	51.5	10	24
		G3/8	<b>87KBIW17MVX</b>	21	51.5	10	24
13	88	G1/2	<b>88KAIW21MVX</b>	30	68	12	32

## 86/87KBTH Coupler with valve, Hose Barb 45°

Brass, FKM

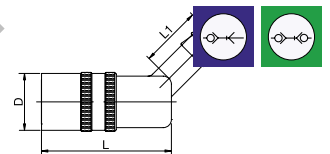

DN	Series	A		L	L1	D
6	86	6	<b>86KBTH06MVX</b>	40	17	18
		9	<b>86KBTH09MVX</b>	40	22	18
9	87	9	<b>87KBTH09MVX</b>	56	22	24
		13	<b>87KBTH13MVX</b>	56	25	24

## 86/87/88KBTf Coupler with valve, Hose Barb

Brass, FKM

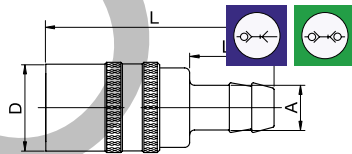

DN	Series	A		L	L1	D
6	86	6	<b>86KBTf06MVX</b>	46	17	18
		9	<b>86KBTf09MVX</b>	46	22	18
9	87	9	<b>87KBTf09MVX</b>	64	22	24
		13	<b>87KBTf13MVX</b>	66.5	25	24
13	88	19	<b>88KATf19MVX</b>	89	32	32

## 86/87KBTP Coupler with valve, Push-Lok

Brass, FKM

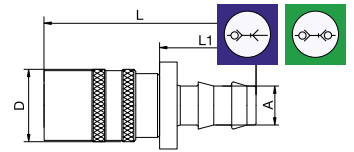

DN	Series	A		L	L1	D
6	86	6	<b>86KBTP06MVX</b>	49	20.4	18
		10	<b>86KBTP10MVX</b>	53	24.2	18
9	87	10	<b>87KBTP10MVX</b>	65.5	24.2	24
		13	<b>87KBTP13MVX</b>	69.5	27.9	24



Single Shut-off / Double shutt-off

## 86/87KBPR Coupler with valve, Push-Lok 90°

Brass, FKM

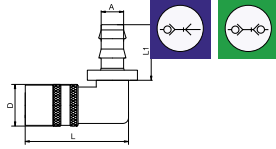

DN	Series	A		L	L1	D
6	86	6	<a href="#">86KBPR06MVX</a>	45	20.4	18
		10	<a href="#">86KBPR10MVX</a>	45	24.2	18
9	87	10	<a href="#">87KBPR10MVX</a>	61.5	24.2	24
		13	<a href="#">87KBPR13MVX</a>	61.5	27.9	24

## 86/87KBPH Coupler with valve, Push-Lok 45°

Brass, FKM

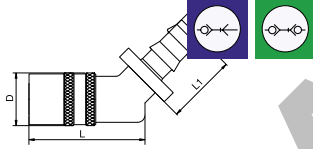

DN	Series	A		L	L1	D
6	86	6	<a href="#">86KBPH06MVX</a>	40	20.4	18
		10	<a href="#">86KBPH10MVX</a>	40	24.2	18
9	87	10	<a href="#">87KBPH10MVX</a>	56	24.2	24
		13	<a href="#">87KBPH13MVX</a>	56	27.9	24



Straight-Through / Single Shut-off

## 86/87/88SFA Plug without valve, Male Thread

Brass

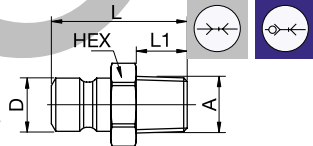
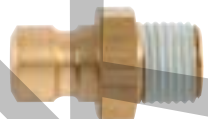

DN	Series	A		HEX	L	L1	D
6	86	M10 x 1	<a href="#">86SFAM10MXX</a>	13	23	8	9.5
		R1/8	<a href="#">86SFAK10MXX</a>	13	24	9	9.5
		R1/4	<a href="#">86SFAK13MXX</a>	16	29	12	9.5
		R3/8	<a href="#">86SFAK17MXX</a>	19	30	12	9.5
9	87	R1/4	<a href="#">87SFAK13MXX</a>	16	34	12	13.5
		R3/8	<a href="#">87SFAK17MXX</a>	19	34	12	13.5
13	88	R1/2	<a href="#">87SFAK21MXX</a>	24	39	17	13.5
		R1/2	<a href="#">88SFAK21MXX</a>	22	44	17	20
		R3/4	<a href="#">88SFAK26MXX</a>	29	45	19	20



Straight-Through / Single Shut-off

## 86/87SFAR Plug without valve, Male Thread 90° tapered

Brass

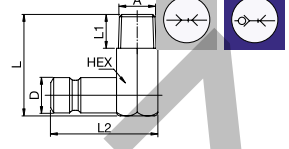

DN	Series	A		HEX	L	L1	L2	D
6	86	R1/8	<a href="#">86SFAR10MXX</a>	11	27	9	28.5	9.5
		R1/4	<a href="#">86SFAR13MXX</a>	14	27	9	32	9.5
9	87	R1/4	<a href="#">87SFAR13MXX</a>	15	34	9	32	13.5
		R3/8	<a href="#">87SFAR17MXX</a>	19	37	12	36	13.5

## 86/87SFIW Plug without valve, Female Thread

Brass

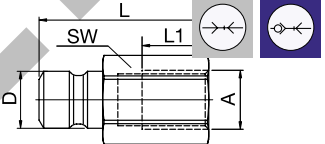

DN	Series	A		HEX	L	L1	D
6	86	G1/8	<a href="#">86SFIW10MXX</a>	13	28	11	9.5
		G1/4	<a href="#">86SFIW13MXX</a>	16	32	13	9.5
9	87	G1/4	<a href="#">87SFIW13MXX</a>	16	37	13	13.5
		G3/8	<a href="#">87SFIW17MXX</a>	19	39	16	13.5

## 86/87SFTF Plug without valve, Hose Barb

Brass

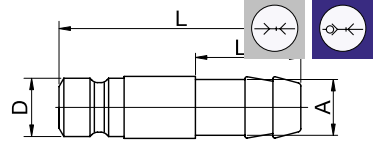

DN	Series	A		L	L1	D
6	86	9	<a href="#">86SFTF09MXX</a>	39	22	9.5
9	87	13	<a href="#">87SFTF13MXX</a>	41	21	13.5

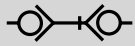

Double Shut-off

## 86/87SBAK Plug with valve, Male Thread

Brass, FKM

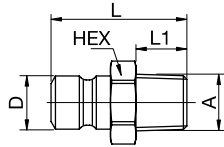
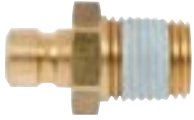

DN	Series	A		HEX	L	L1	D
6	86	R1/4	<a href="#">86SBAK13MVX</a>	6	29	14	9.5
9	87	R1/4	<a href="#">87SBAK13MVX</a>	16	34	12	13.5
		R3/8	<a href="#">87SBAK17MVX</a>	19	34	12	13.5



Straight-Through

## 86/87VN Extension Plug, Male Thread

Brass



DN	Series	A		HEX	L	L1	D
6	86	R1/8	<a href="#">86VN1010MXX</a>	11	100	9	9.5
		R1/8	<a href="#">86VN1015MXXS_01</a>	11	150	9	9.5
		R1/8	<a href="#">86VN1025MXX</a>	11	250	9	9.5
9	87	R1/4	<a href="#">87VN1315MXX</a>	15	150	12	13.5
		R1/4	<a href="#">87VN1325MXX</a>	15	250	12	13.5
6	86	G1/8	<a href="#">86VN1010MXXS_01</a>	11	100	60	9.5
		G1/4	<a href="#">86VN1310MXX</a>	14	100	60	9.5
9	87	G1/4	<a href="#">87VN1310MXX</a>	14	100	60	13.5
		G3/8	<a href="#">87VN1710MXX</a>	17	100	60	13.5



The 86 and 87 Rectus Moldtite coupling series with Safe-Lock technology were especially developed for connecting coolant lines and injection moulds. Countersunk plugs can easily be connected and disconnected because of the extended sleeve. The angular connections prevent kinks from forming in the hose.

- Available in single shut-off, double shut-off or straight-through versions
- The shut-off couplings (with valve) are equipped with nickel plated sleeves for quick and accurate visual differentiation

Series 86



Series 87

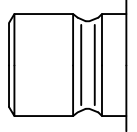

**KF** Straight-Through

**Working Pressure\*:**  
up to 15 bar

**Material:**

- Coupling: Brass
- Plug: Brass
- Seals: FKM

**Working Temperature:**  
-15°C up to +200°C (FKM)

**Flow Rate Water:**

- Series 86: 17 l/min.
- Series 87: 29 l/min.

pressure drop 0.5 bar

**KA** Single Shut-Off

**Working Pressure\*:**  
up to 15 bar

**Material:**

- Coupling: Brass
- Plug: Brass
- Seals: FKM

**Working Temperature:**  
-15°C up to +200°C (FKM)

**Flow Rate Water:**

- Series 86: 9 l/min.
- Series 87: 16 l/min.

pressure drop 0.5 bar

**KB** Double Shut-Off

**Working Pressure\*:**  
up to 15 bar

**Material:**

- Coupling: Brass
- Plug: Brass
- Seals: FKM

**Working Temperature:**  
-15°C up to +200°C (FKM)

**Flow Rate Water:**

- Series 86: 8 l/min.
- Series 87: 15 l/min.

pressure drop 0.5 bar

\* maximum static working pressure with design factor 4 to 1.



Straight-Through



Straight-Through

## 86/87KFAW Coupler without valve, Male Thread, Safe-Lock

Brass, FKM

DN	Series	A	HEX	L	L1	D
6	86	G1/4	86KFAW13MVXSL	17	51.5	9 18
		G3/8	86KFAW17MVXSL	19	51.5	9 18
9	87	G1/4	87KFAW13MVXSL	22	67	9 24
		G3/8	87KFAW17MVXSL	22	67	9 24
		G1/2	87KFAW21MVXSL	22	70	12 24

## 86/87KFTR Coupler without valve, Hose Barb 90°, Safe-Lock

Brass, FKM

DN	Series	A	L	L1	D
6	86	9	86KFTR09MVXSL	52.5	22 18
		9	87KFTR09MVXSL	68.5	22 24
9	87	13	87KFTR13MVXSL	68.5	28.5 24

## 86/87KFTF Coupler without valve, Hose Barb, Safe-Lock

Brass, FKM

DN	Series	A	L	L1	D
6	86	9	86KFTF09MVXSL	59	22 18
		9	87KFTF09MVXSL	73	22 24
9	87	13	87KFTF13MVXSL	76	25 24

## 86/87KFTH Coupler without valve, Hose Barb 45°, Safe-Lock

Brass, FKM

DN	Series	A	L	L1	D
6	86	9	86KFTH09MVXSL	51.5	22 18
		9	87KFTH09MVXSL	65.5	22 24
9	87	13	87KFTH13MVXSL	65.5	25 24

# Series 86/87 - Safe Lock Technology



Single Shut-off / Double Shut-off

## 86/87KBAW Coupler with valve, Male Thread, Safe-Lock

Brass, FKM

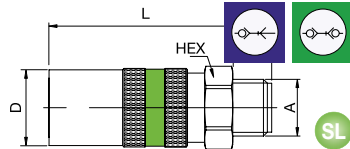

DN	Series	A		HEX	L	L1	D
6	86	G1/4	<b>86KBAW13MVXSL</b>	17	51.5	9	18
		G3/8	<b>86KBAW17MVXSL</b>	19	51.5	9	18
9	87	G1/4	<b>87KBAW13MVXSL</b>	22	67	9	24
		G3/8	<b>87KBAW17MVXSL</b>	22	67	9	24
		G1/2	<b>87KBAW21MVXSL</b>	22	70	12	24

## 86/87KBTF Coupler with valve, Hose Barb, Safe-Lock

Brass, FKM

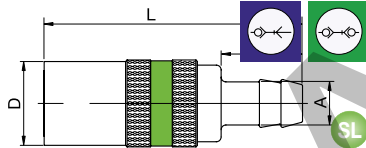

DN	Series	A		L	L1	D
6	86	9	<b>86KBTF09MVXSL</b>	59	22	18
9	87	9	<b>87KBTF09MVXSL</b>	73	22	24
		13	<b>87KBTF13MVXSL</b>	76	25	24

## 86/87KBTR Coupler with valve, Hose Barb 90°, Safe-Lock

Brass, FKM

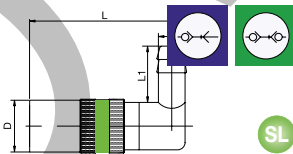

DN	Series	A		L	L1	D
6	86	9	<b>86KBTR09MVXSL</b>	52.5	22	18
9	87	9	<b>87KBTR09MVXSL</b>	68.5	22	24
		13	<b>87KBTR13MVXSL</b>	68.5	28.5	24

## 86/87KBTH Coupler with valve, Hose Barb 45°, Safe-Lock

Brass, FKM

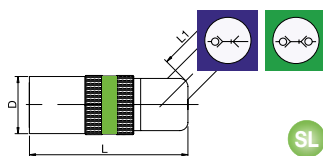

DN	Series	A		L	L1	D
6	86	9	<b>86KBTH09MVXSL</b>	51.5	22	18
9	87	9	<b>87KBTH09MVXSL</b>	65.5	22	24
		13	<b>87KBTH13MVXSL</b>	65.5	25	24



The 10, 11 and 12 Rectus Moldtite coupling series were especially developed for connecting coolant lines and injection moulds. These stand out for their convenient, single-handed operation and a reliable O-ring seal. Widely used in Europe.

- Available in:
  - single shut-off, double shut-off or straight-through versions
- The straight-through couplings are equipped with nickel plated sleeves for quick and accurate visual differentiation
- The angular connections prevent kinks from forming in the hose
- Available on request:
  - series 10/11 are also available with special FFKM high-temperature seal for applications up to constant temperature 200°C

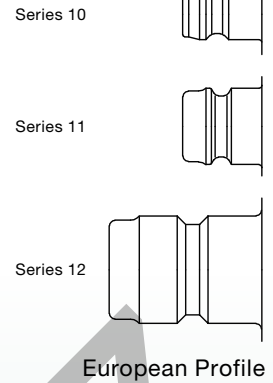

## KF Straight-Through

**Working Pressure\*:**  
up to 15 bar

**Material:**

- Coupling: Brass
- Plug: Brass, stainless steel
- Seals: FKM

**Working Temperature:**  
-15°C up to +200°C (FKM)

**Flow Rate Water:**

- Series 10: 16 l/min.
- Series 11: 50 l/min.
- Series 12: 106 l/min.

pressure drop 0.5 bar

## KA Single Shut-Off

**Working Pressure\*:**  
up to 15 bar

**Material:**

- Coupling: Brass
- Plug: Brass, stainless steel
- Seals: FKM

**Working Temperature:**  
-15°C up to +200°C (FKM)

**Flow Rate Water:**

- Series 10: 8 l/min.
- Series 11: 20 l/min.
- Series 12: 38 l/min.

pressure drop 0.5 bar

## KB Double Shut-Off

**Working Pressure\*:**  
up to 15 bar

**Material:**

- Coupling: Brass
- Plug: Brass
- Seals: FKM

**Working Temperature:**  
-15°C up to +200°C (FKM)

**Flow Rate Water:**

- Series 10: 7 l/min.
- Series 11: 15 l/min.
- Series 12: 28 l/min.

pressure drop 0.5 bar

\* maximum static working pressure with design factor 4 to 1.

### →|← Straight-Through

#### 10/11/12KFA Coupler without valve, Male Thread

Brass, FKM

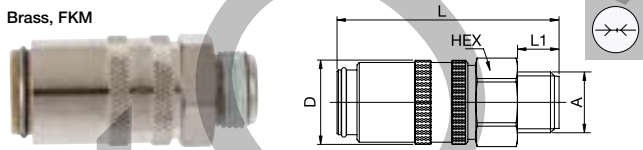

DN	Series	A	HEX	L	L1	D
6	10	M14 x 1.5	10KFAM14MVX	17	48	9 18
		G1/4	10KFAW13MVX	17	48	9 18
		G3/8	10KFAW17MVX	19	48	9 18
9	11	G1/4	11KFAW13MVX	22	51.5	9 23
		M16 x 1.5	11KFAM16MVX	22	51.5	9 23
		G3/8	11KFAW17MVX	22	51.5	9 23
13	12	G1/2	11KFAW21MVX	22	51.5	12 23
		G1/2	12KFAW21MVX	30	74	12 32
		G3/4	12KFAW26MVX	30	78	16 32

### →|← Straight-Through

#### 10/11KFAR Coupler without valve, Male Thread 90°

Brass, FKM

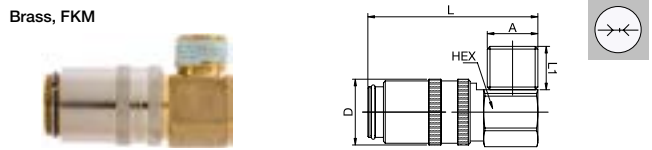

DN	Series	A	HEX	L	L1	D
6	10	G1/4	10KFAR13MVX	17	47	12 18
		M14 x 1.5	10KFAR14MVX	17	47	12 18
		M16 x 1.5	11KFAR16MVX	22	53.5	12 23

#### 10/11KFAH Coupler without valve, Male Thread 45°

Brass, FKM

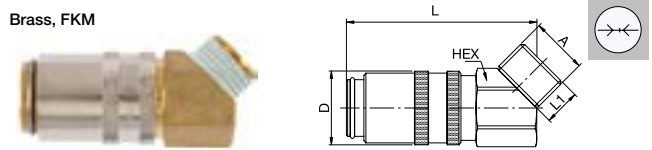

DN	Series	A	HEX	L	L1	D
6	10	G1/4	10KFAH13MVX	17	47	9 18
		M14 x 1.5	10KFAH14MVX	17	47	9 18
		M16 x 1.5	11KFAH16MVX	22	53.5	9 23





Straight-Through

## 10/11KFIW Coupler without valve, Female Thread

Brass, FKM

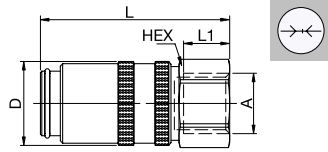
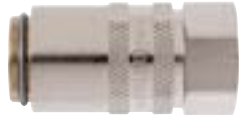

DN	Series	A	HEX	L	L1	D
6	10	G1/4	17	41	10	18
		G3/8	19	45	10	18
9	11	G1/4	21	46.5	10	23
		G3/8	21	46.5	10	23



Straight-Through

## 10/11KFTP Coupler without valve, Push-Lok

Brass, FKM

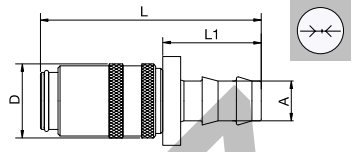

DN	Series	A	L	L1	D
6	10	10KFTP06MVX	50.5	20.4	18
		10KFTP10MVX	54	24.2	18
9	11	11KFTP10MVX	61	24.2	23
		11KFTP13MVX	64.5	27.9	23

## 10/11/12KFTF Coupler without valve, Hose Barb

Brass, FKM

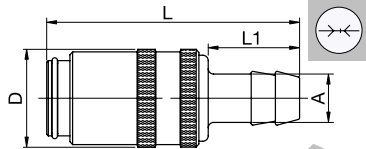

DN	Series	A	L	L1	D
6	10	9	52	22	18
9	11	13	61.5	25	23
13	12	19	90	32	32

## 10/11KFPR Coupler without valve, Push-Lok 90°

Brass, FKM

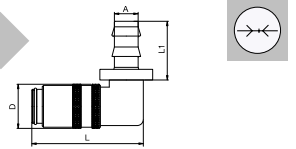

DN	Series	A	L	L1	D
6	10	10KFPR06MVX	46	20.4	18
		10KFPR10MVX	46	24.2	18
9	11	11KFPR10MVX	56.5	24.2	23
		11KFPR13MVX	56.5	27.9	23

## 10/11/12KFTR Coupler without valve, Hose Barb 90°

Brass, FKM

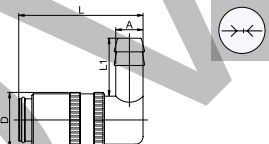

DN	Series	A	L	L1	D
6	10	9	41	22	18
9	11	13	51	28.5	23
13	12	19	78	32	32

## 10/11KFPH Coupler without valve, Push-Lok 45°

Brass, FKM

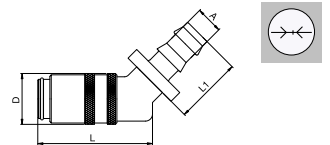

DN	Series	A	L	L1	D
6	10	10KFPH06MVX	41	20.4	18
		10KFPH10MVX	41	24.2	18
9	11	11KFPH10MVX	51	24.2	23
		11KFPH13MVX	51	27.9	23

## 10/11/12KFTH Coupler without valve, Hose Barb 45°

Brass, FKM

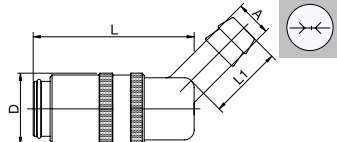

DN	Series	A	L	L1	D
6	10	9	52	22	18
9	11	13	51	25	23
13	12	19	78	30	32

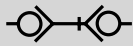
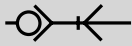

Single Shut-off / Double Shut-off

## 10/11/12KBA Coupler with valve, Male Thread

Brass, FKM

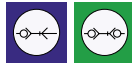
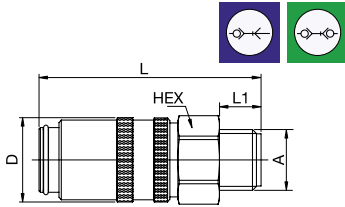

DN	Series	A	HEX	L	L1	D
6	10	M14 x 1.5 <b>10KBAM14MVX</b>	17	48	9	18
		G1/4 <b>10KBAW13MVX</b>	17	48	9	18
		G3/8 <b>10KBAW17MVX</b>	19	48	9	18
9	11	G1/4 <b>11KBAW13MVX</b>	22	51.5	9	23
		M16 x 1.5 <b>11KBAM16MVX</b>	22	51.5	9	23
		G3/8 <b>11KBAW17MVX</b>	22	51.5	9	23
13	12	G1/2 <b>11KBAW21MVX</b>	22	51.5	12	23
		G3/4 <b>12KBAW26MVX</b>	30	74	12	32

## 10/11KBAR Coupler with valve, Male Thread 90°

Brass, FKM

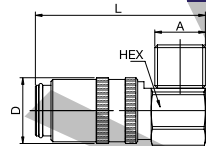

DN	Series	A	HEX	L	L1	D
6	10	G1/4 <b>10KBAR13MVX</b>	17	47	12	18
		M14 x 1.5 <b>10KBAR14MVX</b>	17	47	12	18
9	11	M16 x 1.5 <b>11KBAR16MVX</b>	22	53.5	12	23

## 10/11KBAH Coupler with valve, Male Thread 45°

Brass, FKM

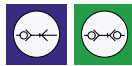
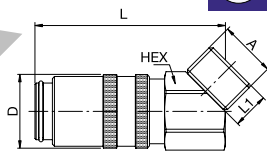

DN	Series	A	HEX	L	L1	D
6	10	G1/4 <b>10KBAH13MVX</b>	17	47	9	18
		M14 x 1.5 <b>10KBAH14MVX</b>	17	47	9	18
9	11	M16 x 1.5 <b>11KBAH16MVX</b>	22	53.5	9	23

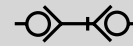
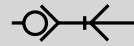

Single Shut-off / Double Shut-off

## 10/11KBIW Coupler with valve, Female Thread

Brass, FKM

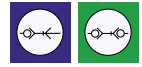
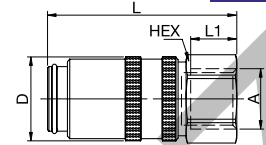

DN	Series	A	HEX	L	L1	D
6	10	G1/4 <b>10KBIW13MVX</b>	17	41	12	18
		G3/8 <b>10KBIW17MVX</b>	19	45	12	18
9	11	G1/4 <b>11KBIW13MVX</b>	21	46.5	10	23
		G3/8 <b>11KBIW17MVX</b>	21	46.5	10	23

## 10/11/12KBTF Coupler with valve, Hose Barb

Brass, FKM

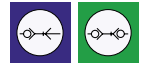
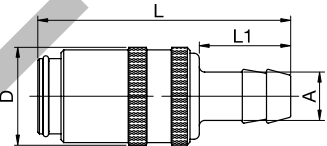

DN	Series	A	L	L1	D
6	10	9	52	22	18
9	11	13	61.5	25	23
13	12	19	90	32	32

## 10/11/12KBTR Coupler with valve, Hose Barb 90°

Brass, FKM

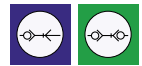
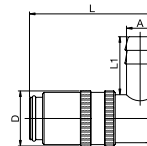

DN	Series	A	L	L1	D
6	10	9	41	22	18
9	11	13	51	28.5	23
13	12	19	78	32	32

## 10/11/12KBTH Coupler with valve, Hose Barb 45°

Brass, FKM

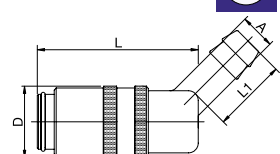

DN	Series	A	L	L1	D
6	10	9	52	22	18
9	11	13	51	25	23
13	12	19	78	30	32



Single Shut-off / Double Shut-off

## 10/11KBTP Coupler with valve, Push-Lok

Brass, FKM

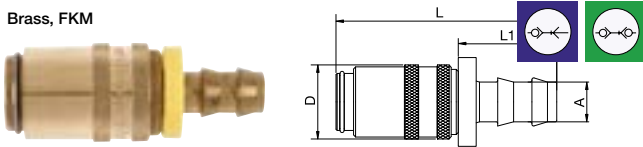

DN	Series	A		L	L1	D
6	10	6	<b>10KBTP06MVX</b>	50.5	20.4	18
		10	<b>10KBTP10MVX</b>	54	24.2	18
9	11	10	<b>11KBTP10MVX</b>	61	24.2	23
		13	<b>11KBTP13MVX</b>	64.5	27.9	23

## 10/11KBPR Coupler with valve, Push-Lok 90°

Brass, FKM

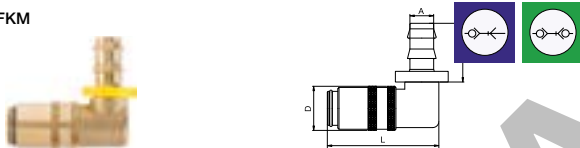

DN	Series	A		L	L1	D
6	10	6	<b>10KBPR06MVX</b>	46	20.4	18
		10	<b>10KBPR10MVX</b>	46	24.2	18
9	11	10	<b>11KBPR10MVX</b>	56.5	24.2	23
		13	<b>11KBPR13MVX</b>	56.5	27.9	23

## 10/11KBPH Coupler with valve, Push-Lok 45°

Brass, FKM

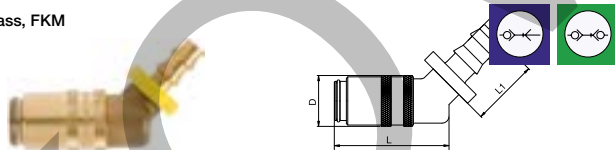

DN	Series	A		L	L1	D
6	10	6	<b>10KBPH06MVX</b>	41	20.4	18
		10	<b>10KBPH10MVX</b>	41	24.2	18
9	11	10	<b>11KBPH10MVX</b>	51	24.2	23
		13	<b>11KBPH13MVX</b>	51	27.9	23



Straight-Through / Single Shut-off

## 10/11/12SFA Plug without valve, Male Thread

Brass or stainless steel

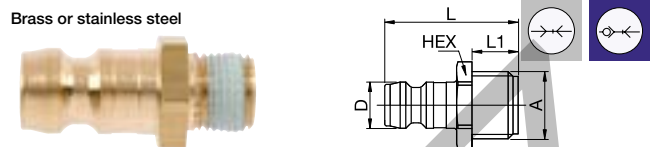

DN	Series	A		HEX	L	L1	D	Version	
6	10	M8 x 0.75	<b>10SFAM08MXX</b>	11	24	7	9	Brass	
		M10 x 1	<b>10SFAM10MXX</b>	11	24	7	9	Brass	
		M10 x 1	<b>10SFAM10RXX</b>	11	24	7	9	AISI 303	
		G1/8	<b>10SFAW10MXN</b>	11	24	7	9	Nickel-plated brass	
		G1/8	<b>10SFAW10RXX</b>	11	24	7	9	AISI 303	
		M12 x 1.5	<b>10SFAM12MXX</b>	14	27	10	9	Brass	
	9	10	G1/4	<b>10SFAW13MXN</b>	15	26	9	9	Nickel-plated brass
			G1/4	<b>10SFAW13RXX</b>	15	26	9	9	AISI 303
			M14 x 1.5	<b>10SFAM14MXX</b>	15	26	9	9	Brass
		11	G3/8	<b>10SFAW17MXN</b>	17	30	10	9	Nickel-plated brass
			G1/8	<b>11SFAW10MXN</b>	14	25	8	13.5	Nickel-plated brass
			G1/4	<b>11SFAW13MXN</b>	15	26	9	13.5	Nickel-plated brass
13	11	G1/4	<b>11SFAW13RXX</b>	15	26	9	13.5	AISI 303	
		M14 x 1.5	<b>11SFAM14MXX</b>	15	26	9	13.5	Brass	
		M16 x 1.5	<b>11SFAM16MXX</b>	17	26	9	13.5	Brass	
	12	G3/8	<b>11SFAW17MXN</b>	17	26	9	13.5	Nickel-plated brass	
		G3/8	<b>11SFAW17RXX</b>	17	26	9	13.5	AISI 303	
		G1/2	<b>12SFAW21MXN</b>	22	47	12	19	Nickel-plated brass	
G3/4	<b>12SFAW26MXN</b>	27	51	16	19	Nickel-plated brass			

## 10/11SFAR Plug without valve, Male Thread 90° tapered

Brass

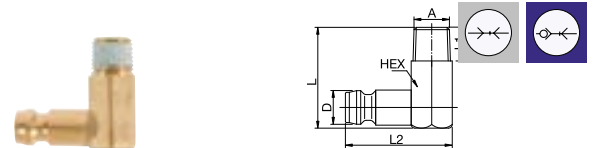

DN	Series	A		HEX	L	L1	L2	D	Version
6	10	M10 x 1	<b>10SFAR10MXX</b>	11	27	9	28.5	9	Brass
		R1/8	<b>10SFAR10MXN</b>	11	27	9	28.5	9	Nickel-plated brass
		R1/4	<b>10SFAR13MXN</b>	11	27	9	28.5	9	Nickel-plated brass
9	11	R1/4	<b>11SFAR13MXN</b>	15	34	11	32	13.5	Nickel-plated brass
		R3/8	<b>11SFAR17MXN</b>	15	34	11	32	13.5	Nickel-plated brass

  
 Straight-Through / Single Shut-off

## 10/11SFIW Plug without valve, Female Thread

Brass

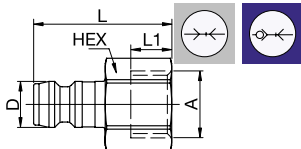

DN	Series	A	HEX	L	L1	D	
6	10	G1/8	10SFIW10MXN	11	24	9	9
		G1/4	10SFIW13MXN	16	27	9	9
9	11	G1/4	11SFIW13MXN	16	33	10	13.5

## 10/11/12SFTF Plug without valve, Hose Barb

Brass

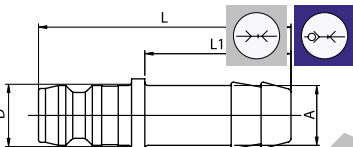

DN	Series	A	L	L1	D	
6	10	9	10SFTF09MXX	38	22	9
9	11	9	11SFTF09MXX	41	25	13.5
		13	11SFTF13MXX	41	25	13.5
13	12	19	12SFTF19MXX	61	32	19

  
 Straight-Through / Single Shut-off

## 10/11/12SBA Plug with valve, Male Thread

Brass, FKM

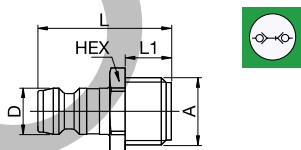

DN	Series	A	HEX	L	L1	D	Version	
6	10	G1/4	10SBAW13MVN	15	29	12	9	Nickel-plated brass
		M14 x 1.5	10SBAM14MVX	15	29	12	9	Brass
9	11	G1/4	11SBAW13MVN	15	31	12	13.5	Nickel-plated brass
		M16 x 1.5	11SBAM16MVX	17	30	12	13.5	Brass
		G3/8	11SBAW17MVN	17	30	12	13.5	Nickel-plated brass
13	12	G3/4	12SBAW26MVN	27	51	16	19	Nickel-plated brass

  
 Straight-Through

## 10/11VN Extension Plug, continuous Male Thread

Brass

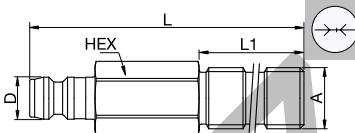

DN	Series	A	HEX	L	L1	D	
6	10	G1/8	10VN1010MXX	11	100	60	9
		G1/4	10VN1310MXX	14	100	60	9
9	11	G1/4	11VN1310MXX	14	100	60	13.5
		G3/8	11VN1710MXX	19	100	60	13.5

## 10/11VNXX Extension Plug, without Thread

Brass

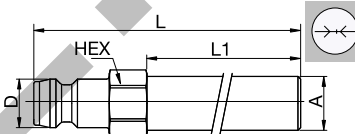

DN	Series	A	HEX	L	L1	D	
6	10	8	10VNXX10MXX	9	100	79	9
		10	10VNXX12MXX	11	120	100	9
		10	10VNXX24MXX	11	240	220	9
9	11	14	11VNXX15MXX	15	150	125	13.5
		14	11VNXX30MXX	15	300	275	13.5



SL

The 10 and 11 Rectus Moldtite coupling series with Safe-Lock technology were especially developed for connecting coolant lines and injection moulds. These stand out for their convenient, single-handed operation and a reliable O-ring seal. Widely used in Europe.

- Available in:
  - single shut-off, double shut-off or straight-through versions
- The straight-through couplings are equipped with nickel plated sleeves for quick and accurate visual differentiation
- The angular connections prevent kinks from forming in the hose
- Available on request:
  - series 10/11 are also available with special FFKM high-temperature seal for applications up to constant temperature 200°C

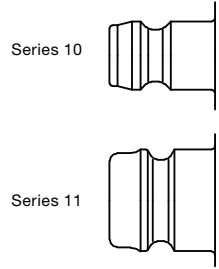

**KF** Straight-Through

**Working Pressure\*:**  
up to 15 bar

**Material:**

- Coupling: Brass
- Plug: Brass, stainless steel
- Seals: FKM

**Working Temperature:**  
-15°C up to +200°C (FKM)

**Flow Rate Water:**

- Series 10: 16 l/min.
- Series 11: 50 l/min.

pressure drop 0.5 bar

**KA** Single Shut-Off

**Working Pressure\*:**  
up to 15 bar

**Material:**

- Coupling: Brass
- Plug: Brass, stainless steel
- Seals: FKM

**Working Temperature:**  
-15°C up to +200°C (FKM)

**Flow Rate Water:**

- Series 10: 8 l/min.
- Series 11: 20 l/min.

pressure drop 0.5 bar

**KB** Double Shut-Off

**Working Pressure\*:**  
up to 15 bar

**Material:**

- Coupling: Brass
- Plug: Brass
- Seals: FKM

**Working Temperature:**  
-15°C up to +200°C (FKM)

**Flow Rate Water:**

- Series 10: 7 l/min.
- Series 11: 15 l/min.

pressure drop 0.5 bar

\* maximum static working pressure with design factor 4 to 1.

→|← Straight-Through

**10/11KFA** Coupler without valve, Male Thread, Safe-Lock

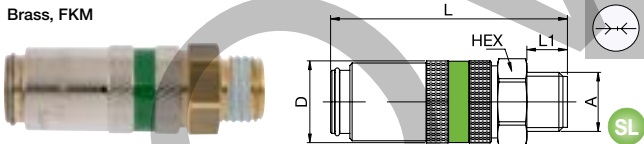

DN	Series	A	HEX	L	L1	D
6	10	G1/4	10KFAW13MVXSL	17	52.5	9 18
		M14 x 1.5	10KFAM14MVXSL	17	52.5	9 18
		G3/8	10KFAW17MVXSL	19	52.5	9 18
9	11	G1/4	11KFAW13MVXSL	22	62	9 24
		M16 x 1.5	11KFAM16MVXSL	22	62	9 24
		G3/8	11KFAW17MVXSL	22	62	9 24
		G1/2	11KFAW21MVXSL	22	65	12 24

→|← Straight-Through

**10/11KFTR** Coupler without valve, Hose Barb 90°, Safe-Lock

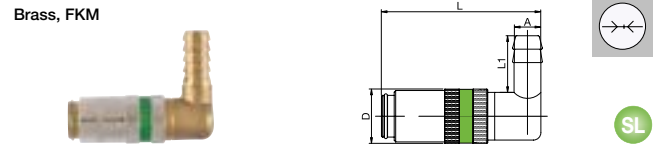

DN	Series	A	L	L1	D
6	10	9	10KFTR09MVXSL	53.5	22 18
9	11	13	11KFTR13MVXSL	63.5	28.5 24

**10/11KFTF** Coupler without valve, Hose Barb, Safe-Lock

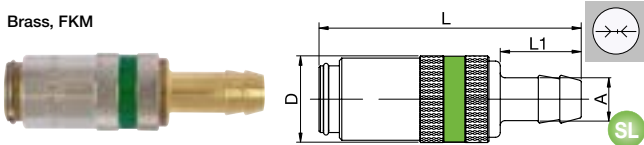

DN	Series	A	L	L1	D
6	10	9	10KFTF09MVXSL	60	22 18
9	11	13	11KFTF13MVXSL	71	25 24

**10/11KFTH** Coupler without valve, Hose Barb 45°, Safe-Lock

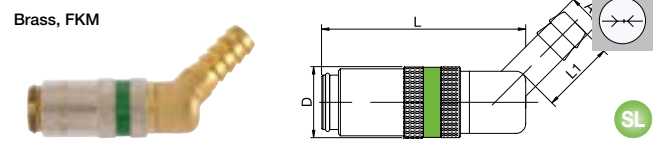

DN	Series	A	L	L1	D
6	10	9	10KFTH09MVXSL	60	22 18
9	11	13	11KFTH13MVXSL	60.5	25 24

# Series 10/11 - Safe Locking Technology



## 10/11KBA Coupler with valve, Male Thread, Safe-Lock

Brass, FKM

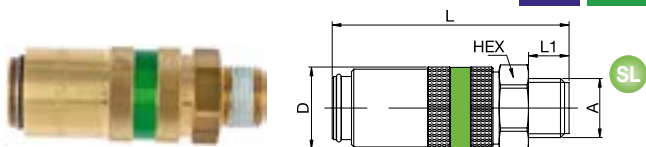

DN	Series	A		HEX	L	L1	D
6	10	G1/4	<a href="#">10KBAW13MVXSL</a>	17	52.5	9	18
		M14 x 1.5	<a href="#">10KBAM14MVXSL</a>	17	52.5	9	18
		G3/8	<a href="#">10KBAW17MVXSL</a>	19	52.5	9	18
9	11	G1/4	<a href="#">11KBAW13MVXSL</a>	22	62	9	24
		M16 x 1.5	<a href="#">11KBAM16MVXSL</a>	22	62	9	24
		G3/8	<a href="#">11KBAW17MVXSL</a>	22	62	9	24
		G1/2	<a href="#">11KBAW21MVXSL</a>	22	65	12	24



## 10/11KBTR Coupler with valve, Hose Barb 90°, Safe-Lock

Brass, FKM

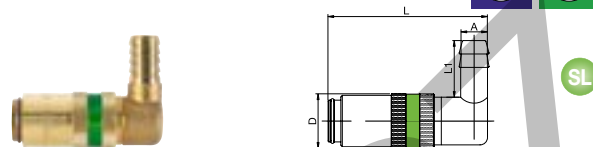

DN	Series	A		L	L1	D
6	10	9	<a href="#">10KBTR09MVXSL</a>	53.5	22	18
9	11	13	<a href="#">11KBTR13MVXSL</a>	63.5	28.5	24

## 10/11KBT Coupler with valve, Hose Barb, Safe-Lock

Brass, FKM

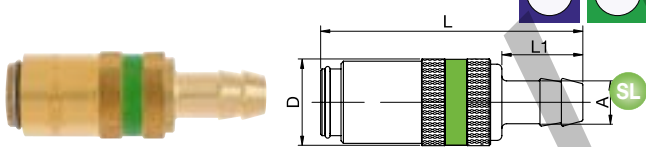

DN	Series	A		L	L1	D
6	10	9	<a href="#">10KBT09MVXSL</a>	60	22	18
9	11	13	<a href="#">11KBT13MVXSL</a>	71	25	24

## 10/11KBTH Coupler with valve, Hose Barb 45°, Safe-Lock

Brass, FKM

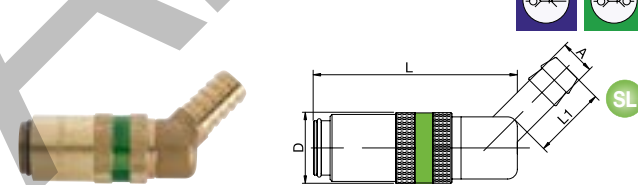

DN	Series	A		L	L1	D
6	10	9	<a href="#">10KBTH09MVXSL</a>	60	22	18
9	11	13	<a href="#">11KBTH13MVXSL</a>	60.5	25	24



SV

The 10 and 11 Rectus Moldtite coupling series with Safety Lock were especially developed for connecting coolant lines and injection moulds. These stand out for their convenient, single-handed operation and a reliable O-ring seal. Widely used in Europe. Coupling system with safety locking. Accidental uncoupling is prevented effectively and easily with the automatic safety lock.

- Available in:
  - single shut-off, double shut-off or straight-through versions
- The straight-through couplings are equipped with nickel plated sleeves for quick and accurate visual differentiation
- The angular connections prevent kinks from forming in the hose
- Available on request:
  - series 10/11 are also available with special FFKM high-temperature seal for applications up to constant temperature 200°C

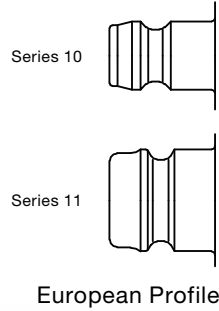

**KF** Straight-Through

**Working Pressure\*:**  
up to 15 bar

**Material:**

- Coupling: Brass
- Plug: Brass, stainless steel
- Seals: FKM

**Working Temperature:**  
-15°C up to +200°C (FKM)

**Flow Rate Water:**

- Series 10: 16 l/min.
- Series 11: 50 l/min.

pressure drop 0.5 bar

**KA** Single Shut-Off

**Working Pressure\*:**  
up to 15 bar

**Material:**

- Coupling: Brass
- Plug: Brass, stainless steel
- Seals: FKM

**Working Temperature:**  
-15°C up to +200°C (FKM)

**Flow Rate Water:**

- Series 10: 8 l/min.
- Series 11: 20 l/min.

pressure drop 0.5 bar

**KB** Double Shut-Off

**Working Pressure\*:**  
up to 15 bar

**Material:**

- Coupling: Brass
- Plug: Brass
- Seals: FKM

**Working Temperature:**  
-15°C up to +200°C (FKM)

**Flow Rate Water:**

- Series 10: 7 l/min.
- Series 11: 15 l/min.

pressure drop 0.5 bar

\* maximum static working pressure with design factor 4 to 1.

→|← Straight-Through

→|← Straight-Through

## 10/11KFA Coupler without valve, Male Thread

Brass, FKM

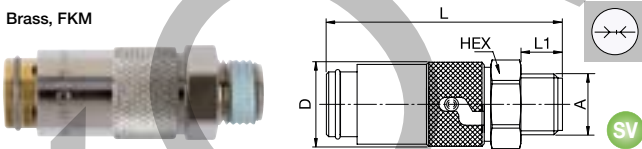

DN	Series	A	HEX	L	L1	D
6	10	G1/4	10KFAW13MVXSV	17	51	9 18
		M14 x 1.5	10KFAW14MVXSV	17	51	9 18
		G3/8	10KFAW17MVXSV	19	51	9 18
9	11	G1/4	11KFAW13MVXSV	22	59.5	9 23
		M16 x 1.5	11KFAW16MVXSV	22	59.5	9 23
		G3/8	11KFAW17MVXSV	22	59.5	9 23
		G1/2	11KFAW21MVXSV	22	62.5	12 23

## 10/11KFAR Coupler without valve, Male Thread 90°

Brass, FKM

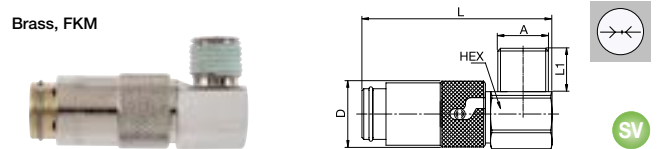

DN	Series	A	HEX	L	L1	D
6	10	G1/4	10KFAR13MVXSV	17	52.5	12 18
		M14 x 1.5	10KFAR14MVXSV	17	52.5	12 18
		G3/8	10KFAR17MVXSV	19	52.5	12 18
9	11	M16 x 1.5	11KFAR16MVXSV	22	61.5	12 23

## 10/11KFAH Coupler without valve, Male Thread 45°

Brass, FKM

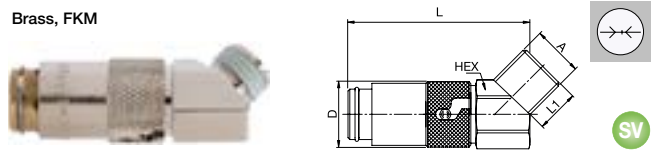

DN	Series	A	HEX	L	L1	D
6	10	G1/4	10KFAH13MVXSV	17	52.5	9 18
		M14 x 1.5	10KFAH14MVXSV	17	52.5	9 18
		G3/8	10KFAH17MVXSV	19	52.5	9 18
9	11	M16 x 1.5	11KFAH16MVXSV	22	61.5	9 23

# Series 10/11 - Safe Locking Technology



Straight-Through

## 10/11KFTF Coupler without valve, Hose Barb

Brass, FKM

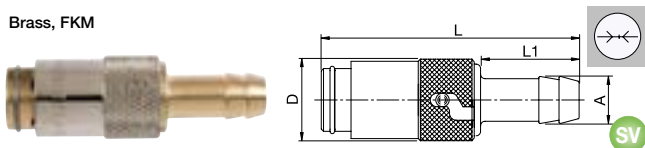

DN	Series	A		L	L1	D
6	10	9	10KFTF09MVXSV	57.5	22	18
9	11	13	11KFTF13MVXSV	68.5	25	23

## 10/11KFTR Coupler without valve, Hose Barb 90°

Brass, FKM

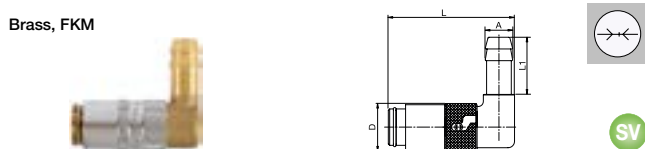

DN	Series	A		L	L1	D
6	10	9	10KFTR09MVXSV	48.5	22	18
9	11	13	11KFTR13MVXSV	56	28	23

## 10/11KFTH Coupler without valve, Hose Barb 45°

Brass, FKM

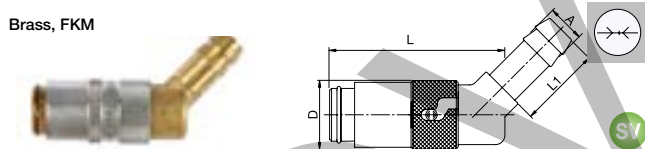

DN	Series	A		L	L1	D
6	10	9	10KFTH09MVXSV	46.5	22	18
9	11	13	11KFTH13MVXSV	56	28	23

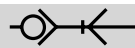

Single Shut-off / Double Shut-off

## 10/11KBA Coupler with valve, Male Thread

Brass, FKM

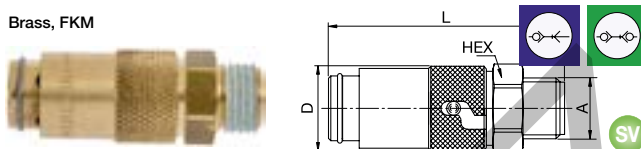

DN	Series	A		HEX	L	L1	D
6	10	G1/4	10KBAW13MVXSV	17	51	9	18
		M14 x 1.5	10KBAM14MVXSV	17	51	9	18
		G3/8	10KBAW17MVXSV	19	51	9	18
9	11	G1/4	11KBAW13MVXSV	22	59.5	9	23
		M16 x 1.5	11KBAM16MVXSV	22	59.5	9	23
		G3/8	11KBAW17MVXSV	22	59.5	9	23
		G1/2	11KBAW21MVXSV	22	62.5	12	23

## 10/11KBAR Coupler with valve, Male Thread 90°

Brass, FKM

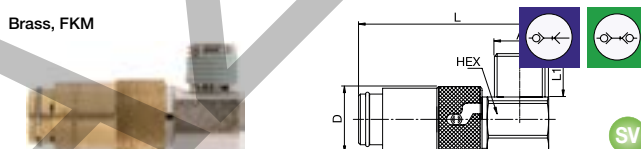

DN	Series	A		HEX	L	L1	D
6	10	G1/4	10KBAR13MVXSV	17	52.5	12	18
		M14 x 1.5	10KBAR14MVXSV	17	52.5	12	18
9	11	M16 x 1.5	11KBAR16MVXSV	22	61.5	12	23

## 10/11KBAH Coupler with valve, Male Thread 45°

Brass, FKM

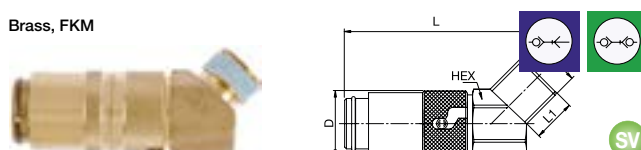

DN	Series	A		HEX	L	L1	D
6	10	G1/4	10KBAH13MVXSV	17	52.5	9	18
		M14 x 1.5	10KBAH14MVXSV	17	52.5	9	18
9	11	M16 x 1.5	11KBAH16MVXSV	22	61.5	9	23

## 10/11KBTF Coupler with valve, Hose Barb

Brass, FKM

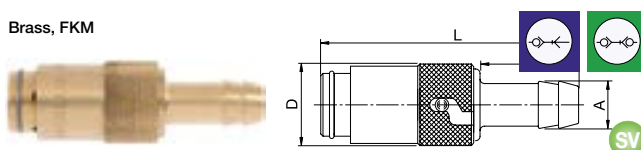

DN	Series	A		L	L1	D
6	10	9	10KBTF09MVXSV	57.5	22	18
9	11	13	11KBTF13MVXSV	68.5	25	23





Single Shut-off / Double Shut-off

## 10/11KBTR Coupler with valve, Hose Barb 90°

Brass, FKM

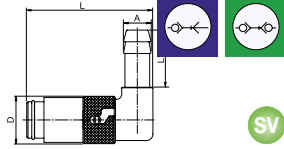

SV

DN	Series	A		L	L1	D
6	10	9	<b>10KBTR09MVXSV</b>	48.5	22	18
9	11	13	<b>11KBTR13MVXSV</b>	56	28	23

## 10/11KBTH Coupler with valve, Hose Barb 45°

Brass, FKM

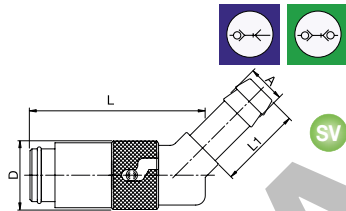

SV

DN	Series	A		L	L1	D
6	10	9	<b>10KBTH09MVXSV</b>	46.5	22	18
9	11	13	<b>11KBTH13MVXSV</b>	56	28	23



The 608 series (French series) has been specially developed for cooling in the field of plastic injection machines / moulds. Using vertical plug inserts, the cooling connection can be installed directly in the mould / machine, so the external contour has no protruding extension components. This allows easy and safe handling during the work process and prevents damage to the coupling and the mould. This system is supplied as a "straight-through coupling" with no valves. Coding of the in and outlets can be represented by simple fixing of the coloured clips / rings onto the coupling and plug.

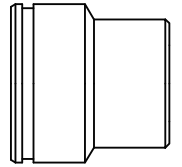

French Profile

The use of the locking balls means that an optimum grip of the plug connection is guaranteed, even with forces that are applied laterally. The simple unlocking mechanism, which is optimised by knurling at the end of the sleeve, can be operated by pulling back once on the sleeve.

**KF** Straight-Through

**Working Pressure\*:**  
up to 20 bar

**Material:**

- Coupling: Nickel plated brass
- Plug: Nickel plated brass
- Seals: FKM

**Working Temperature:**  
-15°C up to +200°C (FKM)

**Flow Rate Water:**  
32 l/min.  
pressure drop 0.5 bar

\* maximum static working pressure with design factor 4 to 1.

→|← Straight-Through

## 608KFIW Coupler without valve, Female Thread

Nickel-plated brass, FKM

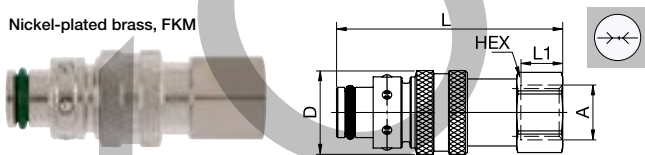

A	HEX	L	L1	D
G1/4	17	54	10	20

608KFIW13MVN

→|← Straight-Through

## 608KFTP Coupler without valve, Push-Lok

Nickel-plated brass, FKM

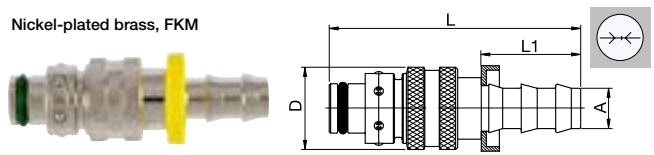

A	L	L1	D
10	61	24	20
13	66.5	28	20

608KFTP10MVN  
608KFTP13MVN

## 608KFTF Coupler without valve, Hose Barb

Nickel-plated brass, FKM

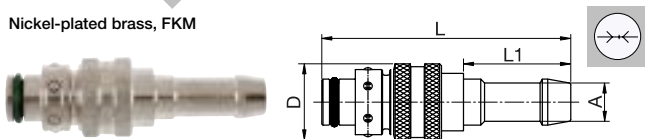

A	L	L1	D
8	65	28	20
10	65	28	20
12	65	28	20

608KFTF08MVN  
608KFTF10MVN  
608KFTF12MVN

## 608KFTR Coupler without valve, Hose Barb 90°

Nickel-plated brass, FKM

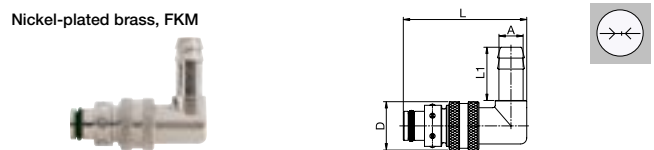

A	L	L1	D
10	51	20	20
12	51	20	20

608KFTR10MVN  
608KFTR12MVN

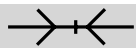

Straight-Through

## 608KFTH Coupler without valve, Hose Barb 45°

Nickel-plated brass, FKM

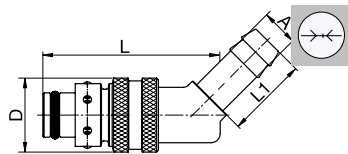

A		L	L1	D
10	<b>608KFTH10MVN</b>	51	20	20
12	<b>608KFTH12MVN</b>	51	20	20

## 608KFPR Coupler without valve, Push-Lok 90°

Nickel-plated brass, FKM

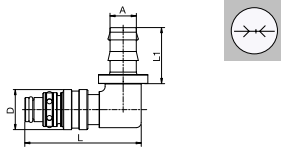

A		L	L1	D
10	<b>608KFPR10MVN</b>	54.5	24	20
13	<b>608KFPR13MVN</b>	58	28	20

## 608KFPH Coupler without valve, Push-Lok 45°

Nickel-plated brass, FKM

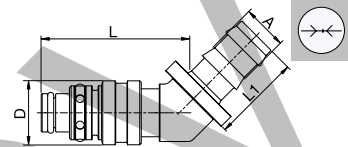

A		L	L1	D
10	<b>608KFPH10MVN</b>	44.5	24	20
13	<b>608KFPH13MVN</b>	47	28	20



Straight-Through

## 608SFA Plug without valve, Male Thread

Nickel-plated brass

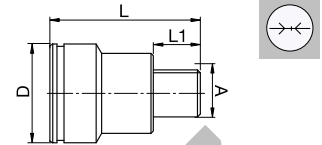

A		HEX	L	L1	L2	D
M10 x 1	<b>608SFAM10MXN</b>	6	32	10		21
G1/8	<b>608SFAW10MXN</b>	6	32	10		21
G1/4	<b>608SFAW13MXN</b>	8	33	12		21
G3/8	<b>608SFAW17MXN</b>	8	24	13		21
R1/8	<b>608SFAR10MXN</b>		34	11	33	22
G1/4	<b>608SFAR13MXN</b>		37	13	33	22
G3/8	<b>608SFAR17MXN</b>		37	13	33	22
R1/8	<b>608SFAH10MXN</b>		33	10.5		22
R1/4	<b>608SFAH13MXN</b>		35	13		22

## 608SFIW Plug without valve, Female Thread

Nickel-plated brass

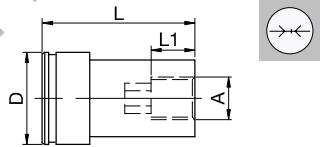

A		HEX	L	L1	D
G1/8	<b>608SFIW10MXN</b>	6	35	10	21
G1/4	<b>608SFIW13MXN</b>	8	40	14	21

## 608VN Extension Plug, Male Thread

Nickel-plated brass

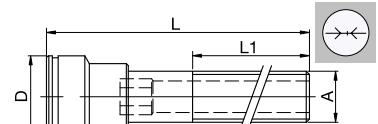

A		HEX	L	L1	D
G1/8	<b>608VN1005MXN</b>	6	50	28	21
G1/8	<b>608VN1010MXN</b>	6	100	60	21
G1/8	<b>608VN1015MXN</b>	6	150	60	21
G1/4	<b>608VN1305MXN</b>	8	50	28	21
G1/4	<b>608VN1310MXN</b>	8	100	60	21
G1/4	<b>608VN1315MXN</b>	8	150	60	21

## DHX608 Color Clip for Couplings and Plugs

POM



A		Color
Clip for Coupling	<b>DHX608KXXKXR</b>	RED
Clip for Coupling	<b>DHX608KXXKXB</b>	BLUE
Clip for Coupling	<b>DHX608KXXKXS</b>	BLACK
Clip for Plug	<b>DHX608SXXKXR</b>	RED
Clip for Plug	<b>DHX608SXXKXB</b>	BLUE
Clip for Plug	<b>DHX608SXXKXS</b>	BLACK