

BLOWGUNS

Blowgun Range

| | Materials | Fluids | Maximum Pressure (bar) | Temperature | | Characteristics | Page |
|---|--|-------------------|------------------------|-------------|--------|---|------|
| | | | | Min. | Max. | | |
| Industrial Blowguns | | | | | | | |
| <p>Polymer</p>  | Technical polymer | Compressed air | 10 | -20°C | +50°C | OSHA* | 428 |
| <p>Blowguns with special features</p>  | Technical polymer, Nickel-plated brass | Compressed air | 10 | -20°C | +50°C | Safety, SUVA safety, Energy saving, OSHA* | 429 |
| <p>Nozzles</p>  | Nickel-plated brass | Compressed air | 10 | -15°C | +50°C | A large number of nozzles for all your applications | 430 |
| <p>Metal</p>  | Aluminium or nickel-plated brass | Industrial fluids | 20 | -20°C | +100°C | Robustness, lightweight & ergonomic | 432 |
| <p>Blowgun Kits</p>  | Technical polymer | Compressed air | 10 | -20°C | +50°C | Easy to use, ready for use/safety & performance | 434 |

Standard Blowguns



4 ranges of blowguns to adapt to basic, standard, safety and energy saving applications. Assembled or in kit form to offer flexibility, in technical or metallic polymers, they can meet all needs.

Technical Characteristics

- **Compatible Fluids:** Compressed air
Other fluids: contact us
- **Working Pressure:** 0 to 10 bar
- **Working Temperature:** Air: -15°C to +50°C
Dry air: -20°C to +80°C
- **Tubes:** Tubes and hoses

Advantages

Basic & standard blowguns:

- In compliance with international noise and pressure regulations
- Swivel nozzles for directional jet
- Progressive flow rate

Safety blowguns:

- Meets OSHA or SUVA standards according to model and complies with:
 - noise exposure requirements
 - provisions relating to outlet pressure
- Energy-saving blowguns:
- Limited flow for lower energy consumption
- Kits and nozzles: to ensure a suitable product

Component Materials

Silicone-free

Body:
technical polymer

Connection:
nickel-plated
brass

Nozzle:
• aluminium
(Standard blowgun)
• nickel-plated brass
(Safety and
other blowguns)

Trigger:
technical polymer

Regulations

- **PED**
- **RoHS**
- **REACH**
- **Protection of design:**
- **OSHA**
- **DI: 2003/10/CE**

All designs and models of Parker Legris blowguns have been registered with the following numbers:
13 224/13 225/13 226

Regulation relating to exposure to noise, particularly with regard to risks to hearing. The noise level must be less than 87 dBA

Operation: Safety Blowgun



Flow stopped completely and pressure reduced to 0.5 bar

Operation: Blowgun with Safety Nozzle



Flow diverted and pressure reduced to 0.5 bar



Maximum Flow Rate
(tolerance +/-10%)



Noise Level
ISO 15744



Diffusion
Cone



Compliance
with Standards

Standard Blowguns

AK13 Blowgun with aluminium extension tube fixed nozzle

Impact resistant plastic



A



Female Thread G1/4 AK13

nozzle, impossible to replace

Progressive flow depending on the trigger position

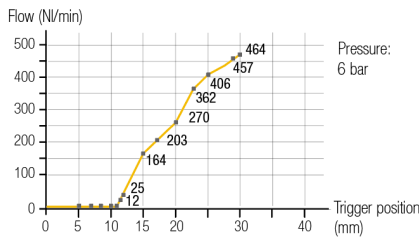

Pressure:
6 bar



464 Nl/min



OSHA 1910.95 (b)
2003/10/EC directive:

AK13SE AK13-Set in Display Box



A



Female Thread G1/4 AK13SET

10x AK13 in display box

AM13 Blowgun without nozzle, Female BSPP Thread

Impact resistant plastic



C

C1



G1/4 M12x1.25 AM13

AK26SF Blowgun with aluminium extension tube fixed nozzle

Impact resistant plastic



A



Plug Series 26 AK26SF

AJ13 Blowgun with aluminium extension tube, Female BSPP Thread

Red impact resistant plastic



C



Extension
tube

| | | |
|------|-----------|----------------------|
| G1/4 | AJ13/06B | 6 mm bent |
| G1/4 | AJ13/08B | 8 mm bent |
| G1/4 | AJ13-300 | 8 x 300 mm straight |
| G1/4 | AJ13-500 | 8 x 500 mm straight |
| G1/4 | AJ13-1000 | 8 x 1000 mm straight |

Complementary Products

HOSE REEL ENCLOSED CASE

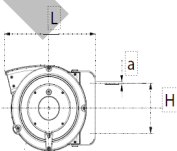

Hose clutch with free return
Hose length upstream: 1,50m
Input connection: bare pipe - Output connection: 1/4" male

| Transair® | ØD | Hose Length (m) | Hose i.d. (mm) | Max. Pressure (bar) | H | L | Kg |
|------------|------|-----------------|----------------|---------------------|-----|-----|-------|
| 6698 10 01 | 6 | 10 | 8 | 15 | 170 | 350 | 3.400 |
| 6698 10 02 | 10.5 | 16 | 8 | 15 | 251 | 470 | 6.440 |

RECOIL TUBINGS

PA RECOIL TUBINGS PU RECOIL TUBINGS

PA and PU recoil tubings offer an alternative to reels thanks to the remanence of the coil shape given to the tubes

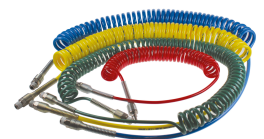
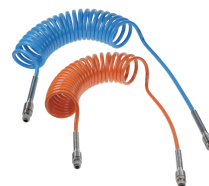

Page 412

Page 408

0654 Safety Blowgun, Lower Connection, Female BSPP Thread

Technical polymer, Nickel-plated brass, NBR

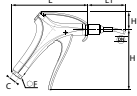

| DN | C | F | H | H1 | L | L1 | Kg | |
|----|------|------------|----|-----|----|-----|----|-------|
| 3 | G1/4 | 0654 00 13 | 20 | 117 | 35 | 148 | 73 | 0.189 |

Nozzle: nickel-plated brass, NPT version available.

Progressive flow depending on the trigger position

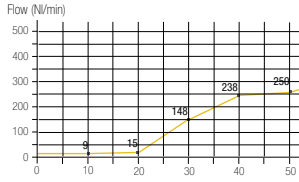

- Pressure: 6 bar
- 250 N/min
- 80 dBA
- OSHA 1910.242 (b)
- OSHA 1910.95 (a)
- 2003/10/EC directive:
- No ear defenders necessary

0654 SUVA Safety Blowgun, Lower Connection, Female BSPP Thread

Technical polymer, nickel-plated brass, NBR

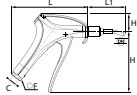

| DN | C | F | H | H1 | L | L1 | Kg | |
|----|------|------------|----|-----|----|-----|----|-------|
| 3 | G1/4 | 0654 01 13 | 20 | 117 | 35 | 148 | 73 | 0.189 |

Nozzle: nickel-plated brass, NPT version available.

Progressive flow depending on the trigger position

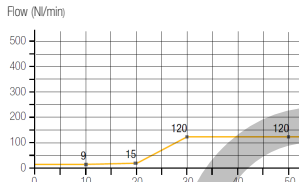

- Pressure: 6 bar
- 120 N/min
- 80 dBA
- OSHA 1910.242 (b)
- OSHA 1910.95 (b)
- 2003/10/EC directive:
- No ear defenders necessary

0653 Energy Saving Blowgun, Lower Connection with Interchangeable Nozzle, Female BSPP Thread

Technical polymer, Nickel-plated brass, NBR

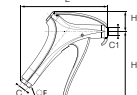

| C | C1 | F | H | H1 | L | L1 | Kg |
|------|----------|------------|----|-----|----|-----|-------|
| G1/4 | M12x1.25 | 0653 66 13 | 20 | 117 | 34 | 147 | 0.144 |

Flow characteristics depend on the type of nozzle used, delivered without nozzle. An energy saving calculator is available.

Progressive flow depending on the trigger position

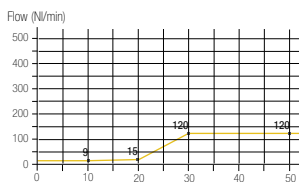

- Pressure: 6 bar
- 120 N/min
- 80 dBA
- Whatever the type of nozzle
- Noise level measured without nozzle
- Depends on type of nozzle
- OSHA 1910.95 (a)
- 2003/10/EC directive:
- No ear defenders necessary

0652 Progressive Control Blowgun, Lower Connection with Interchangeable Nozzle, Female BSPP Thread

Technical polymer, Nickel-plated brass, NBR

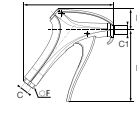

| C | C1 | F | H | H1 | L | L1 | Kg |
|------|----------|------------|----|-----|----|-----|-------|
| G1/4 | M12x1.25 | 0652 66 13 | 20 | 117 | 34 | 147 | 0.163 |

Flow characteristics depend on the type of nozzle used. Delivered without nozzle.

- Pressure: 6 bar
- 86 dBA
- Depending on the type of nozzle
- Noise level measured without nozzle
- OSHA 1910.242 (b)
- Depends on type of nozzle
- OSHA 1910.95 (a)
- 2003/10/EC directive:
- Requirement to use ear protection if exposure > 8 hours

0651 Progressive Control Blowgun, Lower Connection with Standard Nozzle, Female BSPP Thread

Technical polymer, Nickel-plated brass, NBR

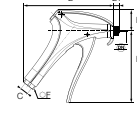

| DN | C | F | H | H1 | L | L1 | Kg | |
|-----|------|------------|----|-----|----|-----|----|-------|
| 2.5 | G1/4 | 0651 66 13 | 20 | 117 | 34 | 147 | 10 | 0.168 |

Nozzle: nickel-plated brass

Progressive flow depending on the trigger position

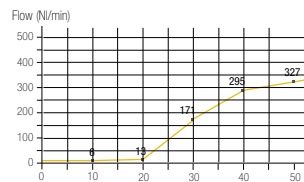

- Pressure: 6 bar
- 327 N/min
- 86 dBA
- Flow produced with nozzle 0690 01 00
- OSHA 1910.95 (a)
- 2003/10/EC directive:
- Requirement to use ear protection if exposure > 8 hours

0656 Progressive Control Blowgun, Lower Connection with Short Angled Nozzle, Female BSPP Thread

Technical polymer, Nickel-plated brass, NBR

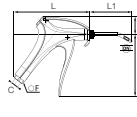

| DN | C | F | H | H1 | L | L1 | Kg | |
|-----|------|------------|----|-----|----|-----|----|-------|
| 2.5 | G1/4 | 0656 66 13 | 20 | 117 | 34 | 147 | 81 | 0.173 |

Nozzle: nickel-plated brass

Progressive flow depending on the trigger position

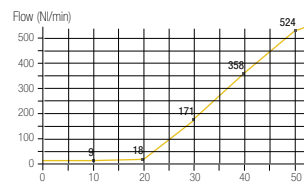

- Pressure: 6 bar
- 524 N/min
- 86 dBA
- Flow produced with nozzle 0690 06 01
- OSHA 1910.95 (a)
- 2003/10/EC directive:
- Requirement to use ear protection if exposure > 8 hours

Nozzles for Polymer Blowguns

0690 01 Standard Nozzle

Nickel-plated brass

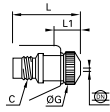

| DN | C | | G | L | L1 | Kg |
|-----|----------|------------|----|----|----|-------|
| 2.5 | M12x1.25 | 0690 01 00 | 15 | 31 | 9 | 0.023 |



- Versatile use
- Progressive and powerful air jet

327 N/min

86 dBA

23°

OSHA 1910.95 (b) 2003/10/EC directive: Requirement to use ear protection if exposure > 8 hours

0690 04 Safety Straight Nozzle (Short)

Nickel-plated brass, NBR

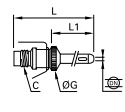

| DN | C | | G | L | L1 | Kg |
|-----|----------|------------|----|-----|----|-------|
| 2.5 | M12x1.25 | 0690 04 00 | 15 | 102 | 77 | 0.034 |



- Restricted access
- Air screen effect and directional jet
- Safety: avoids the nozzle becoming completely blocked

410 N/min

82 dBA

21°

OSHA 1910.242 (b) / OSHA 1910.95 (b) 2003/10/EC directive: Requirement to use ear protection if exposure > 8 hours

0690 02 Safety Nozzle

Nickel-plated brass

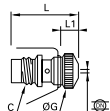

| DN | C | | G | L | L1 | Kg |
|-----|----------|------------|----|----|----|-------|
| 2.5 | M12x1.25 | 0690 02 00 | 15 | 31 | 9 | 0.024 |



- Fluidised Powders
- Air screen effect
- Safety: avoids the nozzle becoming completely blocked

315 N/min

83 dBA

26°

OSHA 1910.95 (b) / 1910.242 (b) 2003/10/EC directive: Requirement to use ear protection if exposure > 8 hours

0690 05 Angled Nozzle (Long)

Nickel-plated brass, NBR

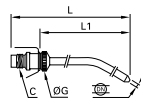

| DN | C | | G | L | L1 | Kg |
|-----|----------|------------|----|-----|-----|-------|
| 2.5 | M12x1.25 | 0690 05 00 | 15 | 316 | 292 | 0.065 |



- Restricted or distant access
- Progressive and powerful air jet
- 360° rotation

354 N/min

82 dBA

21°

OSHA 1910.95 (b) 2003/10/EC directive: Requirement to use ear protection if exposure > 8 hours

0690 03 Straight Nozzle (Long)

Nickel-plated brass, NBR

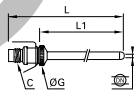

| DN | C | | G | L | L1 | Kg |
|-----|----------|------------|----|-----|-----|-------|
| 2.5 | M12x1.25 | 0690 03 00 | 15 | 332 | 307 | 0.067 |



- Restricted access
- Progressive and powerful air jet

386 N/min

82 dBA

21°

OSHA 1910.95 (b) 2003/10/EC directive: Requirement to use ear protection if exposure > 8 hours

0690 06 Safety Angled Nozzle (Short)

Nickel-plated brass, NBR



| DN | C | | G | L | L1 | Kg |
|-----|----------|------------|----|----|----|-------|
| 2.5 | M12x1.25 | 0690 06 00 | 15 | 94 | 70 | 0.033 |



- Restricted access
- Air screen effect and 360° directional jet
- Safety: avoids the nozzle becoming completely blocked

350 N/min

86 dBA

21°

OSHA 1910.242 (b) / OSHA 1910.95 (b) 2003/10/EC directive: Requirement to use ear protection if exposure > 8 hours

Nozzles for Polymer Blowguns

0690 06 01 Angle Nozzle (Short)

Nickel-plated brass, NBR

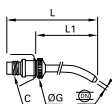

| DN | C | | G | L | L1 | Kg | |
|-----|----------|--|---|----|----|----|-------|
| 2.5 | M12x1.25 | | | 15 | 94 | 70 | 0.035 |



- Difficult access
- Progressive and powerful air jet, 360° rotation

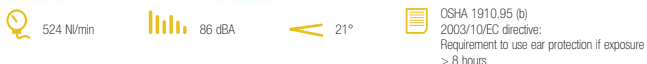

0690 08 COANDA Nozzle

Nickel-plated brass

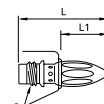

| C | | | L | L1 | Kg |
|----------|--|--|------|----|-------|
| M12x1.25 | | | 47.5 | 26 | 0.033 |

Nozzle not compatible with Rectus blowguns



- Directional air jet
- Very quiet, energy-saving
- Safety: avoids the nozzle becoming completely blocked



0690 07 Nozzle with LF 3000® Push-In Connection

Nickel-plated brass, NBR

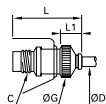

| ØD | C | | G | L | L1 | Kg | |
|----|----------|--|---|----|----|----|-------|
| 4 | M12x1.25 | | | 15 | 35 | 13 | 0.024 |



- Restricted access
- Progressive air jet



0690 10 Safety Booster Nozzle

Nickel-plated brass

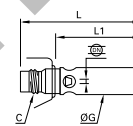

| DN | C | | G | L | L1 | Kg | |
|-----|----------|--|---|----|----|----|-------|
| 2.5 | M12x1.25 | | | 15 | 64 | 42 | 0.038 |



- High flow for blowing large surfaces
- Air screen effect
- Safety: avoids the nozzle becoming completely blocked



0690 09 Air Screen Safety Nozzle

Nickel-plated brass

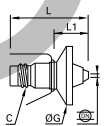

| DN | C | | G | L | L1 | Kg | |
|----|----------|--|---|----|------|------|-------|
| 2 | M12x1.25 | | | 30 | 40.5 | 18.5 | 0.021 |

Deflector: technical polymer



- High flow for blowing large surfaces
- Air screen and deflector to avoid particles being blown back
- Safety: avoids the nozzle becoming completely blocked



0690 11 Safety Booster Nozzle with Air Screen

Nickel-plated brass

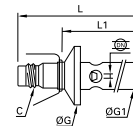

| DN | C | | G | G1 | L | L1 | Kg | |
|-----|----------|--|---|----|----|----|----|-------|
| 2.5 | M12x1.25 | | | 30 | 15 | 76 | 54 | 0.045 |

Deflector: technical polymer



- Same advantage as the Booster nozzle
- Safety: avoids the nozzle becoming completely blocked
- Air screen and deflector avoid particles being blown back



Metal Blowguns



This range of robust blowguns guarantees a longer service life under severe conditions (crushing, impact, shock and corrosion). It includes two versions for blowing and spraying in industrial applications.

Technical Characteristics

| Model | Metal Blowgun | Water Pistol |
|---------------------|--|-----------------------------------|
| Compatible Fluids | Compressed air, industrial fluids | Water, oil, industrial fluids |
| Working Pressure | 0 to 10 bar | 0 to 20 bar |
| Working Temperature | Air: -15°C to +50°C Dry air: -20°C to +80°C | -20°C to +100°C |
| Tubes | Tubes and hoses | Braided hose with Parker couplers |

Regulations

- PED
- REACH
- RoHS

Component Materials

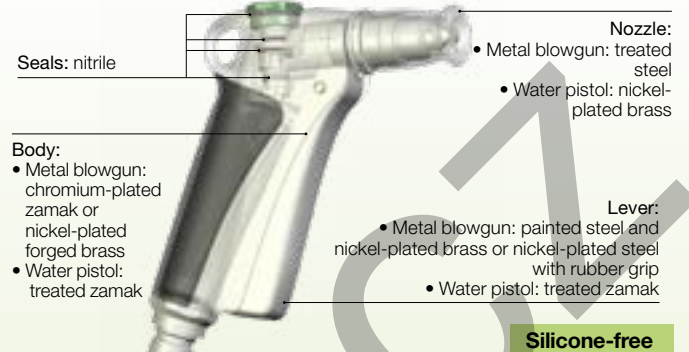

Advantages

Workshop blowgun

- Compact
- Nickel-plated forged brass for increased corrosion resistance

Water pistol

- The transmission of water and fluids
- Designed for precise flow control and optimisation of the power and shape of the jet
- Optimum use of industrial fluids

AA13S-01 Blowgun without nozzle, Female BSPP Thread but compatible with nozzles on previous page

Aluminium



C



G1/4 AA13S-01

AS13 Blowgun with safety nozzle, Female BSPP Thread

Aluminium



C



G1/4 AS13

AA13 Blowgun with standard nozzle, Female BSPP Thread

Aluminium



C



G1/4 AA13

AV13 Blowgun with extension tube, Female BSPP Thread

Aluminium



C



G1/4 AV13

0623 Lever-Operated Blowgun, Female BSPP Thread

Nickel-plated brass, zinc plated blister steel, NBR

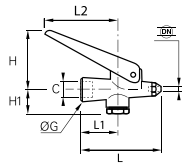

| DN | C | | G | H1 | H max | H min | L | L1 | L2 | Kg |
|----|------|-------------------|----|----|-------|-------|----|----|----|-------|
| 2 | G1/4 | 0623 10 35 | 18 | 21 | 37 | 19 | 64 | 28 | 60 | 0.119 |

This blowgun has a hardened steel nozzle.

0622 Button-Operated Blowgun, Female BSPP Thread

Nickel-plated brass, zinc plated blister steel, NBR

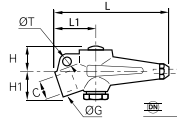

| DN | C | | G | H | H1 | L | L1 | T | Kg |
|----|------|-------------------|----|------|------|----|----|---|-------|
| 2 | G1/4 | 0622 26 73 | 18 | 17.5 | 20.5 | 82 | 29 | 7 | 0.199 |

This blowgun has a hardened steel nozzle.

2299 Water Pistol

Zamak, nickel-plated brass, NBR

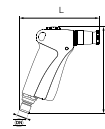

| DN | | | H | L | Kg |
|----|-------------------|--|-----|-----|-------|
| 12 | 2299 12 01 | | 140 | 126 | 0.470 |

This pistol allows independent control of:

- the flow rate (trigger) up to 1440 NI/min (air) and up to 16,2 NI/min (water)
- type of jet (adjustable to a fine mist) by the adjustable nozzle
- Compatible with the midi series couplers shown on page 381
- Can be used with Midi series couplers on page 381

2299 Adjustable Nozzle

Nickel-plated brass, NBR

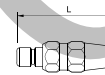

| DN | | | L | Kg |
|----|-------------------|--|------|-------|
| 12 | 2299 12 20 | | 77.4 | 0.137 |

This nozzle allows adjustment of the spray.

Complementary Product:

Couplers Midi Series, page 381



Blowgun Kits



Ergonomic, the blowgun kit remains an essential item of equipment for blowing or spraying operation in industrial environment.

Technical Characteristics

- **Compatible Fluids:** Compressed air
Other fluids: contact us
- **Working Pressure:** 0 to 10 bar
- **Working Temperature:** Air: -15°C to +50°C
Dry air: -20°C to +80°C
- **Tubes:** Recoil tubing

Regulations

- **PED**
- **RoHS**
- **REACH**
- **OSHA**
- **DI: 2003/10/CE**

Regulation relating to exposure to noise, particularly with regard to risks to hearing. The noise level must be less than 87 dBA

Design protection:

All designs and models of Parker Legris blowguns have been registered with the following numbers: 13 224/13 225/13 226

Component Materials

Body:
technical polymer

Insert:
nickel-plated brass

Tube:
recoil polyurethane

Nozzle:
• Standard blowgun: aluminium
• Safety and other blowguns:
nickel-plated brass

Trigger:
technical polymer

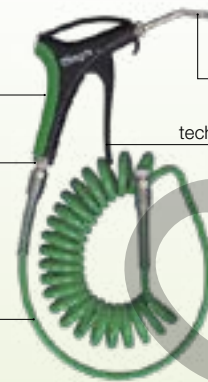

Silicone-free

Advantages

- **Kit contents:**
 - one blowgun
 - a 4 metre recoil tube
 - one R1/4 threaded fitting, external diameter 8 mm
- **Safety**
- **Optimisation of your energy consumption**
- **Minimum pressure drop**

0631..09 Blowgun Kit, Lower Connection, Male BSPT Thread

Technical polymer, Nickel-plated brass, treated aluminium, NBR

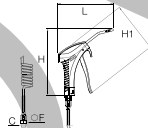

| C | F | H | H1 | L | Kg |
|-----------------|----|-------|-------|-----|-------|
| R1/4 0631 00 09 | 16 | 192.5 | 139.5 | 152 | 0.441 |

Flow characteristics, noise level and norm compliance are identical to those of our blowguns (0659 00 13).

0631..23 Energy Saving Blowgun Kit with Angled Nozzle, Male BSPT Thread

Technical polymer, Nickel-plated brass, NBR

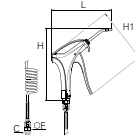

| C | F | H | H1 | L | Kg |
|-----------------|----|-----|-------|-----|-------|
| R1/4 0631 00 23 | 16 | 195 | 148.5 | 163 | 0.456 |

Flow characteristics, noise level and norm compliance are identical to those of our blowguns (0653 66 13).
External diameter of tube 6 mm

0631..01 Safety Blowgun Kit, Lower Connection, Male BSPT Thread

Technical polymer, Nickel-plated brass, NBR

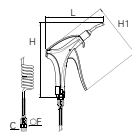

| C | F | H | H1 | L | Kg |
|-----------------|----|-------|-------|-----|-------|
| R1/4 0631 00 01 | 16 | 198.5 | 148.5 | 154 | 0.575 |

Flow characteristics, noise level and norm compliance are identical to those of our blowguns (0654 00 13).

0631..05 Blowgun Kit Lower Connection with Short Angled Nozzle, Male BSPT Thread

Technical polymer, Nickel-plated brass, NBR

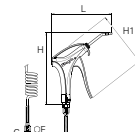

| C | F | H | H1 | L | Kg |
|-----------------|----|-------|-------|-----|-------|
| R1/4 0631 00 05 | 16 | 195.5 | 148.5 | 163 | 0.536 |

Flow characteristics, noise level and norm compliance are identical to those of our blowguns (0656 66 13).

0631..07 Blowgun Kit, Lower Connection with Interchangeable Nozzle, Male BSPT Thread

Technical polymer, Nickel-plated brass, NBR

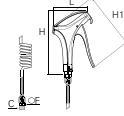

F H H1 L Kg

| | | | | | | |
|------|-------------------|----|-----|-------|----|-------|
| R1/4 | 0631 00 07 | 16 | 163 | 148.5 | 91 | 0.617 |
|------|-------------------|----|-----|-------|----|-------|

Flow characteristics, noise level and norm compliance are identical to those of our blowguns (0656 66 13).
Delivered without nozzle.

KROVAVAZI.CZ