

# Needle Valves



Made of nickel-plated brass or stainless steel, the needle valves are designed for applications that require manual flow adjustment.

## Technical Characteristics

	Brass	Stainless Steel
<b>Compatible Fluids</b>	Compressed air, water, industrial fluids, etc. Other fluids: contact us	Many fluids
<b>Working Pressure</b>	0 to 120 bar	0 to 400 bar
<b>Working Temperature</b>	-20°C to +100°C (except model 0510)	-20°C to +180°C

Reliable performance is dependent upon the type of fluid conveyed.

## Advantages

- Manual flow adjustment
- Numerous valve and safety accessory configurations

## Component Materials

### Silicone-free

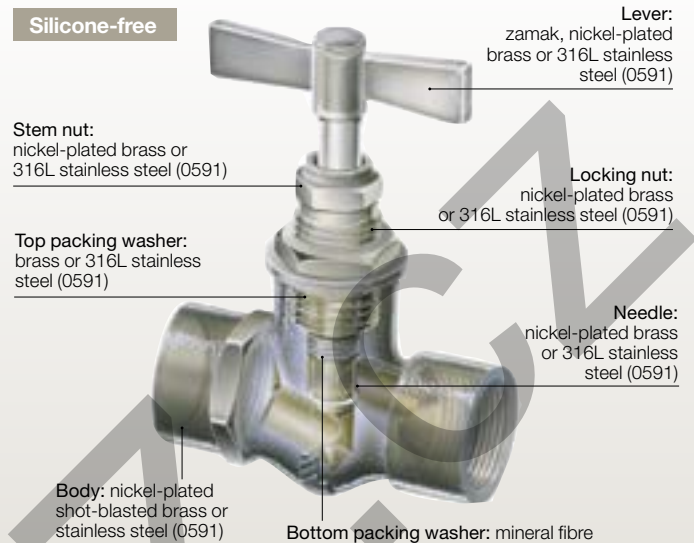

## Regulations

- PED
- REACH
- RoHS

## 0502 In-Line Needle Valve, Female BSPP Thread

Nickel-plated brass

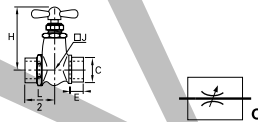

DN	C	Part No.	E	H	H max	J	L/2	Kg
4	G1/8	0502 04 10	9	56	50	17	23	0.133
	G1/4	0502 04 13	11	56	50	17	23	0.120
6	G3/8	0502 06 17	12	67	60	26	0.171	
9	G3/8	0502 09 17	12	82	70	33	0.426	

## 0510 In-Line Needle Valve with Compression Connections

Nickel-plated brass

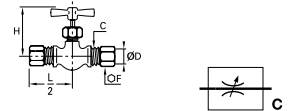

DN	ØD	C	Part No.	F	H min	H max	L/2	Kg
4	6	M10x1	0510 04 06	13	42	46	29	0.083
8	8	M12x1	0510 05 08	14	42	46	30	0.083
5	10	M16x1.5	0510 05 10	19	42	46	31	0.134

The needle is sealed by an O-ring.  
Maximum operating pressure: Ø4: 100 bar, Ø5: 60 bar  
Working temperature: -15°C to +70°C  
Tightening torques: please refer to the Compression Fittings chapter of this catalogue.

## 0501 In-Line Needle Valve, Male/Female BSPP Thread

Nickel-plated brass

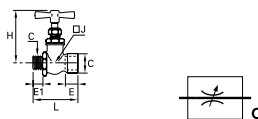

DN	C	Part No.	E	E1	H	H max	J	L	Kg
4	G1/8	0501 04 10	9	7	56	50	17	44	0.118
	G1/4	0501 04 13	11	9.5	56	50	17	46	0.115
6	G3/8	0501 06 17	12	9.5	67	60	48	0.158	

## 0532 Right-Angle Needle Valve, Female BSPP Thread

Nickel-plated brass

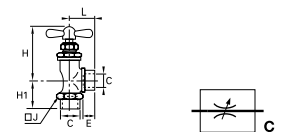

DN	C	Part No.	E	H min	H max	H1	J	L	Kg
4	G1/8	0532 04 10	9	46	52	46	19	17	0.093
	G1/4	0532 04 13	11	46	52	46	21	17	0.087
6	G1/4	0532 06 13	11	55	63	55	26	22	0.171

## 0531 Right-Angle Needle Valve, Male/Female BSPP Thread

Nickel-plated brass

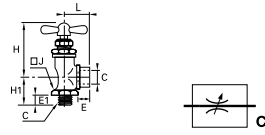

DN	C	E	E1	H min	H max	H1	J	L	Kg	
4	G1/8 0531 04 10	7	9	46	52	46	19	17	19	0.082
	G1/4 0531 04 13	9.5	11	46	52	46	21	17	21	0.090
6	G1/4 0531 06 13	9.5	11	55	63	55	25	22	26	0.155
	G3/8 0531 06 17	9.5	12	55	63	55	25	22	27	0.153
10	G1/2 0531 10 21	13	16	62	72	62	34	26	33	0.329

## 0562 Needle Drain Valve, Male BSPP and Metric Thread

Brass

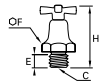

DN	C	E	F	H min	H max	Kg
5	G1/8 0562 05 10	8	16	36	40	0.032
	G1/4 0562 05 13	10	19	38.5	42.5	0.040
	M10x1 0562 05 60	8	16	37.5	40	0.031

## 0563 Needle Drain Valve, BSPT Thread

Brass



DN	C	F	H min	H max	Kg
5	R1/4 0563 05 14	14	28.5	32.5	0.021

## 0627 Automatic Vent Pressure Gauge Valve, Female BSPP Thread

Nickel-plated brass, NBR

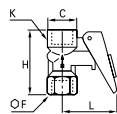

C	F	H	K	L	Kg
G1/4 0627 00 13	19	43.5	20	40	0.097

Pressure: 10 bar

This isolating valve is used to connect a pressure gauge to a circuit.

Resetting the lever isolates and vents the gauge.

A locking pin can be used to enable the gauge to be fitted permanently.

## 0630 Pressure Relief Valve, Male BSPP Thread

Brass

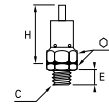

C	E	F	H	Kg
G1/4 0630 06 13	9	17	42.5	0.050

This valve is delivered without calibration, but can be adjusted by inserting metal washers into the hexagon (F).

Maximum working pressure: 10 bar

Calibration from 1 to 10 bar (not below)

## 0591 Needle Valve, Female BSPP Thread

Stainless steel 316L, PTFE

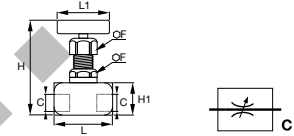

DN	C	F	H min	H max	H1	L	L1	Kg
3	G1/8 0591 03 10	22	90	99	90	25	45	0.342
4	G1/4 0591 04 13	22	90	99	90	25	50	0.354
5	G3/8 0591 05 17	22	90	104	90	30	56	0.430
6	G1/2 0591 06 21	22	90	104	90	30	62	0.478