

# Stainless Steel Adaptors

## 1844 Equal Stud Elbow, Male BSPT/Female BSPP Thread

Stainless steel 316L

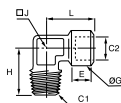

C1	C2		E	G	H	J	L	Kg
R1/8	G1/8	<b>1844 10 10</b>	7.5	15	20.5	10	22.5	0.022
R1/4	G1/4	<b>1844 13 13</b>	12	18.5	27.5	12	26.5	0.045
R3/8	G3/8	<b>1844 17 17</b>	12	23.5	28	14	30	0.070
R1/2	G1/2	<b>1844 21 21</b>	15	28	38	18	38	0.120
R3/4	G3/4	<b>1844 27 27</b>	16.5	33	41	22	44.5	0.160
R1	G1	<b>1844 34 34</b>	19	40	48	32	50	0.311

## 1843 Equal Elbow, Female BSPP Thread

Stainless steel 316L

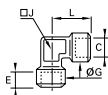

C		E	G	J	L	Kg
G1/8	<b>1843 10 10</b>	7.5	17.5	12	22.5	0.041
G1/4	<b>1843 13 13</b>	11	18.5	15	26.5	0.053
G3/8	<b>1843 17 17</b>	11.5	23.5	18	29	0.075
G1/2	<b>1843 21 21</b>	15	28	23	38	0.158
G3/4	<b>1843 27 27</b>	16.5	33	22	43.5	0.209
G1	<b>1843 34 34</b>	19	40	32	52	0.465

## 1845 Equal Tee, Female BSPP Thread

Stainless steel 316L

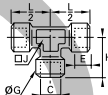

C		E	G	H	J	L/2	Kg
G1/8	<b>1845 10 10</b>	7.5	17.5	22.5	12	22.5	0.057
G1/4	<b>1845 13 13</b>	11	18.5	26.5	15	26.5	0.074
G3/8	<b>1845 17 17</b>	11.5	23.5	29	18	29	0.103
G1/2	<b>1845 21 21</b>	15	28	38	23	38	0.217
G3/4	<b>1845 27 27</b>	16.5	33	43.5	22	43.5	0.301
G1	<b>1845 34 34</b>	19	40	50	32	50	0.447

## 1817 Equal Bulkhead Adaptor, Female BSPP Thread

Stainless steel 316L

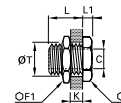

C		F	F1	K max	L	L1	ØT min	Kg
G1/8	<b>1817 00 10</b>	19	22	9	14	4	16.5	0.031
G1/4	<b>1817 00 13</b>	24	27	15	21	4	20.5	0.053
G3/8	<b>1817 00 17</b>	30	32	14	21	5	26.5	0.089
G1/2	<b>1817 00 21</b>	32	36	20	27	6	28.5	0.108
G3/4	<b>1817 00 27</b>	41	41	22.5	30	6	34.5	0.152
G1	<b>1817 00 34</b>	46	50	24.5	34	8	42.5	0.253

## 1871 Equal Bulkhead Adaptor, Female NPT Thread

Stainless steel 316L

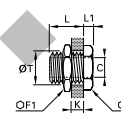

C		F	F1	K max	L	L1	ØT min	Kg
NPT1/8	<b>1871 00 11</b>	19	22	9	14	5	16.5	0.031
NPT1/4	<b>1871 00 14</b>	24	22	9	14	5	20.5	0.060
NPT3/8	<b>1871 00 18</b>	30	32	18	23	5	26.5	0.096
NPT1/2	<b>1871 00 22</b>	32	36	22	29	6	28.5	0.119

## 1855 Equal Connector, Female BSPP Thread

Stainless steel 316L



C		F	L	Kg
G1/8	<b>1855 10 10</b>	14	17	0.013
G1/4	<b>1855 13 13</b>	17	24	0.024
G3/8	<b>1855 17 17</b>	22	25	0.042
G1/2	<b>1855 21 21</b>	27	32	0.077
G3/4	<b>1855 27 27</b>	14	35	0.102
G1	<b>1855 34 34</b>	41	40	0.202

## 1870 Equal Connector, Female NPT Thread

Stainless steel 316L



C		F	L	Kg
NPT1/8	<b>1870 11 11</b>	14	19	0.015
NPT1/4	<b>1870 14 14</b>	17	28	0.029
NPT3/8	<b>1870 18 18</b>	22	28	0.050
NPT1/2	<b>1870 22 22</b>	27	35	0.092

# Stainless Steel Adaptors

## 1862 Reducer Connector, Female BSPP Thread

Stainless steel 316L

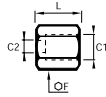

C1	C2		F	L	Kg
G1/4	G1/8	<b>1862 13 10</b>	17	20.5	0.024
G3/8	G1/8	<b>1862 17 10</b>	22	21	0.043
	G1/4	<b>1862 17 13</b>	22	24.5	0.048
G1/2	G1/4	<b>1862 21 13</b>	27	28.5	0.086
	G3/8	<b>1862 21 17</b>	27	29	0.081
G3/4	G1/2	<b>1862 27 21</b>	32	39.5	0.148
G1	G3/4	<b>1862 34 27</b>	41	45	0.282

## 1863 Reducer, Male BSPT/Female BSPP Thread

Stainless steel 316L



C1	C2		F	L	Kg
R1/4	G1/8	<b>1863 13 10</b>	14	16	0.008
R3/8	G1/8	<b>1863 17 10</b>	17	16.5	0.019
	G1/4	<b>1863 17 13</b>	17	16.5	0.011
R1/2	G1/4	<b>1863 21 13</b>	22	21	0.035
	G3/8	<b>1863 21 17</b>	22	21	0.023
R3/4	G1/2	<b>1863 27 21</b>	27	25.5	0.045
R1	G3/4	<b>1863 34 27</b>	36	28.5	0.084

## 1864 Adaptor, Male NPT/Female BSPP Thread

Stainless steel 316L

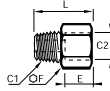

C1	C2		E	F	L	Kg
NPT1/8	G1/8	<b>1864 11 10</b>	7.5	14	21.5	0.015
NPT1/4	G1/4	<b>1864 14 13</b>	11	17	30	0.028
NPT3/8	G3/8	<b>1864 18 17</b>	11.5	22	31	0.044
NPT1/2	G1/2	<b>1864 22 21</b>	15	27	39.5	0.081

## 1872 Reducer, Male/Female NPT Thread

Stainless steel 316L



C1	C2		F	L	Kg
NPT1/4	NPT1/8	<b>1872 14 11</b>	14	16	0.010
NPT3/8	NPT1/8	<b>1872 18 11</b>	19	16.5	0.023
NPT3/8	NPT1/4	<b>1872 18 14</b>	19	16.5	0.016
NPT1/2	NPT1/4	<b>1872 22 14</b>	22	21	0.039
NPT1/2	NPT3/8	<b>1872 22 18</b>	22	21	0.027

## 1867 Adaptor, Male BSPT/Female NPT Thread

Stainless steel 316L

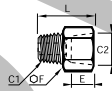

C1	C2		E	F	L	Kg
R1/8	NPT1/8	<b>1867 10 11</b>	8	14	21	0.015
R1/4	NPT1/4	<b>1867 13 14</b>	11.5	17	28.5	0.028
R3/8	NPT3/8	<b>1867 17 18</b>	12	22	29.5	0.045
R1/2	NPT1/2	<b>1867 21 22</b>	15.5	27	37.5	0.082

## 1861 Increaser, Male BSPT/Female BSPP Thread

Stainless steel 316L

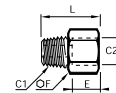

C1	C2		E	F	L	Kg
R1/8	G1/4	<b>1861 10 13</b>	11	17	24	0.022
R1/8	G3/8	<b>1861 10 17</b>	11.5	22	25	0.038
R1/4	G3/8	<b>1861 13 17</b>	11.5	22	28.5	0.042
R1/4	G1/2	<b>1861 13 21</b>	15	27	32.5	0.069
R3/8	G1/2	<b>1861 17 21</b>	15	27	33	0.069
R1/2	G3/4	<b>1861 21 27</b>	16.5	32	38	0.093
R3/4	G1	<b>1861 27 34</b>	19	41	43.5	0.181

# Stainless Steel Adaptors

## 1873 Increaser, Male/Female NPT Thread

Stainless steel 316L

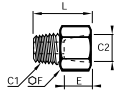

C1	C2		E	F	L	Kg
NPT1/8	NPT1/4	<b>1873 11 14</b>	14	17	25	0.024
	NPT3/8	<b>1873 11 18</b>	14	22	25	0.039
NPT1/4	NPT3/8	<b>1873 14 18</b>	14	22	28.5	0.043
	NPT1/2	<b>1873 14 22</b>	17.5	27	31	0.066
NPT3/8	NPT1/2	<b>1873 18 22</b>	17.5	27	31.5	0.066

## 1821 Equal and Unequal Adaptor, Male BSPT Thread

Stainless steel 316L



C1	C2		F	L	Kg
R1/8	R1/8	<b>1821 10 10</b>	12	19	0.009
	R1/8	<b>1821 13 10</b>	14	23.5	0.015
R1/4	R1/4	<b>1821 13 13</b>	14	27	0.019
	R1/4	<b>1821 17 13</b>	17	27.5	0.023
R3/8	R3/8	<b>1821 17 17</b>	17	28	0.024
	R3/8	<b>1821 21 17</b>	22	32.5	0.042
R1/2	R1/2	<b>1821 21 21</b>	22	36	0.049
	R1/2	<b>1821 27 21</b>	27	41	0.079
R3/4	R3/4	<b>1821 27 27</b>	27	42	0.088
	R3/4	<b>1821 34 27</b>	36	46	0.141
R1	R1	<b>1821 34 34</b>	36	48	0.147

## 1821 Equal Adaptor, Male NPT Thread

Stainless steel 316L



C		F	L	Kg
NPT1/8	<b>1821 11 11</b>	12	23	0.011
NPT1/4	<b>1821 14 14</b>	14	32	0.023
NPT3/8	<b>1821 18 18</b>	19	33	0.031
NPT1/2	<b>1821 22 22</b>	22	42	0.056
NPT3/4	<b>1821 28 28</b>	27	40	0.083

## 1823 Tailpipe Adaptor for Rubber Hose, Male BSPT Thread

Stainless steel 316L

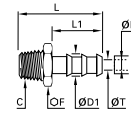

ØD	ØD1	C		F	L	L1	ØT	Kg
7	9	R1/8	<b>1823 07 10</b>	10	34	22.5	5	0.009
	9	R1/4	<b>1823 07 13</b>	14	38.5	22.5	6	0.017
10	12.2	R1/4	<b>1823 10 13</b>	14	38.5	22.5	7	0.018
	12.2	R3/8	<b>1823 10 17</b>	17	39	22.5	9.5	0.021
13	15	R3/8	<b>1823 13 17</b>	17	46	29.5	11	0.025
16	18.5	R1/2	<b>1823 16 21</b>	22	59	38	14	0.048

## 1823 Tailpipe Adaptor for Rubber Hose, Male NPT Thread

Stainless steel 316L

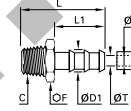

ØD	ØD1	C		F	L	L1	ØT	Kg
1/4	8.3	NPT1/8	<b>1823 56 11</b>	12	34	22.5	5.3	0.010
	8.3	NPT1/4	<b>1823 56 14</b>	14	38.5	22.5	5.3	0.016
3/8	11.7	NPT1/4	<b>1823 60 14</b>	14	38.5	22.5	8.5	0.018
	11.7	NPT3/8	<b>1823 60 18</b>	19	39	22.5	8.5	0.026