

# Nickel-Plated Brass Adaptors

## 0912 Equal Stud Elbow, Female BSPP and Metric Thread

Nickel-plated brass

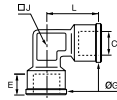

C		E	G	J	L	Kg
M5x0.8	<b>0912 00 19</b>	4	8	9	11	0.007
G1/8	<b>0912 00 10</b>	8	13	10	18.5	0.015
G1/4	<b>0912 00 13</b>	11.5	17	12	22.5	0.029
G3/8	<b>0912 00 17</b>	11.5	21	15	25.5	0.043
G1/2	<b>0912 00 21</b>	14	26	19	30	0.073
G3/4	<b>0912 00 27</b>	16.5	32	22	35.5	0.106
G1	<b>0912 00 34</b>	18	38.5	28	40.5	0.165

## 0921 Equal Stud Elbow, Male/Female and Metric Thread

Nickel-plated brass

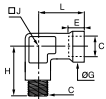

C		E	G	H	J	L	Kg
M5x0.8	<b>0921 00 19</b>	4	8	11.5	9	11	0.007

## 0913 Equal Stud Elbow, Male BSPT/ Female BSPP Thread

Nickel-plated brass

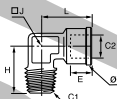

C1	C2		E	G	H	J	L	Kg
R1/8	G1/8	<b>0913 00 10</b>	8	13	17	10	18.5	0.012
R1/4	G1/4	<b>0913 00 13</b>	11.5	17	22.5	12	22.5	0.025
R3/8	G3/8	<b>0913 00 17</b>	11.5	21	25.5	15	25.5	0.040
R1/2	G1/2	<b>0913 00 21</b>	14	26	30	19	30	0.064
R3/4	G3/4	<b>0913 00 27</b>	16.5	32	34.5	22	35.5	0.098
R1	G1	<b>0913 00 34</b>	18	38.5	40.5	28	40.5	0.162

## 0914 Equal Stud Elbow, Male BSPT Thread

Nickel-plated brass



C		H	J	L	Kg
R1/8	<b>0914 00 10</b>	17	10	17	0.010
R1/4	<b>0914 00 13</b>	22.5	12	22.5	0.022
R3/8	<b>0914 00 17</b>	25.5	15	25.5	0.034
R1/2	<b>0914 00 21</b>	30	19	30	0.057
R3/4	<b>0914 00 27</b>	34.5	22	34.5	0.093
R1	<b>0914 00 34</b>	40.5	28	40.5	0.157

## 0910 Equal Y, Female BSPP Thread

Nickel-plated brass

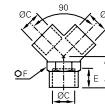

C		E	F	H	Kg
G1/8	<b>0910 00 10</b>	8	13	12	0.019
G1/4	<b>0910 00 13</b>	11	17	14	0.033
G3/8	<b>0910 00 17</b>	11.5	20	16	0.046
G1/2	<b>0910 00 21</b>	14	25	19	0.085

## 0911 Equal Y, Male BSPT/Female BSPP Thread

Nickel-plated brass

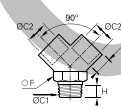

C1	C2		E	F	H	Kg
R1/8	G1/8	<b>0911 00 10</b>	8	13	8	0.022
R1/4	G1/4	<b>0911 00 13</b>	11	17	11	0.038
R3/8	G3/8	<b>0911 00 17</b>	11.5	20	11.5	0.051
R1/2	G1/2	<b>0911 00 21</b>	14	25	14	0.105

## 0915 Equal Tee, Female BSPP and Metric Thread

Nickel-plated brass

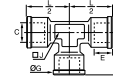

C		E	G	H	J	L/2	Kg
M5x0.8	<b>0915 00 19</b>	5	8	11	9	11	0.010
G1/8	<b>0915 00 10</b>	8	13	18.5	10	18.5	0.021
G1/4	<b>0915 00 13</b>	11	17	22.5	12	22.5	0.042
G3/8	<b>0915 00 17</b>	11.5	21	25.5	15	25.5	0.062
G1/2	<b>0915 00 21</b>	14	26	30	19	30	0.097
G3/4	<b>0915 00 27</b>	16.5	32	35.5	22	35.5	0.145
G1	<b>0915 00 34</b>	18	38.5	40.5	28	40.5	0.238

## 0916 Equal Stud Branch Tee, Male BSPT/Female BSPP Thread

Nickel-plated brass

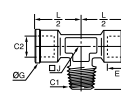

C1	C2		E	G	H	J	L/2	Kg
R1/8	G1/8	<b>0916 00 10</b>	8	13	17	10	18	0.019
R1/4	G1/4	<b>0916 00 13</b>	11	17	22.5	12	22.5	0.038
R3/8	G3/8	<b>0916 00 17</b>	11.5	21	25.5	15	25.5	0.058
R1/2	G1/2	<b>0916 00 21</b>	14	26	30	19	30	0.091
R3/4	G3/4	<b>0916 00 27</b>	16.5	32	34.5	22	35	0.139

# Nickel-Plated Brass Adaptors

## 0917 Equal Stud Run Tee, Female BSPP/Male BSPT Thread

Nickel-plated brass

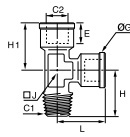

C1	C2		E	G	H	H1	J	L	Kg
R1/8	G1/8	<b>0917 00 10</b>	8	13	17	18.5	10	18.5	0.019
R1/4	G1/4	<b>0917 00 13</b>	11	17	22.5	22.5	12	22.5	0.038
R3/8	G3/8	<b>0917 00 17</b>	11.5	21	25.5	25.5	15	25.5	0.058
R1/2	G1/2	<b>0917 00 21</b>	14	26	30	30	19	30	0.089
R3/4	G3/4	<b>0917 00 27</b>	16.5	32	34.5	35.5	22	35.5	0.136

## 0927 Equal Tee, Male BSPT Thread

Nickel-plated brass

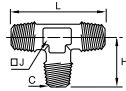

C			H	J	L	Kg
R1/8	<b>0927 00 10</b>		17	10	34	0.013
R1/4	<b>0927 00 13</b>		22.5	12	45	0.032
R3/8	<b>0927 00 17</b>		25.5	15	51	0.056
R1/2	<b>0927 00 21</b>		30	19	60	0.079
R3/4	<b>0927 00 27</b>		34.5	22	69	0.130

## 0928 Equal Stud Branch Tee, Male BSPT/ Female BSPP Thread

Nickel-plated brass

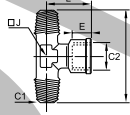

C1	C2		E	H	J	L	Kg
R1/8	G1/8	<b>0928 00 10</b>	8	34	10	18.5	0.016
R1/4	G1/4	<b>0928 00 13</b>	11	45	12	22.5	0.035
R3/8	G3/8	<b>0928 00 17</b>	11.5	51	15	25.5	0.053
R1/2	G1/2	<b>0928 00 21</b>	14	60	19	30	0.086
R3/4	G3/4	<b>0928 00 27</b>	16.5	69	22	35.5	0.236

## 0932 Equal Stud Run Tee, Male BSPT/Female BSPP Thread

Nickel-plated brass

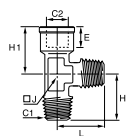

C1	C2		E	H	H1	J	L	Kg
R1/8	G1/8	<b>0932 00 10</b>	8	17	18.5	10	17	0.016
R1/4	G1/4	<b>0932 00 13</b>	11	22.5	22.5	12	22.5	0.035
R3/8	G3/8	<b>0932 00 17</b>	11.5	25.5	25.5	15	25.5	0.053
R1/2	G1/2	<b>0932 00 21</b>	14	30	30	19	30	0.091
R3/4	G3/4	<b>0932 00 27</b>	16.5	34.5	35.5	22	34.5	0.080

## 0908 Equal Cross, Female BSPP Thread

Nickel-plated brass

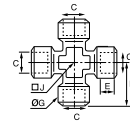

C			E	G	H	J	Kg
G1/8	<b>0908 00 10</b>		8	13	21	10	0.038
G1/4	<b>0908 00 13</b>		11	17	25.5	13	0.074
G3/8	<b>0908 00 17</b>		11.5	21	28	17	0.109
G1/2	<b>0908 00 21</b>		14	26	33.5	21	0.186

## 0909 Equal Cross, Male BSPT/Female BSPP Thread

Nickel-plated brass

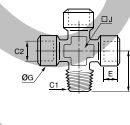

C1	C2		E	G	H	J	Kg
R1/8	G1/8	<b>0909 00 10</b>	8	13	18.5	10	0.034
R1/4	G1/4	<b>0909 00 13</b>	11	17	23.5	13	0.069
R3/8	G3/8	<b>0909 00 17</b>	11.5	21	26	17	0.098
R1/2	G1/2	<b>0909 00 21</b>	14	26	31	21	0.168

## 0178 Reducer, Male/Female BSPP and Metric Thread

Nickel-plated brass, NBR

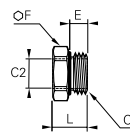

C1	C2		E	F	L	Kg
M7x1	M5x0.8	<b>0178 55 19</b>	5	10	12	0.005
G1/8	M5x0.8	<b>0178 10 19</b>	5	13	9	0.005
G1/4	G1/8	<b>0178 13 10</b>	5.5	16	9.5	0.006
G3/8	G1/8	<b>0178 17 10</b>	5.5	20	10.5	0.016
G3/8	G1/4	<b>0178 17 13</b>	5.5	20	10.5	0.011
G1/2	G1/4	<b>0178 21 13</b>	7.5	24	12.5	0.024
G1/2	G3/8	<b>0178 21 17</b>	7.5	24	12.5	0.016
G3/4	G1/2	<b>0178 27 21</b>	7.5	32	13.5	0.035

With integrated O-ring seal

## 0903 Reducer, Male/Female BSPP Thread

Nickel-plated brass

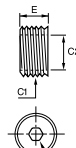

C1	C2		E	F	Kg
G1/4	G1/8	<b>0903 10 13</b>	8	6	0.004
G3/8	G1/4	<b>0903 13 17</b>	9	8	0.007
G1/2	G3/8	<b>0903 17 21</b>	10	10	0.011
G3/4	G1/2	<b>0903 21 27</b>	14	12	0.023
G1	G3/4	<b>0903 27 34</b>	20	17	0.038

# Nickel-Plated Brass Adaptors

## 0904 Reducer, Male BSPT/Female BSPP Thread

Nickel-plated brass



C1	C2		F	L	Kg
R1/4	G1/8	<b>0904 10 13</b>	14	16	0.010
R3/8	G1/8	<b>0904 10 17</b>	17	16.5	0.020
R1/2	G1/8	<b>0904 10 21</b>	22	19.5	0.035
R3/8	G1/4	<b>0904 13 17</b>	17	16.5	0.015
R1/2	G1/4	<b>0904 13 21</b>	22	19.5	0.031
R1/2	G3/8	<b>0904 17 21</b>	22	19.5	0.024
R3/4	G3/8	<b>0904 17 27</b>	27	23	0.056
R3/4	G1/2	<b>0904 21 27</b>	27	23	0.045
R1	G1/2	<b>0904 21 34</b>	34	27	0.101
R1	G3/4	<b>0904 27 34</b>	34	27	0.074

## 0905 Reducer, Male BSPP/Female BSPP and Metric Thread

Nickel-plated brass

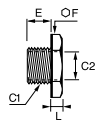

C1	C2		E	F	L	Kg
G1/8	M5x0.8	<b>0905 19 10</b>	6	14	4.5	0.008
G1/4	G1/8	<b>0905 10 13</b>	8	17	5	0.011
	G1/8	<b>0905 10 17</b>	9	19	5	0.019
G3/8	G1/4	<b>0905 13 17</b>	9	19	5	0.013
	G1/4	<b>0905 13 21</b>	10	24	5.5	0.031
G1/2	G3/8	<b>0905 17 21</b>	10	24	5.5	0.022
	G3/8	<b>0905 17 27</b>	11	30	6.5	0.055
G3/4	G1/2	<b>0905 21 27</b>	11	30	6.5	0.041

\*Please contact us for detailed drawings of external thread.

## 0906 Increaser, Male BSPP and Metric/Female BSPP Thread

Nickel-plated brass

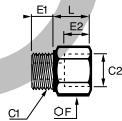

C1	C2		E1	E2	F	L	Kg
M5x0.8	G1/8	<b>0906 10 19</b>	4	8	14	10.5	0.010
	G1/8	<b>0906 00 10</b>	6	8	14	10.5	0.011
G1/8	G1/4	<b>0906 10 13</b>	6	11	17	13.5	0.017
	G3/8	<b>0906 10 17</b>	6	11.5	22	14.5	0.029
	G1/4	<b>0906 00 13</b>	8	11	17	13.5	0.019
G1/4	G3/8	<b>0906 13 17</b>	8	11.5	22	14.5	0.032
	G1/2	<b>0906 13 21</b>	8	14	24	18	0.037
	G3/8	<b>0906 00 17</b>	9	11.5	22	14.5	0.035
G3/8	G1/2	<b>0906 17 21</b>	9	14	24	18	0.038
G1/2	G1/2	<b>0906 00 21</b>	10	14	26	20	0.053

## 0933 Increaser, Male BSPT/Female BSPP Thread

Nickel-plated brass

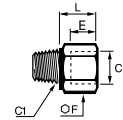

C1	C2		F	L	Kg
R1/8	G1/8	<b>0933 00 10</b>	14	10	0.011
R1/4	G1/4	<b>0933 00 13</b>	17	13.5	0.020
R3/8	G3/8	<b>0933 00 17</b>	22	14.5	0.037
R1/2	G1/2	<b>0933 00 21</b>	26	18	0.058
R1/8	G1/4	<b>0933 10 13</b>	17	13.5	0.017
R1/4	G3/8	<b>0933 13 17</b>	22	14.5	0.034
R1/4	G1/2	<b>0933 13 21</b>	24	18	0.038
R3/8	G1/2	<b>0933 17 21</b>	24	18	0.041
R1/2	G3/4	<b>0933 21 27</b>	32	23.5	0.080

## 0907 Equal Extended Adaptor, Male/Female BSPP Thread

Nickel-plated brass

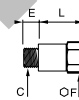

C		E	F	L	Kg
G1/8	<b>0907 00 10</b>	6	14	16	0.015
	<b>0907 00 10 01</b>	6	14	36	0.030
G1/4	<b>0907 00 13</b>	8	17	27	0.031
	<b>0907 00 13 01</b>	8	17	43	0.047

## 0920 Bulkhead Connector, Female BSPP and Metric Thread

Nickel-plated brass

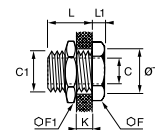

C	C1		F	F1	K max	L	L1	ØT	Kg
M5x0.8	M10x1	<b>0920 00 19</b>	14	14	7	10.5	3.5	10.5	0.012
G1/8	M16x1.5	<b>0920 00 10</b>	19	22	10	14	4	16.5	0.030
G1/4	M20x1.5	<b>0920 00 13</b>	24	27	16	21	4	20.5	0.057
G3/8	M26x1.5	<b>0920 00 17</b>	30	32	15	21	5	26.5	0.096
G1/2	M28x1.5	<b>0920 00 21</b>	32	36	21	27	6	28.5	0.115

# Nickel-Plated Brass Adaptors

## 0900 Equal and Unequal Adaptor, Male BSPT Thread

Nickel-plated brass



C1	C2		F	L	Kg
R1/8	R1/8	<b>0900 00 10</b>	12	20.5	0.009
R1/8	R1/4	<b>0900 10 13</b>	14	24	0.014
	R3/8	<b>0900 10 17</b>	17	24.5	0.020
R1/4	R1/4	<b>0900 00 13</b>	14	27	0.017
	R3/8	<b>0900 13 17</b>	17	27.5	0.026
R3/8	R1/2	<b>0900 13 21</b>	22	30.5	0.046
	R3/8	<b>0900 00 17</b>	17	28	0.025
R1/2	R1/2	<b>0900 00 21</b>	22	33.5	0.042
	R3/4	<b>0900 21 27</b>	27	37	0.084
R3/4	R3/4	<b>0900 00 27</b>	27	39.5	0.079
	R1	<b>0900 27 34</b>	34	42.5	0.145
R1	R1	<b>0900 00 34</b>	34	45.5	0.153

## 0901 Equal and Unequal Adaptor, Male BSPP and Metric Thread

Nickel-plated brass



C1	C2		E	E1	F	L	Kg
M5x0.8	M5x0.8	<b>0901 00 19</b>	4	4	8	11.5	0.002
	G1/8	<b>0901 19 10</b>	4	6	14	14.5	0.008
G1/8	G1/8	<b>0901 00 10</b>	6	6	14	16.5	0.009
	G1/4	<b>0901 10 13</b>	6	8	17	19	0.016
G1/4	G1/4	<b>0901 00 13</b>	8	8	17	21	0.019
	G3/8	<b>0901 13 17</b>	8	9	19	22	0.023
G3/8	G1/2	<b>0901 13 21</b>	8	10	24	23.5	0.036
	G3/8	<b>0901 00 17</b>	9	9	19	23	0.025
G1/2	G1/2	<b>0901 17 21</b>	9	10	24	24.5	0.038
	G1/2	<b>0901 00 21</b>	10	10	24	25.5	0.040

## 0192 Unequal Straight Adaptor, Male BSPT/BSPP Thread

Nickel-plated brass



C1	C2		E	F	L	Kg
R1/8	G1/4	<b>0192 10 13</b>	9.5	17	23.5	0.019
R1/4	G1/4	<b>0192 13 13</b>	9.5	17	27.5	0.024
R1/4	G1/2	<b>0192 13 21</b>	11	27	31.5	0.066
R3/8	G1/4	<b>0192 17 13</b>	9.5	17	28	0.025
R3/8	G1/2	<b>0192 17 21</b>	11	27	31.5	0.060
R1/2	G1/2	<b>0192 21 21</b>	11	27	34	0.061

## 0191 Tailpiece Adaptor for Rubber Hose, Male BSPP Thread

Nickel-plated brass

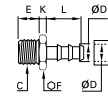

ØD	ØD1	C		E	F	K	L	Kg
4	6	G1/4	<b>0191 04 13</b>	9.5	17	5	22.5	0.019
7	9	G1/4	<b>0191 07 13</b>	9.5	17	5	22.5	0.022
	9	G1/2	<b>0191 07 21</b>	11	27	7	29.5	0.058
10	12.2	G1/4	<b>0191 10 13</b>	9.5	17	5	22.5	0.020
	12.2	G1/2	<b>0191 10 21</b>	11	27	7	29.5	0.060
13	15.2	G1/4	<b>0191 13 13</b>	9.5	17	5	22.5	0.022
	15.2	G1/2	<b>0191 13 21</b>	11	27	7	29.5	0.059
16	18.5	G1/2	<b>0191 16 21</b>	11	27	7	36.5	0.067

## 0931 Tailpiece Adaptor for Rubber Hose, Male BSPP Thread

Nickel-plated brass

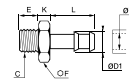

ØD	ØD1	C		E	F	K	L	Kg
6	7	G1/8	<b>0931 06 10</b>	6	12	4.5	19	0.009
	7	G1/4	<b>0931 06 13</b>	8	14	5	19	0.013
7	8	G1/8	<b>0931 07 10</b>	6	12	4	19	0.009
	8	G1/4	<b>0931 07 13</b>	8	14	5	19	0.014
8	8	G3/8	<b>0931 07 17</b>	9	19	5	19	0.021
	9	G1/8	<b>0931 08 10</b>	6	12	4	19	0.009
10	9	G1/4	<b>0931 08 13</b>	8	14	5	19	0.014
	9	G3/8	<b>0931 08 17</b>	9	19	5	19	0.022
15	12	G1/4	<b>0931 10 13</b>	8	14	5	19	0.016
	12	G3/8	<b>0931 10 17</b>	9	19	5	19	0.024
18	12	G1/2	<b>0931 10 21</b>	10	22	6	20	0.031
	17	G3/8	<b>0931 15 17</b>	9	19	6	24	0.030
18	17	G1/2	<b>0931 15 21</b>	10	22	6	24	0.036
	20	G1/2	<b>0931 18 21</b>	10	22	6	24	0.040

# Nickel-Plated Brass Adaptors

## 0934 Tailpiece Adaptor for Polymer Tubing, Male BSPT Thread

Nickel-plated brass

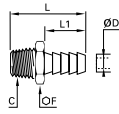

ØD	C		F	L	L1	Kg
6	R1/8	<b>0934 06 10</b>	12	31.5	19	0.009
	R1/4	<b>0934 06 13</b>	14	35	19	0.014
7	R1/8	<b>0934 07 10</b>	12	31.5	19	0.009
	R1/4	<b>0934 07 13</b>	14	35	19	0.014
8	R1/8	<b>0934 08 10</b>	12	31.5	19	0.010
	R1/4	<b>0934 08 13</b>	14	35	19	0.015
9	R1/4	<b>0934 09 13</b>	14	35	19	0.015
	R3/8	<b>0934 09 17</b>	17	35.5	19	0.021
10	R1/2	<b>0934 09 21</b>	22	38.5	19	0.032
	R1/8	<b>0934 10 10</b>	12	32.5	20	0.011
10	R1/4	<b>0934 10 13</b>	14	36	20	0.016
	R3/8	<b>0934 10 17</b>	17	36.5	20	0.021
12	R1/2	<b>0934 10 21</b>	22	39.5	20	0.033
	R1/4	<b>0934 12 13</b>	14	36	20	0.016
12	R3/8	<b>0934 12 17</b>	17	36.5	20	0.021
	R1/2	<b>0934 12 21</b>	22	39.5	20	0.033
14	R3/8	<b>0934 14 17</b>	17	38.5	22	0.025
	R1/2	<b>0934 14 21</b>	22	41.5	22	0.036
16	R3/8	<b>0934 16 17</b>	17	38.5	22	0.026
	R1/2	<b>0934 16 21</b>	22	41.5	22	0.037
17	R3/4	<b>0934 16 27</b>	27	45	22	0.055
	R1/2	<b>0934 17 21</b>	22	43.5	24	0.041
18	R3/8	<b>0934 18 17</b>	19	40.5	24	0.035
	R1/2	<b>0934 18 21</b>	22	43.5	24	0.044
20	R3/4	<b>0934 18 27</b>	27	47	24	0.064
	R1/2	<b>0934 20 21</b>	22	43.5	24	0.041

## 0902 Equal and Unequal Adaptor, Female BSPP and Metric Thread

Nickel-plated brass

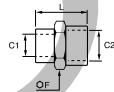

C1	C2		F	L	Kg
M5x0.8	M5x0.8	<b>0902 00 19</b>	8	11	0.003
	G1/8	<b>0902 19 10</b>	14	13.5	0.009
G1/8	G1/8	<b>0902 00 10</b>	14	15	0.010
	G1/4	<b>0902 10 13</b>	17	19	0.017
	G3/8	<b>0902 10 17</b>	22	20	0.028
G1/4	G1/4	<b>0902 00 13</b>	17	22	0.019
	G3/8	<b>0902 13 17</b>	22	22.5	0.031
G3/8	G1/2	<b>0902 13 21</b>	26	24	0.033
	G3/8	<b>0902 00 17</b>	22	23	0.035
G1/2	G1/2	<b>0902 17 21</b>	24	26	0.036
	G1/2	<b>0902 00 21</b>	26	28	0.049
G3/4	G3/4	<b>0902 21 27</b>	32	30	0.078
	G3/4	<b>0902 00 27</b>	32	32	0.076

## 0935 Tailpiece Adaptor for Polymer Tubing, Male BSPP Thread

Nickel-plated brass

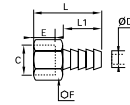

ØD	C		E	F	L	L1	Kg
6	G1/8	<b>0935 06 10</b>	8	12	28.5	19	0.007
8	G1/4	<b>0935 08 13</b>	11	15	31.5	19	0.012
12	G1/2	<b>0935 12 21</b>	14.5	24	36	20	0.033

## 0950MB Maintenance Kit, BSPP Thread

Nickel-plated brass



	H	L	L1	Kg
<b>0950 00 00 02</b>	81	413	330	3.500

A selection of 250 references covering the most-used products  
Other packaging available: Ref 0950 00 00 02x6 per 6 units

## 0950M0 Maintenance Kit, BSPT Thread

Nickel-plated brass



	H	L	L1	Kg
<b>0950 00 00 03</b>	81	413	330	3.500

A selection of 216 references covering the most-used products  
Other packaging available: Ref 0950 00 00 03x6 per 6 units