

Installation Options

The Parker Legris axial valve offers 3 control methods depending on the application:

Pneumatic Control

- available for single or double acting
- local compressed air control
- for repetitive on/off cycles
- remote control where access to the machine is difficult or ATEX areas

Electro-Pneumatic Control

with NAMUR spool valve (3/2 for single acting - 5/2 for double acting)

- available for single or double acting
- for automated industrial systems
- Namur pad-mounting (delivered unassembled)
- robust and compact solution
- better response time than other technologies

Electro-Pneumatic Control

with solenoid valves (3/2)

- recommended for single acting
- for automated industrial systems
- pilot solenoid valve banjo G1/8 normally closed 3/2
- easy to connect
- swivel at 360°

Pneumatic operation



Electro-pneumatic operation

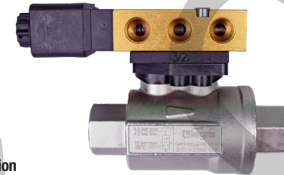

Electro-pneumatic operation



Product Codes

Valve type

Without detection
4202: Normally closed
4212: Normally open
4222: Double acting

With detection
4204: Normally closed
4214: Normally open
4224: Double acting



10 = 10 mm
15 = 15 mm
20 = 20 mm
25 = 25 mm
32 = 32 mm
40 = 40 mm
50 = 50 mm

Pipe Size (inch):

17: Rp3/8"
21: Rp1/2"
27: Rp3/4"
34: Rp1"
42: Rp1 1/4"
49: Rp1 1/2"
48: Rp2"

Seals Material

20: FKM
30: EPDM
(only for NC version)

42 XX 10 YY ZZ

4202/4204..20 Normally Closed Axial Valve with FKM Seal, Female BSPP Thread

Nickel-plated brass, FKM

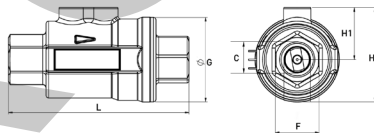

C	Without detection	With detection	F	G	H	H1	L	Kg
Rp3/8	4202 10 17 20	4204 10 17 20	22	46	53.5	30.5	98	0.650
Rp1/2	4202 15 21 20	4204 15 21 20	27	52	59	33	113	0.850
Rp3/4	4202 20 27 20	4204 20 27 20	33	63.5	71	39	136	1.500
Rp1	4202 25 34 20	4204 25 34 20	41	69	76	41.5	144	1.700
Rp1 1/4	4202 32 42 20*	4204 32 42 20*	50	86	91	48	166	3.300
Rp1 1/2	4202 40 49 20*	4204 40 49 20*	60	96	102	54	181	3.600
Rp2	4202 50 48 20*	4204 50 48 20*	70	109	115	60	205	5.100

Pilot port: G1/8
Delivered with a silencer
*Models with EC marking
Threads conformed to ISO 7/1 (Rp)

4202/4204..30 Normally Closed Axial Valve with EPDM seal, Female BSPP Thread

Nickel-plated brass, EPDM

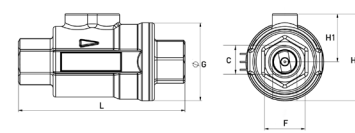

C	Without detection	With detection	F	G	H	H1	L	Kg
Rp3/8	4202 10 17 30	4204 10 17 30	22	46	53.5	30.5	98	0.650
Rp1/2	4202 15 21 30	4204 15 21 30	27	52	59	33	113	0.850
Rp3/4	4202 20 27 30	4204 20 27 30	33	63.5	71	39	136	1.500
Rp1	4202 25 34 30	4204 25 34 30	41	69	76	41.5	144	1.700
Rp1 1/4	4202 32 42 30*	4204 32 42 30*	50	86	91	48	166	3.300
Rp1 1/2	4202 40 49 30*	4204 40 49 30*	60	96	102	54	181	3.600
Rp2	4202 50 48 30*	4204 50 48 30*	70	109	115	60	205	5.100

Pilot port: G1/8
Delivered with a silencer
*Models with EC marking
Threads conformed to ISO 7/1 (Rp)

4212/4214..20 Normally Open Axial Valve with FKM Seal, Female BSPP Thread

Nickel-plated brass, FKM

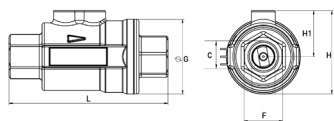

C	Without detection	With detection	F	G	H	H1	L	Kg
Rp3/8	4212 10 17 20	4214 10 17 20	22	46	53.5	30.5	98	0.650
Rp1/2	4212 15 21 20	4214 15 21 20	27	52	59	33	113	0.850
Rp3/4	4212 20 27 20	4214 20 27 20	33	63.5	71	39	136	1.500
Rp1	4212 25 34 20	4214 25 34 20	41	69	76	41.5	144	1.700
Rp1 1/4	4212 32 42 20*	4214 32 42 20*	50	86	91	48	166	3.300
Rp1 1/2	4212 40 49 20*	4214 40 49 20*	60	96	102	54	181	3.600
Rp2	4212 50 48 20*	4214 50 48 20*	70	109	115	60	205	5.100

Pilot port: G1/8

Delivered with a silencer

*Models with EC marking

Threads conformed to ISO 7/1 (Rp)

4222/4224..20 Double-Acting Axial Valve with FKM Seal, Female BSPP Thread

Nickel-plated brass, FKM

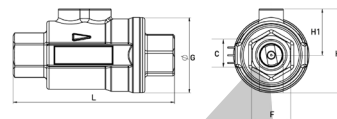

C	Without detection	With detection	F	G	H	H1	L	Kg
Rp3/8	4222 10 17 20	4224 10 17 20	22	46	53.5	30.5	98	0.600
Rp1/2	4222 15 21 20	4224 15 21 20	27	52	59	33	113	0.800
Rp3/4	4222 20 27 20	4224 20 27 20	33	63.5	71	39	136	1.400
Rp1	4222 25 34 20	4224 25 34 20	41	69	76	41.5	144	1.600
Rp1 1/4	4222 32 42 20*	4224 32 42 20*	50	86	91	48	166	3.000
Rp1 1/2	4222 40 49 20*	4224 40 49 20*	60	96	102	54	181	3.300
Rp2	4222 50 48 20*	4224 50 48 20*	70	109	115	60	205	4.800

Pilot port: G1/8

*Models with EC marking

Threads conformed to ISO 7/1 (Rp)

Sub-Base for control with spool valve or solenoid valve with Namur pad mounting

Technical polymer

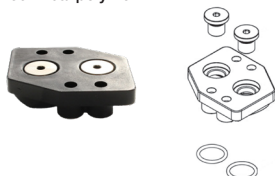

Delivered with the valve, unassembled

4243 Spare parts kit



Kit

4243 00 10 20	Kit for FKM seal DN10
4243 00 10 30	Kit for EPDM seal DN10
4243 00 15 20	Kit for FKM seal DN15
4243 00 15 30	Kit for EPDM seal DN15
4243 00 20 20	Kit for FKM seal DN20
4243 00 20 30	Kit for EPDM seal DN20
4243 00 25 20	Kit for FKM seal DN25
4243 00 25 30	Kit for EPDM seal DN25
4243 00 32 20	Kit for FKM seal DN32
4243 00 32 30	Kit for EPDM seal DN32
4243 00 40 20	Kit for FKM seal DN40
4243 00 40 30	Kit for EPDM seal DN40
4243 00 50 20	Kit for FKM seal DN50
4243 00 50 30	Kit for EPDM seal DN50

4298 00 02 Limit Switch

Nickel-plated brass, FKM



The valve is delivered with a magnet in the piston (assembled during the production) and supplied with a slot for mounting the limit switch(es). We provide separately inductive limit switch with LED which can be easily mounted in the slot and fixed with their screws.

- REED PNP, LED
- 3 wires (2 meters)
- Operating voltage 5-50 AC/DC
- Permanent current rating of switching output AC = 350 mA ; DC = 500 mA
- IP67, CE, UKCA, UL, EAC, CCC

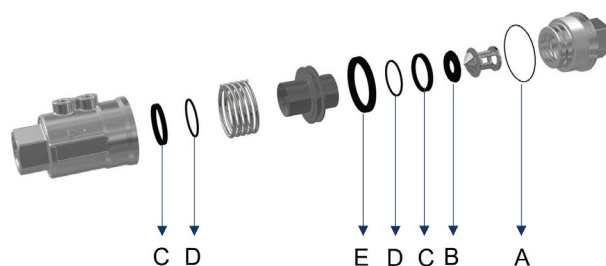

- A = Body seal
- B = Piston seal
- C = Lip seals
- D = Stem seals
- E = Piston seal

Complementary Range Products

Namur Pilot Spool Valve

Parker Series 331 3/2
Parker Series 341 5/2



Pilot Solenoid Valve G1/8" 3/2

Parker Series 131

