

0143 Equal Threaded Elbow, Female BSPP Thread

Brass

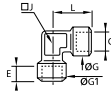

| C | E | G | J | L | Kg |
|------------------------|------|------|----|------|-------|
| G1/8 0143 10 10 | 7.5 | 16.5 | 12 | 22.5 | 0.043 |
| G1/4 0143 13 13 | 11 | 18.5 | 15 | 26.5 | 0.056 |
| G3/8 0143 17 17 | 11.5 | 23.5 | 19 | 31.5 | 0.102 |
| G1/2 0143 21 21 | 15 | 28 | 23 | 34.5 | 0.150 |
| G3/4 0143 27 27 | 16.5 | 34 | 27 | 43.5 | 0.248 |

0144 Equal Stud Elbow, Male BSPT/Female BSPP Thread

Brass

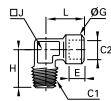

| C1 | C2 | E | G | H | J | L | Kg | |
|------|------|-------------------|------|------|----|----|------|-------|
| R1/8 | G1/8 | 0144 10 10 | 7.5 | 16.5 | 23 | 12 | 22.5 | 0.036 |
| R1/4 | G1/4 | 0144 13 13 | 11 | 18.5 | 26 | 15 | 26.5 | 0.056 |
| R3/8 | G3/8 | 0144 17 17 | 11.5 | 23.5 | 30 | 19 | 31.5 | 0.086 |
| R1/2 | G1/2 | 0144 21 21 | 15 | 28 | 35 | 23 | 34.5 | 0.139 |
| R3/4 | G3/4 | 0144 27 27 | 16.5 | 34 | 40 | 27 | 43.5 | 0.227 |

0152 Equal Elbow, Male BSPT Thread

Brass

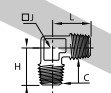

| C | H | J | L | Kg |
|------------------------|------|----|------|-------|
| R1/8 0152 10 10 | 19.5 | 10 | 19.5 | 0.018 |
| R1/4 0152 13 13 | 25 | 15 | 25 | 0.047 |
| R3/8 0152 17 17 | 26.5 | 15 | 26.5 | 0.054 |
| R1/2 0152 21 21 | 31.5 | 19 | 31.5 | 0.089 |
| R3/4 0152 27 27 | 35.5 | 23 | 35.5 | 0.153 |

0145 Equal Tee, Female BSPP Thread

Brass

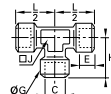

| C | E | G | H | J | L/2 | Kg |
|------------------------|------|------|------|----|------|-------|
| G1/8 0145 10 10 | 7.5 | 16.5 | 22.5 | 12 | 22.5 | 0.057 |
| G1/4 0145 13 13 | 11 | 18.5 | 26.5 | 15 | 26.5 | 0.078 |
| G3/8 0145 17 17 | 11.5 | 23.5 | 31 | 19 | 31 | 0.126 |
| G1/2 0145 21 21 | 15 | 28 | 38 | 23 | 38 | 0.244 |
| G3/4 0145 27 27 | 16.5 | 34 | 47.5 | 27 | 47.5 | 0.370 |

MR0434 Stud Run Tee, Female BSPP/Male BSPT Thread

Brass

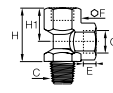

| C | C1 | E | F | H | H1 | Kg | |
|------|------|-------------------|----|----|----|----|-------|
| R1/8 | G1/8 | 1/8MR0434B | 8 | 14 | 32 | 15 | 0.029 |
| R1/4 | G1/4 | 1/4MR0434B | 10 | 17 | 40 | 18 | 0.050 |
| R1/2 | G1/2 | 1/2MR0434B | 14 | 30 | 63 | 31 | 0.254 |

0158 Stud Branch Tee, Male BSPT/Female BSPP Thread

Brass

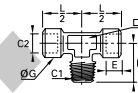

| C1 | C2 | E | G | H | J | L/2 | Kg | |
|------|------|-------------------|------|------|------|-----|------|-------|
| R1/8 | G1/8 | 0158 10 10 | 7.5 | 16.5 | 21.5 | 12 | 21.5 | 0.048 |
| R1/4 | G1/4 | 0158 13 13 | 11 | 18.5 | 26 | 15 | 26 | 0.072 |
| R3/8 | G3/8 | 0158 17 17 | 11.5 | 23.5 | 30 | 19 | 30 | 0.120 |
| R1/2 | G1/2 | 0158 21 21 | 15 | 28 | 36 | 23 | 36 | 0.205 |
| R3/4 | G3/4 | 0158 27 27 | 16.5 | 34 | 44 | 27 | 44 | 0.310 |

0117 Equal Bulkhead Coupling, Female BSPP and Metric Thread

Brass

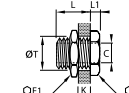

| C | F | F1 | K max | L | L1 | ØT | ØF1 | Kg |
|--------------------------|----|----|-------|------|-----|------|-------|----|
| M5x0.8 0117 00 19 | 14 | 14 | 7 | 10.5 | 3.5 | 10.5 | 0.012 | |
| G1/8 0117 00 10 | 19 | 22 | 9 | 14 | 4 | 16.5 | 0.032 | |
| G1/4 0117 00 13 | 24 | 24 | 15 | 21 | 4 | 20.5 | 0.056 | |
| G3/8 0117 00 17 | 30 | 32 | 14 | 21 | 5 | 26.5 | 0.096 | |
| G1/2 0117 00 21 | 32 | 36 | 20 | 27 | 6 | 28.5 | 0.115 | |
| G3/4 0117 00 27 | 41 | 41 | 22.5 | 30 | 6 | 34.5 | 0.161 | |
| G1 0117 00 34 | 46 | 50 | 24.5 | 34 | 8 | 42.5 | 0.269 | |
| G1 1/4 0117 00 42 | 55 | 55 | 29.5 | 39 | 8 | 49.5 | 0.295 | |
| G1 1/2 0117 00 49 | 60 | 60 | 29.5 | 39 | 8 | 54.5 | 0.303 | |

Delivered with not assembled nuts

207ACBH Bulkhead Union, Female NPTF Thread

Brass

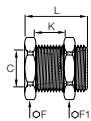

| C | | F | F1 | K | L | Kg |
|---------|------------------|-----|------|----|----|-------|
| NPTF1/8 | 207ACBH-2 | 78 | 1516 | 20 | 38 | 0.072 |
| NPTF1/4 | 207ACBH-4 | 1 | 1.2 | 18 | 38 | 0.099 |
| NPTF3/8 | 207ACBH-6 | 1.2 | 1.1 | 13 | 34 | 0.127 |
| NPTF1/2 | 207ACBH-8 | 1.1 | 1.4 | 16 | 38 | 0.155 |

*F and F1 in Inch dimensions

0155 Equal Connector, Female BSPP Thread

Brass

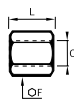

| C | C1 | F | L | Kg |
|------|------------------------|----|----|-------|
| G1/8 | 0155 10 10 | 14 | 17 | 0.014 |
| G1/4 | G1/8 0155 10 13 | 17 | 18 | 0.022 |
| G1/4 | 0155 13 13 | 17 | 24 | 0.025 |
| G3/8 | 0155 17 17 | 22 | 25 | 0.045 |
| G1/2 | 0155 21 21 | 27 | 32 | 0.084 |
| G3/4 | 0155 27 27 | 32 | 35 | 0.108 |
| G1 | 0155 34 34 | 41 | 36 | 0.194 |

207P Equal Adaptor, Female NPTF Thread

Brass



| C | | F | L | Kg |
|---------|---------------|-----|----|-------|
| NPTF1/8 | 207P-2 | 916 | 19 | 0.015 |
| NPTF1/4 | 207P-4 | 34 | 28 | 0.041 |
| NPTF3/8 | 207P-6 | 78 | 28 | 0.049 |
| NPTF1/2 | 207P-8 | 1.1 | 38 | 0.089 |

*F in Inch dimensions

0164 Adaptor, Male NPT/Female BSPP Thread

Brass

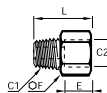

| C1 | C2 | E | F | L | Kg |
|--------|------------------------|------|----|------|-------|
| NPT1/8 | G1/8 0164 11 10 | 7.5 | 14 | 20 | 0.015 |
| NPT1/4 | G1/4 0164 14 13 | 11 | 17 | 27.5 | 0.028 |
| NPT3/8 | G3/8 0164 18 17 | 11.5 | 22 | 28.5 | 0.044 |
| NPT1/2 | G1/2 0164 22 21 | 15 | 27 | 36.5 | 0.081 |
| NPT3/4 | G3/4 0164 28 27 | 16.5 | 32 | 38.5 | 0.110 |

Adaptor for female socket of quick-acting mould couplers

0167 Adaptor, Male BSPT/Female NPT Thread

Brass

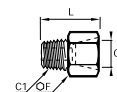

| C1 | C2 | | F | L | Kg |
|------|--------|-------------------|----|------|-------|
| R1/8 | NPT1/8 | 0167 10 11 | 14 | 21 | 0.016 |
| R1/4 | NPT1/4 | 0167 13 14 | 17 | 28.5 | 0.029 |
| R3/8 | NPT3/8 | 0167 17 18 | 22 | 29.5 | 0.047 |
| R1/2 | NPT1/2 | 0167 21 22 | 27 | 37.5 | 0.088 |
| R3/4 | NPT3/4 | 0167 27 28 | 32 | 39.5 | 0.119 |

Adaptor for female socket of quick-acting mould couplers

0168 Reducer, Male BSPP/Female BSPP and Metric Thread

Brass, technical polymer

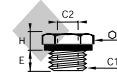

| C1 | C2 | | E | F | H | Kg |
|------|--------|-------------------|----|----|----|-------|
| G1/8 | M5x0.8 | 0168 10 19 | 7 | 14 | 6 | 0.009 |
| G1/4 | M5x0.8 | 0168 13 19 | 7 | 17 | 7 | 0.017 |
| G1/4 | G1/8 | 0168 13 10 | 7 | 17 | 7 | 0.011 |
| G3/8 | G1/8 | 0168 17 10 | 9 | 19 | 6 | 0.019 |
| G3/8 | G1/4 | 0168 17 13 | 9 | 19 | 6 | 0.012 |
| G1/2 | G1/8 | 0168 21 10 | 11 | 24 | 10 | 0.052 |
| G1/2 | G1/4 | 0168 21 13 | 11 | 24 | 10 | 0.042 |
| G1/2 | G3/8 | 0168 21 17 | 11 | 24 | 10 | 0.030 |
| G3/4 | G1/4 | 0168 27 13 | 11 | 32 | 12 | 0.098 |
| G3/4 | G3/8 | 0168 27 17 | 11 | 32 | 12 | 0.084 |
| G3/4 | G1/2 | 0168 27 21 | 11 | 32 | 12 | 0.063 |

With fitted captive seal

0163 Unequal Reducer, Male BSPT/Female BSPP Thread

Brass

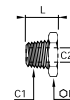

| C1 | C2 | | F | L | Kg |
|------|------|-------------------|----|------|-------|
| R1/4 | G1/8 | 0163 13 10 | 14 | 16 | 0.009 |
| R3/8 | G1/8 | 0163 17 10 | 17 | 16.5 | 0.020 |
| R3/8 | G1/4 | 0163 17 13 | 17 | 16.5 | 0.012 |
| R1/2 | G1/8 | 0163 21 10 | 22 | 21 | 0.048 |
| R1/2 | G1/4 | 0163 21 13 | 22 | 21 | 0.038 |
| R1/2 | G3/8 | 0163 21 17 | 22 | 21 | 0.025 |
| R3/4 | G1/4 | 0163 27 13 | 27 | 24 | 0.085 |
| R3/4 | G3/8 | 0163 27 17 | 27 | 24 | 0.069 |
| R3/4 | G1/2 | 0163 27 21 | 27 | 24 | 0.046 |
| R1 | G3/4 | 0163 34 27 | 36 | 27 | 0.085 |

Brass Adaptors

209P Reducer, Male/Female NPTF Thread

Brass



| C | C1 | | F | L | Kg |
|---------|---------|------------------|------|----|-------|
| NPTF1/4 | NPTF1/8 | 209P-4-2 | 916 | 19 | 0.012 |
| NPTF3/8 | NPTF1/8 | 209P-6-2 | 1116 | 18 | 0.024 |
| NPTF3/8 | NPTF1/4 | 209P-6-4 | 1116 | 19 | 0.179 |
| NPTF1/2 | NPTF1/8 | 209P-8-2 | 78 | 25 | 0.059 |
| NPTF1/2 | NPTF1/4 | 209P-8-4 | 78 | 26 | 0.048 |
| NPTF1/2 | NPTF3/8 | 209P-8-6 | 78 | 26 | 0.033 |
| NPTF3/4 | NPTF1/4 | 209P-12-4 | 1.2 | 25 | 0.093 |
| NPTF3/4 | NPTF3/8 | 209P-12-6 | 1.2 | 26 | 0.080 |
| NPTF3/4 | NPTF1/2 | 209P-12-8 | 1.2 | 26 | 0.057 |

*F in Inch dimensions

222P Reducer, Female/Male NPTF Thread

Brass

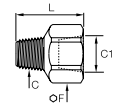

| C | C1 | | F | L | Kg |
|---------|---------|-----------------|------|----|-------|
| NPTF1/8 | NPTF1/4 | 222P-4-2 | 34 | 27 | 0.031 |
| NPTF1/4 | NPTF3/8 | 222P-6-4 | 78 | 32 | 0.046 |
| NPTF3/8 | NPTF1/2 | 222P-8-6 | 1116 | 37 | 0.082 |

*F in Inch dimensions

0121 Equal/Unequal Straight Male Adaptor, Male BSPT Thread

Brass



| C1 | C2 | | F | L | Kg |
|--------|--------|-------------------|----|------|-------|
| R1/8 | R1/8 | 0121 10 10 | 11 | 19 | 0.009 |
| R1/4 | R1/8 | 0121 13 10 | 14 | 23.5 | 0.017 |
| R1/4 | R1/4 | 0121 13 13 | 14 | 27 | 0.020 |
| R3/8 | R1/8 | 0121 17 10 | 17 | 24 | 0.021 |
| R3/8 | R1/4 | 0121 17 13 | 17 | 27.5 | 0.026 |
| R3/8 | R3/8 | 0121 17 17 | 17 | 28 | 0.026 |
| R1/2 | R1/8 | 0121 21 10 | 22 | 28.5 | 0.041 |
| R1/2 | R1/4 | 0121 21 13 | 22 | 32 | 0.045 |
| R1/2 | R3/8 | 0121 21 17 | 22 | 32.5 | 0.045 |
| R1/2 | R1/2 | 0121 21 21 | 22 | 36 | 0.052 |
| R3/4 | R1/4 | 0121 27 13 | 27 | 35 | 0.078 |
| R3/4 | R3/8 | 0121 27 17 | 27 | 35.5 | 0.077 |
| R3/4 | R1/2 | 0121 27 21 | 27 | 39 | 0.084 |
| R3/4 | R3/4 | 0121 27 27 | 27 | 40 | 0.090 |
| R1 | R3/8 | 0121 34 17 | 36 | 38.5 | 0.127 |
| R1 | R1/2 | 0121 34 21 | 36 | 42 | 0.135 |
| R1 | R3/4 | 0121 34 27 | 36 | 43 | 0.144 |
| R1 | R1 | 0121 34 34 | 36 | 46 | 0.152 |
| R1 1/4 | R1/2 | 0121 42 21 | 46 | 46.5 | 0.219 |
| R1 1/4 | R3/4 | 0121 42 27 | 46 | 47.5 | 0.229 |
| R1 1/4 | R1 | 0121 42 34 | 46 | 50.5 | 0.234 |
| R1 1/4 | R1 1/4 | 0121 42 42 | 46 | 53 | 0.230 |

0169 Increaser, Male/Female BSPP Thread

Brass, technical polymer



| C1 | C2 | | E1 | E2 | F | L | Kg |
|------|------|-------------------|-----|------|----|------|-------|
| G1/8 | G1/4 | 0169 10 13 | 5 | 11 | 17 | 16 | 0.019 |
| G1/8 | G3/8 | 0169 10 17 | 5 | 14 | 22 | 19.5 | 0.038 |
| G1/4 | G3/8 | 0169 13 17 | 7 | 14 | 22 | 19.5 | 0.041 |
| G1/4 | G1/2 | 0169 13 21 | 7 | 14.5 | 27 | 20.5 | 0.060 |
| G3/8 | G1/2 | 0169 17 21 | 8 | 14.5 | 27 | 20.5 | 0.062 |
| G3/8 | G3/4 | 0169 17 27 | 8 | 15.5 | 32 | 22 | 0.082 |
| G1/2 | G3/4 | 0169 21 27 | 9.5 | 15.5 | 32 | 22.5 | 0.087 |

With fitted captive seal

FG43 Increaser, Female BSPP/Male BSPT Thread

Brass

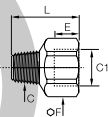

| C | C1 | | E | F | L | Kg |
|------|------|---------------------|----|----|------|-------|
| R1/8 | G1/4 | 1/4X1/8FG43B | 11 | 17 | 21.5 | 0.019 |
| R1/8 | G3/8 | 3/8X1/8FG43B | 12 | 22 | 25 | 0.035 |
| R1/4 | G3/8 | 3/8X1/4FG43B | 12 | 22 | 28 | 0.040 |
| R1/2 | G3/4 | 3/4X1/2FG43B | 16 | 32 | 39 | 0.107 |

FF44 Equal Adaptor, Male BSPP Thread

Brass

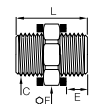

| C | | E | F | L | Kg |
|------|-----------------|----|----|----|-------|
| G1/8 | 1/8FF44B | 6 | 14 | 19 | 0.018 |
| G1/4 | 1/4FF44B | 7 | 17 | 22 | 0.022 |
| G3/8 | 3/8FF44B | 8 | 22 | 24 | 0.040 |
| G1/2 | 1/2FF44B | 10 | 27 | 31 | 0.077 |

These parts are supplied with two copper seals.

0121 Equal Adaptor, Male NPT/BSPT Thread

Brass



| C1 | C2 | | F | L | Kg |
|--------|------|-------------------|----|----|-------|
| NPT1/8 | R1/8 | 0121 11 10 | 11 | 19 | 0.009 |
| NPT1/4 | R1/4 | 0121 14 13 | 14 | 27 | 0.021 |
| NPT3/8 | R3/8 | 0121 18 17 | 17 | 28 | 0.026 |
| NPT1/2 | R1/2 | 0121 22 21 | 22 | 36 | 0.052 |
| NPT3/4 | R3/4 | 0121 28 27 | 27 | 40 | 0.089 |

216P Equal Adaptor, Male NPTF Thread

Brass



| C | | F | L | Kg |
|---------|---------------|------|----|-------|
| NPTF1/8 | 216P-2 | 716 | 25 | 0.011 |
| NPTF1/4 | 216P-4 | 916 | 35 | 0.025 |
| NPTF3/8 | 216P-6 | 1116 | 36 | 0.035 |
| NPTF1/2 | 216P-8 | 78 | 46 | 0.065 |

*F in Inch dimensions

0929 Equal 3-Piece Adaptor, Male BSPT Thread without seal

Brass

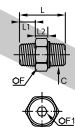

| C | | F | F1 | L | L1 | L2 | Kg |
|------|-------------------|----|----|------|------|-----|-------|
| R1/8 | 0929 00 10 | 15 | 5 | 27 | 9 | 8.5 | 0.017 |
| R1/4 | 0929 00 13 | 19 | 6 | 33.5 | 11.5 | 9.5 | 0.035 |
| R3/8 | 0929 00 17 | 22 | 8 | 36.5 | 13 | 10 | 0.055 |
| R1/2 | 0929 00 21 | 27 | 12 | 45 | 15.5 | 12 | 0.088 |

This connection accessory makes assembly much easier thanks to its 3-piece design. To join 2 threaded components, simply push together and tighten the sleeve nut, thus reducing installation time.
Maximum working pressure: 50 bar.
Working temperature: -10° to +80°C.

0929..1 Equal 3-Piece Adaptor, Male BSPT Thread with seal

Brass, NBR

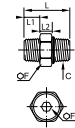

| C | | F | F1 | L | L1 | L2 | Kg |
|------|-------------------|----|----|------|------|-----|-------|
| R1/8 | 0929 01 10 | 15 | 5 | 27 | 7.5 | 8.5 | 0.017 |
| R1/4 | 0929 01 13 | 19 | 6 | 33.5 | 11 | 9.5 | 0.035 |
| R3/8 | 0929 01 17 | 22 | 8 | 36.5 | 11.5 | 10 | 0.055 |
| R1/2 | 0929 01 21 | 27 | 12 | 45 | 14 | 12 | 0.088 |
| R3/4 | 0929 01 27 | 36 | 14 | 52.5 | 16.5 | 17 | 0.199 |
| R1 | 0929 01 34 | 46 | 19 | 63.5 | 19 | 20 | 0.369 |

This connection accessory makes assembly much easier thanks to its 3-piece design. To join 2 threaded components, simply push together and tighten the sleeve nut, thus reducing installation time.
Maximum working pressure: 50 bar.
Working temperature: -10° to +80°C. Supplied with seal

0123 Tailpiece Adaptor for Rubber Hose, Male BSPT Thread

Brass

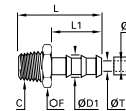

| ØD | ØD1 | C | | F | L | L1 | ØT | Kg |
|----|------|------|-------------------|----|------|------|-----|-------|
| 4 | 6 | R1/8 | 0123 04 10 | 10 | 34 | 22.5 | 3.3 | 0.008 |
| 6 | 8 | R1/8 | 0123 06 10 | 10 | 34 | 22.5 | 5 | 0.009 |
| 9 | 9 | R1/8 | 0123 07 10 | 10 | 34 | 22.5 | 5 | 0.009 |
| 7 | 9 | R1/4 | 0123 07 13 | 14 | 38.5 | 22.5 | 6 | 0.018 |
| | 9 | R3/8 | 0123 07 17 | 17 | 39 | 22.5 | 6 | 0.024 |
| | 12.2 | R1/8 | 0123 10 10 | 13 | 34 | 22.5 | 5 | 0.014 |
| 10 | 12.2 | R1/4 | 0123 10 13 | 14 | 38.5 | 22.5 | 7 | 0.020 |
| | 12.2 | R3/8 | 0123 10 17 | 17 | 39 | 22.5 | 9.5 | 0.023 |
| 12 | 14 | R3/8 | 0123 12 17 | 17 | 46 | 29.5 | 11 | 0.026 |
| | 15 | R1/4 | 0123 13 13 | 17 | 45.5 | 29.5 | 7 | 0.027 |
| 13 | 15 | R3/8 | 0123 13 17 | 17 | 46 | 29.5 | 11 | 0.026 |
| | 15 | R1/2 | 0123 13 21 | 22 | 50.5 | 29.5 | 12 | 0.045 |
| | 18.5 | R3/8 | 0123 16 17 | 19 | 54.5 | 38 | 11 | 0.039 |
| 16 | 18.5 | R1/2 | 0123 16 21 | 22 | 59 | 38 | 14 | 0.053 |
| | 18.5 | R3/4 | 0123 16 27 | 27 | 62 | 38 | 15 | 0.084 |
| | 21.5 | R3/8 | 0123 19 17 | 22 | 54.5 | 38 | 11 | 0.047 |
| 19 | 21.5 | R1/2 | 0123 19 21 | 22 | 59 | 38 | 14 | 0.057 |
| | 21.5 | R3/4 | 0123 19 27 | 27 | 62 | 38 | 18 | 0.083 |
| | 26.7 | R3/4 | 0123 25 27 | 27 | 62 | 38 | 18 | 0.078 |
| 25 | 27 | R1 | 0123 25 34 | 36 | 65 | 38 | 24 | 0.124 |
| 32 | 34.5 | R1 | 0123 32 34 | 36 | 70 | 43 | 24 | 0.144 |

Brass Adaptors

0136 Tailpiece Adaptor for Flexible Tubing, Male BSPT Thread

Brass

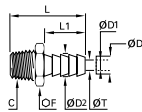
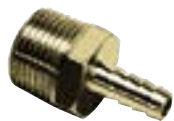

| ØD | ØD1 | ØD2 | C | | F | L | L1 | ØT | Kg |
|----|-----|------|------|-------------------|----|------|----|----|-------|
| 6 | 4 | 4.3 | R1/8 | 0136 06 10 | 10 | 26.5 | 15 | 2 | 0.006 |
| | 4 | 4.3 | R1/4 | 0136 06 13 | 14 | 31 | 15 | 2 | 0.015 |
| | 4 | 4.3 | R3/8 | 0136 06 17 | 17 | 31.5 | 15 | 2 | 0.020 |
| 8 | 6 | 6.4 | R1/8 | 0136 08 10 | 10 | 26.5 | 15 | 4 | 0.007 |
| | 6 | 6.4 | R1/4 | 0136 08 13 | 14 | 31 | 15 | 4 | 0.015 |
| | 6 | 6.4 | R3/8 | 0136 08 17 | 17 | 31.5 | 15 | 4 | 0.020 |
| 10 | 8 | 8.4 | R1/4 | 0136 10 13 | 14 | 31 | 15 | 6 | 0.016 |
| | 8 | 8.4 | R3/8 | 0136 10 17 | 17 | 31.5 | 15 | 6 | 0.020 |
| | 8 | 8.4 | R1/2 | 0136 10 21 | 22 | 36 | 15 | 6 | 0.039 |
| 12 | 10 | 10.7 | R1/4 | 0136 12 13 | 14 | 36 | 20 | 7 | 0.018 |
| | 10 | 10.7 | R3/8 | 0136 12 17 | 17 | 36.5 | 20 | 8 | 0.022 |
| | 10 | 10.7 | R1/2 | 0136 12 21 | 22 | 41 | 20 | 8 | 0.040 |
| 14 | 12 | 12.7 | R1/4 | 0136 14 13 | 14 | 36 | 20 | 7 | 0.019 |
| | 12 | 12.7 | R3/8 | 0136 14 17 | 17 | 36.5 | 20 | 10 | 0.023 |
| | 12 | 12.7 | R1/2 | 0136 14 21 | 22 | 41 | 20 | 10 | 0.041 |
| | 12 | 12.7 | R3/4 | 0136 14 27 | 27 | 44 | 20 | 10 | 0.072 |
| 16 | 13 | 13.7 | R3/8 | 0136 16 17 | 17 | 36.5 | 20 | 11 | 0.023 |
| | 13 | 13.7 | R1/2 | 0136 16 21 | 22 | 41 | 20 | 11 | 0.040 |
| | 13 | 13.7 | R3/4 | 0136 16 27 | 27 | 44 | 20 | 11 | 0.071 |