

Standard Series



For common industrial applications, these ball valves are equipped with fluoropolymer seals and a lockable system.

Technical Characteristics		
Model	Standard and Lockable Series	Compact Series
Compatible Fluids	Compressed air Other fluids : see compatibility chart at the end of this chapter	
Working Pressure	0 to 40 bar up to 2" 0 to 30 bar over 2" excepted BVG4P-LOCK and BVG4-LOCK: 0 to 14 bar	0 to 30 bar
Working Temperature	-20°C to +170°C Excepted BVG4P-LOCK: -10°C to +100°C	-10°C to +90°C

Reliable performance is dependent upon the type of fluid conveyed.

Advantages	
• Long or butterfly handle	
• Full fluid flow	
• A lockable version for safety in use	
• Corrosion resistance thanks to chemical nickel plating	

Component Materials

Silicone-free

Long lever: Geomet® plated steel
Compact Series lever: technical polymer
Butterfly lever: Aluminium

Locking system: treated steel
Stem seal: FPM o-rings
Locking nut and Locking screw: Zinc plated steel

Stem: nickel-plated brass

Body: nickel-plated or chromium-plated shot-blasted brass

Seat seals: PTFE
Ball: chromium-plated brass

4902 (G2-G4), BVGT-C, BVG4-LOCK: Double stem seal: FPM

Regulations

Industrial:

- PED
- RoHS
- REACH

4902 2/2 Standard In-Line Ball Valve, Female BSPP Thread

Nickel-plated brass, PTFE

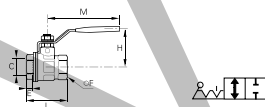

DN	C	4902	E	F	H	L	M	PN	Kg
8	G1/4	4902 10 13	9	17	38	39	82	40	0.131
10	G/8	4902 10 17	9	20	38	39	82	40	0.117
15	G1/2	4902 15 21	11	25	43	50	100	40	0.204
20	G3/4	4902 20 27	12	31	50	54	120	40	0.329
25	G1	4902 25 34	14	38	54	67	120	40	0.468
32	G1 1/4	4902 32 42*	15	48	73	77	158	30	0.770
40	G1 1/2	4902 40 49*	17	54	79	90	158	30	1.040
50	G2	4902 50 48*	19	66	86	106	158	30	1.760
65	G2 1/2	4902 65 47*	22	85	132	136	255	30	4.500
80	G3	4902 80 46*	25	99	140	157	255	30	5.840
100	G4	4902 01 45*	29	125	154	191	255	30	9.040

*Models with EC marking
Model from 2 1/2": double stem seal in FPM
Working temperature: -20°C to +170°C

4991 2/2 Standard Compact In-Line Ball Valve, Male/Female BSPP Thread

Chromium brass, PTFE

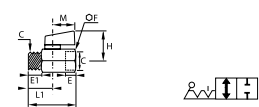

DN	C	4991	E	E1	F	H	L	L1	M	Kg
6	G1/8	4991 00 10	10	10	21	30	41.5	10	24	0.089
8	G1/4	4991 00 13	11	11	21	30	41.5	11	24	0.082
8	G3/8	4991 00 17	11	11	21	30	41.5	10.5	24	0.087
10	G1/2	4991 00 21	13	13	25	32	49	12.5	24	0.134

4992 2/2 Standard Compact In-Line Ball Valve, Female BSPP Thread

Chromium brass, PTFE

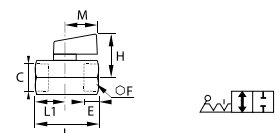

DN	C	4992	E	F	H	L	L1	M	Kg
6	G1/8	4992 00 10	10	21	30	41.5	10	24	0.111
8	G1/4	4992 00 13	11	21	30	41.5	11	24	0.100
8	G3/8	4992 00 17	11	21	30	41.5	10.5	24	0.094
10	G1/2	4992 00 21	13	25	32	49	12.5	24	0.142

BVGT4-C 2/2 Standard In-Line Ball Valve, Female BSPP Thread, Butterfly Handle

Nickel-plated brass

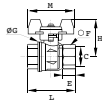

DN	C		E	F	G	H	L	M	Kg
8	G1/4	BVGT4-1/4C	9	17	25	40	39	50	0.130
10	G3/8	BVGT4-3/8C	9	20	25	40	39	50	0.120
15	G1/2	BVGT4-1/2C	11	25	32.5	44	50	50	0.180
20	G3/4	BVGT4-3/4C	12	31	39	49	54	50	0.265
25	G1	BVGT4-1C	14	38	47.5	53	67	50	0.390

Compact lever

BVG4-LOCK 2/2 In-Line Lockable Ball Valve, Female BSPP Thread

Nickel-plated brass

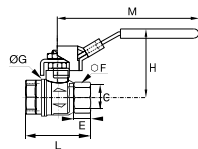

DN	C		E	F	H	L	M	Kg
8	G1/4	BVG4-1/4LOCK	9	17	46	39	96	0.150
10	G3/8	BVG4-3/8LOCK	9	20	46	39	96	0.150
15	G1/2	BVG4-1/2LOCK	11	25	51	50	96	0.255
19	G3/4	BVG4-3/4LOCK	12	31	59	54	117	0.390
25	G1	BVG4-1LOCK	14	38	63	67	117	0.590

Double stem seal in FPM
Working temperature -40°C to +170°C

BVG4P-LOCK 3/2 In-Line Lockable Vented Ball Valve, Female BSPP Thread

Nickel-plated brass

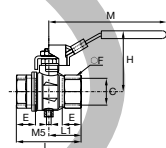

DN	C		E	F	H	L	L1	M	Kg
8	G1/4	BVG4P-1/4LOCK	12	17	47.5	45	22.5	96	0.155
10	G3/8	BVG4P-3/8LOCK	12	20	47.5	45	22.5	96	0.172
15	G1/2	BVG4P-1/2LOCK	15.5	25	52	59	29.5	96	0.239
20	G3/4	BVG4P-3/4LOCK	17	31	59.5	64	32	117	0.371
25	G1	BVG4P-1LOCK	21	40	63.5	81	40.5	117	0.581

Working pressure: 14 bar
Working temperature: -10°C to +100°C