

PNMK4 Plug

BSPP 60° Cone plug (ISO 8434-6)

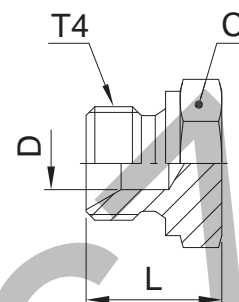

| Thread BSPP T4 | C mm | D mm | L mm | Weight (steel) g/1 piece | Adapter Steel | Adapter Stainless Steel | PN (bar) | |
|----------------------|---------|---------|---------|--------------------------------|------------------|----------------------------|----------|-----|
| | | | | | | | S | SS |
| 1/8-28 | 14 | 3.5 | 14 | 11 | 2PNMK4S | 2PNMK4SS | 350 | 350 |
| 1/4-19 | 19 | 4.7 | 19 | 22 | 4PNMK4S | 4PNMK4SS | 350 | 350 |
| 3/8-19 | 22 | 7.9 | 21 | 38 | 6PNMK4S | 6PNMK4SS | 350 | 350 |
| 1/2-14 | 27 | 11.1 | 24 | 66 | 8PNMK4S | 8PNMK4SS | 200 | 200 |
| 5/8-14 | 30 | 14.3 | 27 | 76 | 10PNMK4S | 10PNMK4SS | 200 | 200 |
| 3/4-14 | 32 | 16.7 | 27 | 106 | 12PNMK4S | 12PNMK4SS | 200 | 200 |
| 1-11 | 41 | 22.2 | 30 | 170 | 16PNMK4S | 16PNMK4SS | 120 | 120 |
| 1 1/4-11 | 50 | 28.6 | 39 | 316 | 20PNMK4S | 20PNMK4SS | 105 | 105 |
| 1 1/2-11 | 55 | 33.3 | 43 | 386 | 24PNMK4S | 24PNMK4SS | 105 | 105 |
| 2-11 | 70 | 46.0 | 48 | 650 | 32PNMK4S | 32PNMK4SS | 70 | 70 |

Order codes shown are part of our current manufacturing programme.

Imperial and metric parts may vary in hexagon dimensions.

$$\frac{\text{PN (bar)}}{10} = \text{PN (MPa)}$$

Do not create drawings from these dimensions, they are subject to change and ISO manufacturing allowances.