

## ASR SAE Straight flange adapter

SAE Flange / Butt weld reducer tube end  
(ISO 6162-1/-2)

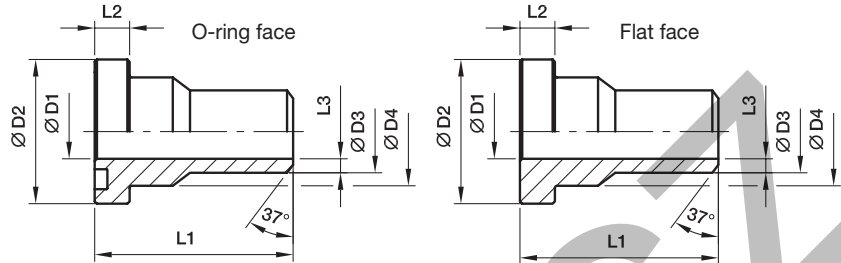

### 3000 PSI Series

| Nom. flange size |          | Tube    | D1 | D2    | D3    | D4    | L1  | L2   | L3   | Weight (steel) kg/piece | O-ring face   | Flat face      | PN (bar <sup>1)</sup> ) |     |
|------------------|----------|---------|----|-------|-------|-------|-----|------|------|-------------------------|---------------|----------------|-------------------------|-----|
| SAE (in.)        | ISO (DN) |         |    |       |       |       |     |      |      |                         | Order code*   | Order code*    | S                       | SS  |
| 1/2              | 13       | 18x4.5  | 10 | 30.2  | 18.0  | 24.0  | 45  | 6.7  | 4.0  | 0.12                    | ASR32/18X4.5  | ASRG32/18X4.5  | 345                     | 345 |
| 3/4              | 19       | 22x4.5  | 13 | 38.1  | 22.0  | 31.5  | 50  | 6.7  | 4.5  | 0.18                    | ASR33/22X4.5  | ASRG33/22X4.5  | 345                     | 345 |
| 1                | 25       | 28x4.5  | 19 | 44.4  | 28.0  | 38.0  | 55  | 8.0  | 4.5  | 0.26                    | ASR34/28X4.5  | ASRG34/28X4.5  | 345                     | 345 |
| 1 1/4            | 32       | 35x5.0  | 25 | 50.8  | 35.0  | 43.0  | 60  | 8.0  | 5.0  | 0.31                    | ASR35/35X5    | ASRG35/35X5    | 276                     | 276 |
| 1 1/2            | 38       | 43x6.0  | 31 | 60.3  | 43.0  | 50.0  | 65  | 8.0  | 6.0  | 0.51                    | ASR36/43X6    | ASRG36/43X6    | 207                     | 207 |
| 2                | 51       | 50x6.0  | 38 | 71.4  | 50.0  | 62.0  | 70  | 9.5  | 6.0  | 0.80                    | ASR38/50X6    | ASRG38/50X6    | 207                     | 207 |
| 2 1/2            | 64       | 62x7.5  | 47 | 84.1  | 62.0  | 74.0  | 75  | 9.5  | 7.5  | 1.24                    | ASR310/62X7.5 | ASRG310/62X7.5 | 172                     | 172 |
| 3                | 76       | 76x9.0  | 58 | 101.6 | 76.0  | 90.0  | 85  | 9.5  | 9.0  | 1.95                    | ASR312/76X9   | ASRG312/76X9   | 138                     | 138 |
| 3 1/2            | 89       | 90x10.0 | 70 | 114.3 | 90.0  | 102.0 | 90  | 11.2 | 10.0 | 2.15                    | ASR314/90X10  | ASRG314/90X10  | 34                      | 34  |
| 4                | 102      | 102x7.0 | 88 | 127.0 | 102.0 | 114.0 | 100 | 11.2 | 7.0  | 2.62                    | ASR316/102X7  | ASRG316/102X7  | 34                      | 34  |

### 6000 PSI Series

|       |    |        |    |      |      |      |    |      |     |      |              |               |     |     |
|-------|----|--------|----|------|------|------|----|------|-----|------|--------------|---------------|-----|-----|
| 1/2   | 13 | 18x4.0 | 10 | 31.8 | 18.0 | 24.0 | 45 | 7.7  | 4.0 | 0.12 | ASR62/18X4   | ASRG62/18X4   | 420 | 420 |
| 3/4   | 19 | 22x4.5 | 13 | 41.3 | 22.0 | 32.0 | 50 | 8.7  | 4.5 | 0.20 | ASR63/22X4.5 | ASRG63/22X4.5 | 420 | 420 |
| 1     | 25 | 28x5.0 | 18 | 47.6 | 28.0 | 38.0 | 55 | 9.5  | 5.0 | 0.31 | ASR64/28X5   | ASRG64/28X5   | 420 | 420 |
| 1 1/4 | 32 | 35x6.5 | 22 | 54.0 | 35.0 | 44.0 | 60 | 10.3 | 6.5 | 0.46 | ASR65/35X6.5 | ASRG65/35X6.5 | 420 | 420 |
| 1 1/2 | 38 | 44x7.5 | 29 | 63.5 | 44.0 | 51.0 | 65 | 12.5 | 7.5 | 0.69 | ASR66/44X7.5 | ASRG66/44X7.5 | 420 | 420 |
| 2     | 51 | 51x8.0 | 35 | 79.4 | 51.0 | 67.0 | 70 | 12.5 | 8.0 | 1.24 | ASR68/51X8   | ASRG68/51X8   | 420 | 420 |

<sup>1)</sup>Pressure shown = Item deliverable

$$\frac{PN \text{ (bar)}}{10} = PN \text{ (MPa)}$$

The pressures given here are the maximum allowable for the flange fittings. If the pipe or tube used has a lower pressure rating, then the welded assembly rating will be the lower one, assuming the weld is adequately strong.

See pages M16 - M20 for related flanges or flange halves depending on bolt sets.

**Stainless steel parts may have dimensional deviations. Additional information on request.**

\*Please add the **suffixes** below according to the material/surface required.

| Order code suffixes |                             |                             |  |  |   |
|---------------------|-----------------------------|-----------------------------|--|--|---|
| Material            | Suffix surface and material | Example only flange adapter | Example incl. splitflanges, metr. bolts and O-ring | Example incl. splitflanges, UNC bolts and O-ring | Standard sealing material (no additional suffix needed) |
| Steel, oil dipped   | S                           | ASR32/18X4.5S               | ASR32/18X4.5SM                                     | ASR32/18X4.5SU                                   | NBR   |
| Stainless steel     | SS                          | ASR32/18X4.5SS              | ASR32/18X4.5SSM                                    | -  | VIT   |