

## C3T4 Male elbow

JIS BSPP 60° cone adapters (JIS B8363) / Male BSPT thread (ISO 7)

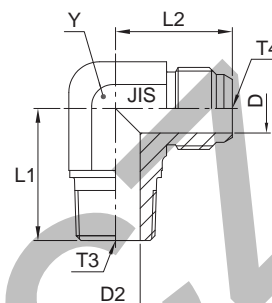

Thread BSPP T4	Thread BSPT T3	D mm	D2 mm	L1 mm	L2 mm	Y mm	Weight (steel) g/1 piece	Adapter Steel	PN (bar)
1/4-19	1/4-19	4.5	4.5	25	25	14.0	41	<b>4C3T4S</b>	315
3/8-19	3/8-19	7.0	7.0	30	29	19.0	74	<b>6C3T4S</b>	315
1/2-14	1/2-14	11.0	11.0	36	34	22.0	131	<b>8C3T4S</b>	200
3/4-14	3/4-14	15.9	15.9	43	38	27.0	146	<b>12C3T4S</b>	160
1-11	1-11	21.0	21.0	50	44	33.3	398	<b>16C3T4S</b>	120

Do not create drawings from these dimensions, they are subject to change and ISO manufacturing allowances.

## V3T4 Male 45° elbow

JIS BSPP 30° Flare end (JIS B8363) / Male BSPT thread (ISO 7)

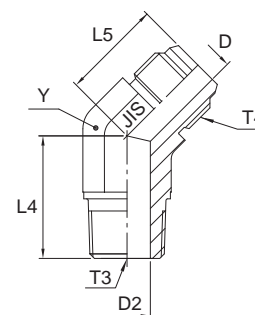

Thread BSPP T4	Thread BSPT T3	D mm	D2 mm	L4 mm	L5 mm	Y mm	Weight (steel) g/1 piece	Adapter Steel	PN (bar)
1/4-19	1/4-19	4.5	4.5	19	22	14.0	33	<b>4V3T4S</b>	315
3/8-19	3/8-19	7.0	7.0	22	25	19.0	64	<b>6V3T4S</b>	315
1/2-14	1/2-14	11.0	11.0	27	28	22.0	112	<b>8V3T4S</b>	200
3/4-14	3/4-14	15.9	15.9	30	32	27.0	162	<b>12V3T4S</b>	160
1-11	1-11	21.0	21.0	35	32	33.3	256	<b>16V3T4S</b>	120

Order codes shown are part of our current manufacturing programme.

Imperial and metric parts may vary in hexagon dimensions.

$$\frac{\text{PN (bar)}}{10} = \text{PN (MPa)}$$

Do not create drawings from these dimensions, they are subject to change and ISO manufacturing allowances.