

F3P4 Male stud connector

JIS BSPP 60° Cone end (JIS B8363) / Male BSPT thread (ISO 7)

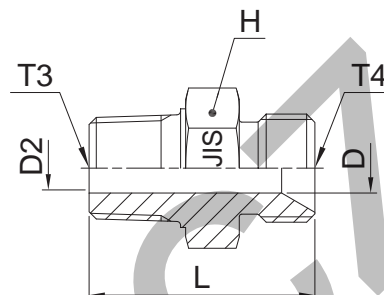

| Thread BSPP T4 | Thread BSPT T3 | D mm | D2 mm | H mm | L mm | Weight (steel) g/1 piece | Adapter Steel | Adapter Stainless Steel | | PN (bar) | |
|----------------------|----------------------|---------|----------|---------|---------|--------------------------------|------------------|----------------------------|-----|----------|-----|
| | | | | | | | | S | SS | S | SS |
| 1/4-19 | 1/4-19 | 4.5 | 4.5 | 19.0 | 37 | 47 | 4F3P4S | 4F3MP4SS | 315 | 315 | 315 |
| 3/8-19 | 3/8-19 | 7.0 | 7.0 | 22.2 | 38 | 67 | 6F3P4S | 6F3MP4SS | 315 | 315 | 315 |
| 1/2-14 | 1/2-14 | 11.0 | 11.0 | 27.0 | 46 | 109 | 8F3P4S | 8F3MP4SS | 200 | 200 | 200 |
| 3/4-14 | 3/4-14 | 15.9 | 15.9 | 36.5 | 52 | 195 | 12F3P4S | 12F3MP4SS | 160 | 160 | 160 |
| 1-11 | 1-11 | 21.0 | 21.0 | 41.3 | 58 | 292 | 16F3P4S | 16F3MP4SS | 120 | 120 | 120 |

Do not create drawings from these dimensions, they are subject to change and ISO manufacturing allowances.

C3P4 Male 90° elbow

JIS BSPP 60° cone end (JIS B8363) / Male BSPT thread (ISO 7)

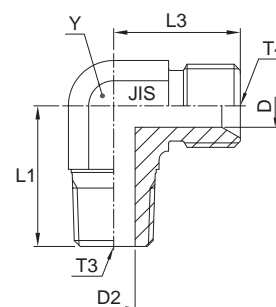

| Thread BSPP T4 | Thread BSPT T3 | D mm | D2 mm | L1 mm | L3 mm | Y mm | Weight (steel) g/1 piece | Adapter Steel | PN |
|----------------------|----------------------|---------|----------|----------|----------|---------|--------------------------------|------------------|-------|
| | | | | | | | | | (bar) |
| 1/4-19 | 1/4-19 | 4.5 | 4.5 | 25 | 24 | 14.0 | 49 | 4C3P4S | 315 |
| 3/8-19 | 3/8-19 | 7.0 | 7.0 | 30 | 29 | 19.0 | 97 | 6C3P4S | 315 |
| 1/2-14 | 1/2-14 | 11.0 | 11.0 | 36 | 33 | 22.0 | 147 | 8C3P4S | 200 |
| 3/4-14 | 3/4-14 | 15.9 | 15.9 | 43 | 40 | 27.0 | 206 | 12C3P4S | 160 |
| 1-11 | 1-11 | 21.0 | 21.0 | 50 | 44 | 33.3 | 434 | 16C3P4S | 120 |

Order codes shown are part of our current manufacturing programme.

Imperial and metric parts may vary in hexagon dimensions.

$$\frac{\text{PN (bar)}}{10} = \text{PN (MPa)}$$

Do not create drawings from these dimensions, they are subject to change and ISO manufacturing allowances.