

## DVGE-M Straight male stud plain bearing rotary union

Male metric thread – ED-seal / EO 24° cone end

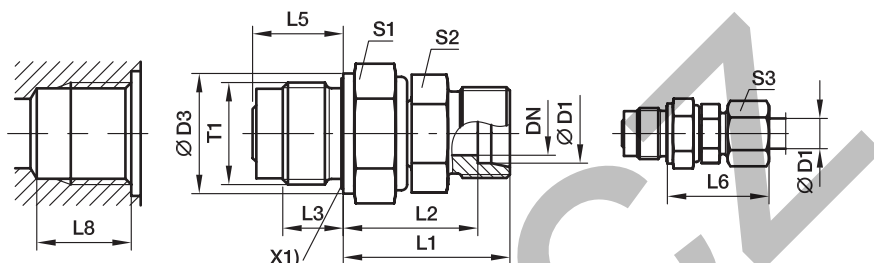

X1) Eolastic-sealing

L8 larger than DIN 3852  
chart page P22

Series	D1 	T1	DN	D3	L1	L2	L3	L5	L6	S1	S2	S3	Weight g/1 piece	Order code*	PN (bar) <sup>1)</sup>	
															CF	VIT
L <sup>3)</sup>	06	M 14×1.5	4	19	27.0	20.0	12	18.0	27	19	12	14	44	<b>DVGE06LMOMD</b>	40	40
	08	M 14×1.5	5	19	28.0	21.0	12	18.0	29	19	12	17	45	<b>DVGE08LMOMD</b>	40	40
	10	M 18×1.5	6	24	33.0	26.0	12	18.0	30	24	14	19	87	<b>DVGE10LMOMD</b>	40	40
	12	M 22×1.5	8	27	34.0	27.0	14	21.0	32	27	17	22	120	<b>DVGE12LMOMD</b>	40	40
	15	M 27×2.0	10	32	40.0	33.0	16	24.0	36	32	19	27	215	<b>DVGE15LMOMD</b>	40	40
	18	M 33×2.0	16	40	45.0	37.5	18	27.5	40	41	27	32	349	<b>DVGE18LMOMD</b>	40	40
	22	M 33×2.0	16	40	47.0	39.5	18	27.5	44	41	27	36	383	<b>DVGE22LMOMD</b>	40	40
	28	M 42×2.0	22	50	51.5	44.0	20	31.0	47	50	36	41	590	<b>DVGE28LMOMD</b>	40	40
	35	M 48×2.0	25	55	64.5	54.0	22	35.0	56	55	41	50	876	<b>DVGE35LMOMD</b>	40	40
S <sup>4)</sup>	06	M 14×1.5	4	19	28.0	21.0	12	18.0	31	19	12	17	51	<b>DVGE06SMOMD</b>	100	100
	08	M 14×1.5	5	19	29.0	22.0	12	18.0	32	19	14	19	56	<b>DVGE08SMOMD</b>	100	100
	10	M 18×1.5	6	24	34.5	27.0	12	18.0	34	24	17	22	98	<b>DVGE10SMOMD</b>	100	100
	12	M 22×1.5	8	27	35.5	28.0	14	21.0	38	27	17	24	139	<b>DVGE12SMOMD</b>	100	100
	16	M 27×2.0	10	32	42.5	34.0	16	24.0	43	32	24	30	239	<b>DVGE16SMOMD</b>	100	100
	20	M 33×2.0	16	40	50.0	39.5	18	27.5	48	41	27	36	385	<b>DVGE20SMOMD</b>	100	100
	25	M 33×2.0	16	40	54.5	42.5	18	27.5	54	41	36	46	494	<b>DVGE25SMOMD</b>	100	100
	30	M 42×2.0	22	50	61.5	48.0	20	31.0	62	50	41	50	695	<b>DVGE30SMOMD</b>	100	100
	38	M 48×2.0	25	55	71.0	55.0	22	35.0	72	55	50	60	1088	<b>DVGE38SMOMD</b>	100	100

<sup>1)</sup> Pressure shown = item deliverable

<sup>3)</sup> L = light series; <sup>4)</sup> S = heavy series

$$\frac{\text{PN (bar)}}{10} = \text{PN (MPa)}$$

Delivery without nut and ring. Information on ordering complete fittings or alternative sealing materials see page I7.

\*Please add the **suffixes**  
below according to the material/  
surface required.

Order code suffixes			
Material	Suffix surface and material	Example	Standard sealing material (no additional suffix needed)
Steel	CF	DVGE06LMOMDCF	NBR
FKM	VITCF	DVGE06LMOMDVITCF	