

## F682EDML Swivel male stud

O-Lok® ORFS Swivel female end / Male metric thread – ED seal (ISO 9974)

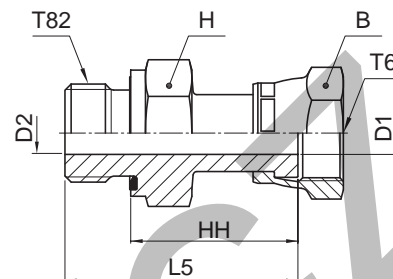

| Tube O.D.  |           | Thread metric T82 | Thread UN/UNF-2B T6 | B mm | H mm | D1 mm | D2 mm | L5 mm | HH mm | Weight (steel) g/1 piece | O-Lok®                |                        | PN (bar) |     |
|------------|-----------|-------------------|---------------------|------|------|-------|-------|-------|-------|--------------------------|-----------------------|------------------------|----------|-----|
| mm         | in.       |                   |                     |      |      |       |       |       |       |                          | Steel                 | Stainless Steel        | S        | SS  |
| 6          | 1/4       | M 12×1.5          | 9/16-18             | 17   | 17   | 4.0   | 4.0   | 39    | 27    | 56                       | <b>4M12F682EDMLS</b>  | <b>4M12F682EDMLSS</b>  | 500      | 420 |
| 8, 10      | 5/16, 3/8 | M 12×1.5          | 11/16-16            | 22   | 19   | 6.5   | 4.0   | 41    | 29    | 70                       | <b>6M12F682EDMLS</b>  | <b>6M12F682EDMLSS</b>  | 500      | 420 |
| 8, 10      | 5/16, 3/8 | M 14×1.5          | 11/16-16            | 22   | 19   | 6.5   | 5.0   | 41    | 29    | 73                       | <b>6M14F682EDMLS</b>  | <b>6M14F682EDMLSS</b>  | 630      | 420 |
| 8, 10      | 5/16, 3/8 | M 16×1.5          | 11/16-16            | 22   | 22   | 6.5   | 6.5   | 41    | 29    | 85                       | <b>6M16F682EDMLS</b>  | <b>6M16F682EDMLSS</b>  | 630      | 420 |
| 12         | 1/2       | M 16×1.5          | 13/16-16            | 24   | 22   | 9.0   | 7.0   | 48    | 36    | 109                      | <b>8M16F682EDMLS</b>  | <b>8M16F682EDMLSS</b>  | 630      | 420 |
| 14, 15, 16 | 5/8       | M 22×1.5          | 1-14                | 30   | 27   | 11.5  | 11.5  | 53    | 39    | 165                      | <b>10M22F682EDMLS</b> | <b>10M22F682EDMLSS</b> | 420      | 420 |
| 18, 20     | 3/4       | M 27×2.0          | 1 3/16-12           | 36   | 32   | 14.0  | 14.0  | 58    | 42    | 282                      | <b>12M27F682EDMLS</b> | <b>12M27F682EDMLSS</b> | 420      | 420 |
| 22, 25     | 1         | M 33×2.0          | 1 7/16-12           | 41   | 41   | 20.0  | 20.0  | 68    | 50    | 467                      | <b>16M33F682EDMLS</b> | <b>16M33F682EDMLSS</b> | 420      | 420 |
| 28, 30, 32 | 1 1/4     | M 42×2.0          | 1 11/16-12          | 50   | 50   | 26.0  | 26.0  | 70    | 50    | 635                      | <b>20M42F682EDMLS</b> | <b>20M42F682EDMLSS</b> | 350      | 280 |
| 35, 38     | 1 1/2     | M 48×2.0          | 2-12                | 60   | 55   | 32.0  | 32.0  | 72    | 50    | 885                      | <b>24M48F682EDMLS</b> | <b>24M48F682EDMLSS</b> | 280      | 280 |

O-Lok® is delivered with NBR elastomeric seals as standard. For more details on other seal materials see page J73-J74.

Part numbers shown are part of our current manufacturing programme.

Imperial and metric parts may vary in hexagon dimensions.

$$\frac{\text{PN (bar)}}{10} = \text{PN (MPa)}$$

Do not create drawings from these dimensions, they are subject to change and ISO manufacturing allowances.