

F642EDML Swivel male stud

O-Lok® ORFS Swivel female end / Male BSPP thread – ED seal (ISO 1179)

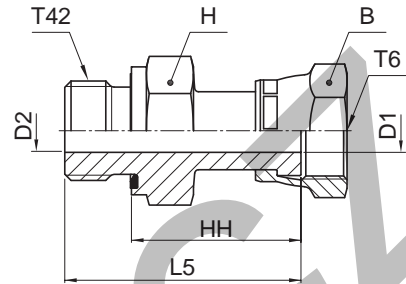

| Tube O.D. | | Thread BSPP T42 | Thread UN/UNF-2B T6 | B mm | H mm | D1 mm | D2 mm | L5 mm | HH mm | Weight (steel) g/1 piece | O-Lok® | | PN (bar) | |
|------------|-----------|-----------------|---------------------|------|------|-------|-------|-------|-------|--------------------------|-----------------------|------------------------|----------|-----|
| mm | in. | | | | | | | | | | Steel | Stainless Steel | S | SS |
| 6 | 1/4 | 1/8-28 | 9/16-18 | 17 | 14 | 4.0 | 4.0 | 35 | 27 | 43 | 4F642EDMLS | 4F642EDMLSS | 500 | 420 |
| 6 | 1/4 | 1/4-19 | 9/16-18 | 17 | 19 | 4.0 | 4.0 | 39 | 27 | 59 | 4-4F642EDMLS | 4-4F642EDMLSS | 500 | 420 |
| 8, 10 | 5/16, 3/8 | 1/4-19 | 11/16-16 | 22 | 19 | 6.5 | 5.0 | 41 | 29 | 72 | 6F642EDMLS | 6F642EDMLSS | 630 | 420 |
| 8, 10 | 5/16, 3/8 | 3/8-19 | 11/16-16 | 22 | 22 | 6.5 | 6.5 | 41 | 29 | 86 | 6-6F642EDMLS | 6-6F642EDMLSS | 630 | 420 |
| 8, 10 | 5/16, 3/8 | 1/2-14 | 11/16-16 | 22 | 27 | 6.5 | 6.5 | 43 | 29 | 92 | 6-8F642EDMLS | 6-8F642EDMLSS | 420 | 420 |
| 12 | 1/2 | 3/8-19 | 13/16-16 | 24 | 22 | 9.0 | 8.0 | 48 | 36 | 104 | 8F642EDMLS | 8F642EDMLSS | 630 | 420 |
| 12 | 1/2 | 1/4-19 | 13/16-16 | 24 | 22 | 9.0 | 5.0 | 48 | 36 | 98 | 8-4F642EDMLS | 8-4F642EDMLSS | 630 | 420 |
| 12 | 1/2 | 1/2-14 | 13/16-16 | 24 | 27 | 9.0 | 9.0 | 50 | 36 | 142 | 8-8F642EDMLS | 8-8F642EDMLSS | 420 | 420 |
| 14, 15, 16 | 5/8 | 1/2-14 | 1-14 | 30 | 27 | 11.5 | 11.5 | 52 | 38 | 165 | 10F642EDMLS | 10F642EDMLSS | 420 | 420 |
| 14, 15, 16 | 5/8 | 3/4-14 | 1-14 | 30 | 32 | 11.5 | 11.5 | 54 | 38 | 185 | 10-12F642EDMLS | 10-12F642EDMLSS | 420 | 420 |
| 18, 20 | 3/4 | 3/4-14 | 1 3/16-12 | 36 | 32 | 14.0 | 14.0 | 58 | 42 | 266 | 12F642EDMLS | 12F642EDMLSS | 420 | 420 |
| 18, 20 | 3/4 | 1/2-14 | 1 3/16-12 | 36 | 30 | 14.0 | 12.0 | 56 | 42 | 220 | 12-8F642EDMLS | 12-8F642EDMLSS | 420 | 420 |
| 22, 25 | 1 | 1-11 | 1 7/16-12 | 41 | 41 | 20.0 | 20.0 | 67 | 49 | 414 | 16F642EDMLS | 16F642EDMLSS | 420 | 420 |
| 28, 30, 32 | 1 1/4 | 1-11 | 1 11/16-12 | 50 | 46 | 26.0 | 20.0 | 67 | 49 | 655 | 20-16F642EDMLS | 20-16F642EDMLSS | 350 | 280 |
| 28, 30, 32 | 1 1/4 | 1 1/4-11 | 1 11/16-12 | 50 | 50 | 26.0 | 25.0 | 69 | 49 | 623 | 20F642EDMLS | 20F642EDMLSS | 350 | 280 |
| 35, 38 | 1 1/2 | 1 1/2-11 | 2-12 | 60 | 55 | 32.0 | 32.0 | 72 | 50 | 885 | 24F642EDMLS | 24F642EDMLSS | 280 | 280 |

O-Lok® is delivered with NBR elastomeric seals as standard. For more details on other seal materials see page J73-J74.

Part numbers shown are part of our current manufacturing programme.

Imperial and metric parts may vary in hexagon dimensions.

$$\frac{\text{PN (bar)}}{10} = \text{PN (MPa)}$$

Do not create drawings from these dimensions, they are subject to change and ISO manufacturing allowances.