

EC **BSP Swivel Female
with O-Ring
90° Elbow (60° Cone)**

BS 5200 – ISO 12151-6 – DKOR 90°

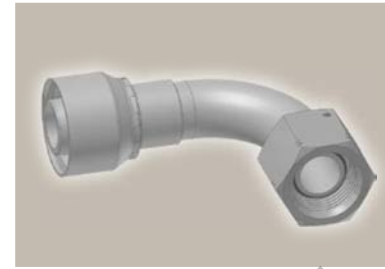
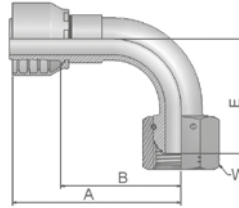

| Part Number | | Hose I.D. | | | | Thread | A | B | E | W |
|-------------|-------------|-----------|-------|------|------|----------|-----|-----|-----|----|
| 46 series | 48 series | DN | Inch | Size | mm | BSP | mm | mm | mm | mm |
| 1EC46-4-4 | 1EC48-4-4 | 6 | 1/4 | -4 | 6.4 | 1/4x19 | 50 | 27 | 24 | 19 |
| 1EC46-6-4 | 1EC48-6-4 | 6 | 1/4 | -4 | 6.4 | 3/8x19 | 51 | 28 | 27 | 22 |
| 1EC46-6-6 | 1EC48-6-6 | 10 | 3/8 | -6 | 9.5 | 3/8x19 | 60 | 38 | 33 | 22 |
| 1EC46-8-6 | 1EC48-8-6 | 10 | 3/8 | -6 | 9.5 | 1/2x14 | 60 | 38 | 36 | 27 |
| | 1EC48-6-8 | 12 | 1/2 | -8 | 12.7 | 3/8x19 | 63 | 39 | 41 | 22 |
| 1EC46-8-8 | 1EC48-8-8 | 12 | 1/2 | -8 | 12.7 | 1/2x14 | 63 | 40 | 40 | 27 |
| 1EC46-10-8 | 1EC48-10-8 | 12 | 1/2 | -8 | 12.7 | 5/8x14 | 63 | 40 | 39 | 30 |
| 1EC46-10-10 | 1EC48-10-10 | 16 | 5/8 | -10 | 15.9 | 5/8x14 | 70 | 45 | 44 | 30 |
| 1EC46-12-10 | | 16 | 5/8 | -10 | 15.9 | 3/4x14 | 70 | 45 | 42 | 32 |
| | 1EC48-12-10 | 16 | 5/8 | -10 | 15.9 | 3/4x14 | 70 | 45 | 42 | 32 |
| 1EC46-12-12 | 1EC48-12-12 | 19 | 3/4 | -12 | 19.1 | 3/4x14 | 79 | 54 | 55 | 32 |
| 1EC46-16-12 | 1EC48-16-12 | 19 | 3/4 | -12 | 19.1 | 1x11 | 80 | 54 | 59 | 41 |
| 1EC46-16-16 | 1EC48-16-16 | 25 | 1 | -16 | 25.4 | 1x11 | 105 | 75 | 71 | 41 |
| | 1EC48-20-20 | 31 | 1 1/4 | -20 | 31.8 | 1 1/4x11 | 129 | 82 | 75 | 50 |
| | 1EC48-24-24 | 38 | 1 1/2 | -24 | 38.1 | 1 1/2x11 | 140 | 102 | 103 | 55 |
| | 1EC48-32-32 | 51 | 2 | -32 | 50.8 | 2x11 | 185 | 137 | 132 | 70 |

Hose fittings are delivered with ozone resistant Nitrile (NBR) O-ring as a standard version. Working temperature from -40 °C up to +105 °C. Hose fittings with special O-rings (Viton or EPDM) available on request. O-ring dimensions and part-numbers see in section Eb.

Approved **fitting series** for **hose types**, depending on size: Also available in stainless steel. Details can be found in GAT 4400.1/UK

| | | | | | | | | | | | | | | | | | |
|----|-------|-----|-------|-------|-------|---------|-------|-------|------------|-----|-------|-------|------------|-------|-------|-----|-----|
| 46 | or | 48 | 441 | 461LT | 462 | 462TC | 462ST | 629PU | 692PU Twin | | | | | | | | |
| 46 | 463 | 492 | 492ST | 492TC | 692 | 692Twin | 692TC | BCH1 | | | | | | | | | |
| 48 | 301SN | 304 | 387 | 387ST | 387TC | 421RH | 421SN | 426 | 421TC | 436 | 441RH | 462PU | 462PU Twin | BCH2 | HT2 | ... | |
| | 471TC | 477 | 477ST | 477TC | 477RH | 487 | 487ST | 487TC | 493 | 787 | 787TC | 787ST | 797 | 797TC | 797ST | 811 | 881 |