

## Tube clamps

## Tube clamps series B (Twin-tube clamps) – Components

DIN 3015, part 3

Order codes for clamp halves:

Material	Interior surface	Order code
Polypropylene	grooved	RBP
	smooth	RBPG
Polyamide	grooved	RBN
	smooth	RBNG
Rubber	smooth	RBVG <sup>1)</sup>

(Please exchange as required standard abbreviation RBP in column for "clamp halves")

For flame- or corrosion retardant materials, please refer to page S5.

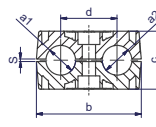
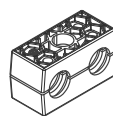

Width: 30 mm

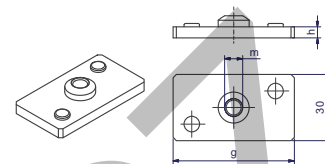

clamp size	Tube O.D. mm	Tube NB	Tube O.D.	1 part		weld plate with locking device						
				2 clamp halves <sup>2)</sup>	dimensions:	APB...	dimensions:					
				RBP... Order code	b	c	d	s	Order code	g	m	h
1	6.0	G 1/8	1/4 5/16 3/8	RBP106X	36	27.0	20	1.0	APB1...*	37	M6	3
	6.4			RBP106.4X								
	8.0			RBP108X								
	9.5			RBP109.5X								
	10.0			RBP110X								
	12.0			RBP112X								
2	12.7	G 1/4  G 3/8	1/2  5/8	RBP212.7X	53	27.4	29	1.2	APB2...*	55	M8	5
	13.5			RBP213.5X								
	14.0			RBP214X								
	15.0			RBP215X								
	16.0			RBP216X								
	17.2			RBP217.2X								
18.0	RBP218X											
3	19.0	G 1/2	3/4  1	RBP319X	67	37.0	36	1.6	APB3...*	70	M8	5
	20.0			RBP320X								
	21.3			RBP321.3X								
	22.0			RBP322X								
	25.0			RBP325X								
	25.4			RBP325.4X								
4	26.9	G 3/4	1 1/4	RBP426.9X	82	42.0	45	2.0	APB4...*	85	M8	5
	28.0			RBP428X								
	30.0			RBP430X								
5	32.0	G 1  G 1 1/4	1 1/4  1 1/2	RBP532X	106	54.0	56	2.0	APB5...*	110	M8	5
	33.7			RBP533.7X								
	35.0			RBP535X								
	38.0			RBP538X								
	40.0			RBP540X								
	42.0			RBP542X								

<sup>1)</sup> When assembling solid rubber clamps, cover plates, hexagon screws and locking washers must be used.

<sup>2)</sup> Twin-tube clamps with different outer tube diameters upon request.

\*Please add the suffix below according to the surface/material required.

Order code suffixes		
Surface/material	Suffix	Example
Steel, phosphated	X	APB1X
Steel, zinc plated, Cr(VI)-free	VZX	APB1VZX
Stainless Steel 1.4571	4571X	APB14571X

## Tube clamps series B (Twin-tube clamps) – Components

DIN 3015, part 3

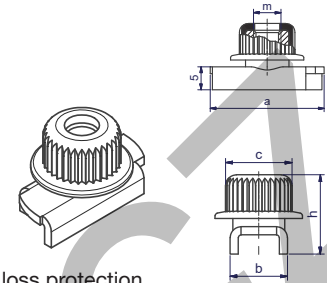
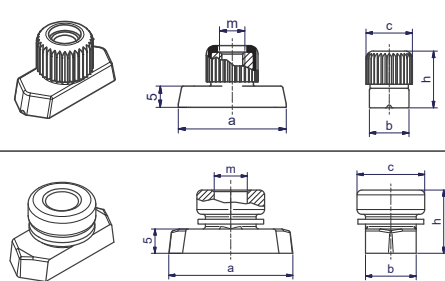
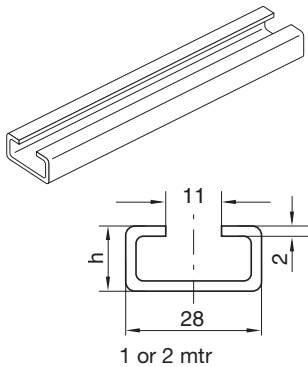
 With loss protection  
(See page S54).

clamp size	weld plate, angled		mounting rail nut						mounting rail nut					
	TS...A/B Order code	dimensions: h	TM Order code	dimensions:					TMA/TMB1... Order code	dimensions:				
				a	b	c	m	h		a	b	c	m	h
1			<b>TMA/TMB1VERZX</b> <b>TMA/TMB1/4571X</b>	25.4	10.4	12	M6	14.5	<b>TMA/TMB1WLPVZX</b> <b>TMA/TMB1WLP71X</b>	25.4	10.4	12	M6	14.5
2	<b>TS11A/B1...*</b> <b>TS11A/B2...*</b> <b>TS14A/B1...*</b> <b>TS14B/B2...*</b> <b>TS30A/B1...*</b> <b>TS30B/B2...*</b>	TS11: TS14: TS30:	<b>TMB2VZX</b> <b>TMB24571X</b>	25.4	10.4	14	M8	13.0						
3														
4														
5														

\*Please add the suffix below according to the surface/material required.

Order code suffixes		
Surface/material	Suffix	Example
Steel, phosphated	<b>X</b>	TS11A/B1X
Steel, zinc plated, Cr(VI)-free	<b>VZX</b>	TS11A/B1VZX
Stainless Steel 1.4571	<b>71X</b>	TS11A/B171X

**Tube clamps series B (Twin-tube clamps) – Components**

DIN 3015, part 3

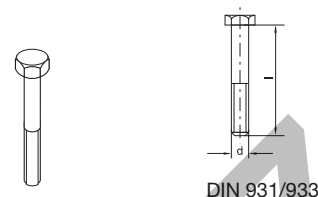
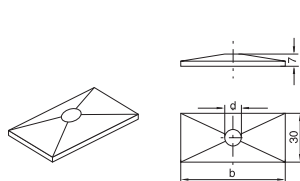
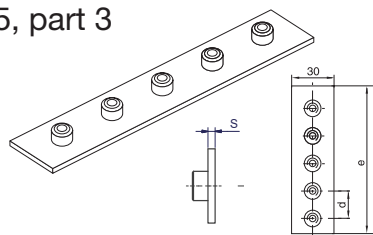

clamp size	weld plate angled (5 clamps)			cover plate		hexagonal screws			
	APR B... Order code	dimensions: d e s		DP B... Order code	dimensions: b d		SS B... Order code	dimensions: d x L	
1	APRB1X APRB1VZX APRB4571X	40	196	3	DPB1...*	34	6.6	SSLA2/SSB1...*	M 06x35
2	APRB2X APRB2VZX APRB24571X	58	288	5	DPB2...*	51	8.6	SSB2...*	M 08x35
3	APRB3X APRB3VZX APRB34571X	72	358	5	DPB3...*	64	8.6	SSB3...*	M 08x45
4	APRB4X APRB4VZX APRB44571X	90	446	5	DPB4...*	78	8.6	SSB4...*	M 08x50
5	APRB5X APRBVZX APRB4571X	112	558	5	DPB5...*	102	8.6	SSB5...*	M 08x60

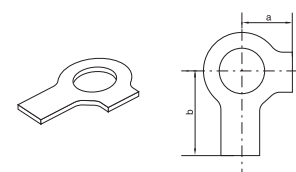
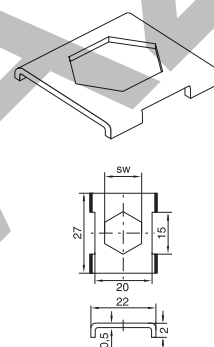
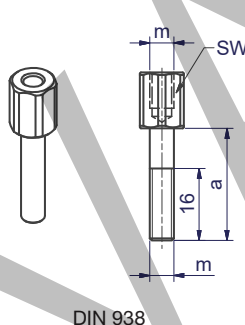
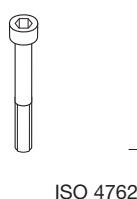

clamp size	socket head		stacking		locking plate <sup>1)</sup>		locking washer <sup>2)</sup>	
	IS B... Order code	dimensions: d x L	AS B... Order code	dimensions: a m SW	SB B... Order code	dim.: SW	US... Order code	dimensions: a b
1	ISA4...* (ISB1...*)	M 06x35	ASA0...* (ASB1...*)	20 M6 11	SBB1...*	11	USA/USB1X <sup>3)</sup>	9 18
2	ISB2...*	M 08x35	ASB2...*	22 M8 12	SBB2...*	12	USB2X USB271X	11 20
3	ISB3...*	M 08x45	ASB3...*	30 M8 12				
4	ISB4...*	M 08x50	ASB4...*	35 M8 12				
5	ISB5...*	M 08x60	ASB5...*	47 M8 12				

1) The use of stacking screws necessitates the use of locking plates in the construction assembly!

2) When assembling solid rubber clamps, covering plates, hexagon screws and locking washers must be used.

3) Material = Stainless steel 1.4571

\*Please add the suffix below according to the surface/material required.

Order code suffixes		
Surface/material	Suffix	Example
Steel, zinc plated, Cr(VI)-free	X	DPB1X
Stainless Steel 1.4571	71X	DPB14571X

## Tube clamps series B – Complete range

**Order codes for clamp halves:**

Material	Interior surface	Order code
Polypropylene	grooved	<b>RBP</b>
	smooth	<b>RBPG</b>
Polyamide	grooved	<b>RBN</b>
	smooth	<b>RBNG</b>
Rubber	smooth	<b>RBVG<sup>1)</sup></b>

(Please exchange as required standard abbreviation RBP in column for "Order code")

For flame- or corrosion retardant materials, please refer to page S5.

The steel parts of kits 1, 16 and 3 have the following surfaces:

Screws, bushes, cover plates = Cr(VI)-free galvanized

Welding plate = phosphated

Other compositions available on request.

2 clamp halves, weld plate, cover plate, hex. head bolt

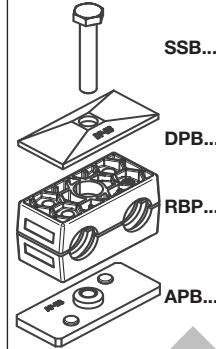

2 clamp halves, cover plate, hex. head bolt

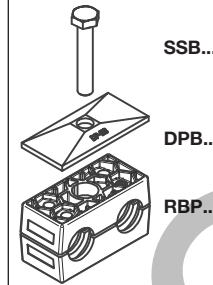

2 clamp halves, weld plate, cover plate, socket head bolt

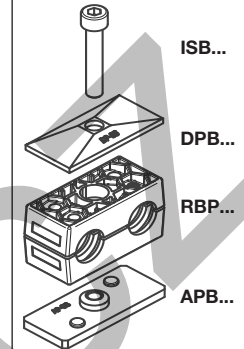

clamp size	Tube O.D. mm	Tube NB	Tube O.D.	Order code	Order code	Order code		
1	6.0	G 1/8	1/4	<b>RBP1-106</b>	<b>RBP16-106</b>	<b>RBP3-106</b>		
	6.4			<b>RBP1-106.4</b>	<b>RBP16-106.4</b>	<b>RBP3-106.4</b>		
	8.0			<b>RBP1-108</b>	<b>RBP16-108</b>	<b>RBP3-108</b>		
	9.5			<b>RBP1-109.5</b>	<b>RBP16-109.5</b>	<b>RBP3-109.5</b>		
	10.0			<b>RBP1-110</b>	<b>RBP16-110</b>	<b>RBP3-110</b>		
	12.0			<b>RBP1-112</b>	<b>RBP16-112</b>	<b>RBP3-112</b>		
2	12.7	G 1/4	1/2	<b>RBP1-212.7</b>	<b>RBP16-212.7</b>	<b>RBP3-212.7</b>		
	13.5			<b>RBP1-213.5</b>	<b>RBP16-213.5</b>	<b>RBP3-213.5</b>		
	14.0			<b>RBP1-214</b>	<b>RBP16-214</b>	<b>RBP3-214</b>		
	15.0			<b>RBP1-215</b>	<b>RBP16-215</b>	<b>RBP3-215</b>		
	16.0			<b>RBP1-216</b>	<b>RBP16-216</b>	<b>RBP3-216</b>		
	17.2			<b>RBP1-217.2</b>	<b>RBP16-217.2</b>	<b>RBP3-217.2</b>		
3	18.0	G 3/8	5/8	<b>RBP1-218</b>	<b>RBP16-218</b>	<b>RBP3-218</b>		
	19.0			G 1/2	3/4	<b>RBP1-319</b>	<b>RBP16-319</b>	<b>RBP3-319</b>
	20.0					<b>RBP1-320</b>	<b>RBP16-320</b>	<b>RBP3-320</b>
	21.3					<b>RBP1-321.3</b>	<b>RBP16-321.3</b>	<b>RBP3-321.3</b>
	22.0					<b>RBP1-322</b>	<b>RBP16-322</b>	<b>RBP3-322</b>
	25.0					<b>RBP1-325</b>	<b>RBP16-325</b>	<b>RBP3-325</b>
25.4	<b>RBP1-325.4</b>	<b>RBP16-325.4</b>	<b>RBP3-325.4</b>					
4	26.9	G 3/4	1	<b>RBP1-426.9</b>	<b>RBP16-426.9</b>	<b>RBP3-426.9</b>		
	28.0			<b>RBP1-428</b>	<b>RBP16-428</b>	<b>RBP3-428</b>		
	30.0			<b>RBP1-430</b>	<b>RBP16-430</b>	<b>RBP3-430</b>		
5	32.0	G 1	1 1/4	<b>RBP1-532</b>	<b>RBP16-532</b>	<b>RBP3-532</b>		
	33.7			<b>RBP1-533.7</b>	<b>RBP16-533.7</b>	<b>RBP3-533.7</b>		
	35.0			<b>RBP1-535</b>	<b>RBP16-535</b>	<b>RBP3-535</b>		
	38.0			<b>RBP1-538</b>	<b>RBP16-538</b>	<b>RBP3-538</b>		
	40.0			<b>RBP1-540</b>	<b>RBP16-540</b>	<b>RBP3-540</b>		
	42.0			<b>RBP1-542</b>	<b>RBP16-542</b>	<b>RBP3-542</b>		

**Delivery in unassembled individual components.**

<sup>1)</sup> When assembling solid rubber clamps, covering plates, hexagon screws and locking washers must be used.

## Tube clamps

## Tube clamps series B – Complete range

## Order codes for clamp halves:

Material	Interior surface	Order code
Polypropylene	grooved	RBP
	smooth	RBPG
Polyamide	grooved	RBN
	smooth	RBNG
Rubber	smooth	RBVG <sup>1)</sup>

(Please exchange as required standard abbreviation RBP in column for "Order code")

For flame- or corrosion retardant materials, please refer to page S5.

The steel parts of kits 4, 5 and 8 have the following surfaces:

Screws, bushes, cover plates = Cr(VI)-free galvanized

Welding plate = phosphated

Other compositions available on request.

2 clamp halves,  
rail nut, cover plate,  
hex. head bolt

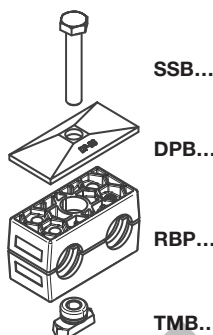

2 clamp halves,  
rail nut, cover plate,  
socket head bolt

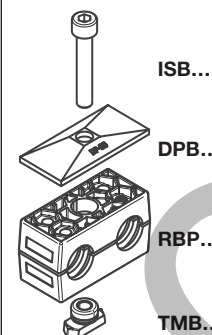

2 clamp halves,  
locking plate,  
stacking bolt

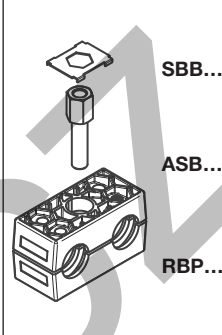

clamp size	Tube O.D. mm	Tube NB	Tube O.D.	Order code	Order code	Order code
1	6.0	G 1/8	1/4	RBP4-106	RBP5-106	RBP8-106
	6.4			RBP4-106.4	RBP5-106.4	RBP8-106.4
	8.0			RBP4-108	RBP5-108	RBP8-108
	9.5			RBP4-109.5	RBP5-109.5	RBP8-109.5
	10.0			RBP4-110	RBP5-110	RBP8-110
	12.0			RBP4-112	RBP5-112	RBP8-112
2	12.7	G 3/8	5/8	RBP4-212.7	RBP5-212.7	RBP8-212.7
	13.5			RBP4-213.5	RBP5-213.5	RBP8-213.5
	14.0			RBP4-214	RBP5-214	RBP8-214
	15.0			RBP4-215	RBP5-215	RBP8-215
	16.0			RBP4-216	RBP5-216	RBP8-216
	17.2			RBP4-217.2	RBP5-217.2	RBP8-217.2
18.0	RBP4-218	RBP5-218	RBP8-218			
3	19.0	G 1/2	1	RBP4-319	RBP5-319	RBP8-319
	20.0			RBP4-320	RBP5-320	RBP8-320
	21.3			RBP4-321.3	RBP5-321.3	RBP8-321.3
	22.0			RBP4-322	RBP5-322	RBP8-322
	25.0			RBP4-325	RBP5-325	RBP8-325
	25.4			RBP4-325.4	RBP5-325.4	RBP8-325.4
4	26.9	G 3/4	1 1/4	RBP4-426.9	RBP5-426.9	RBP8-426.9
	28.0			RBP4-428	RBP5-428	RBP8-428
	30.0			RBP4-430	RBP5-430	RBP8-430
5	32.0	G 1	1 1/2	RBP4-532	RBP5-532	RBP8-532
	33.7			RBP4-533.7	RBP5-533.7	RBP8-533.7
	35.0			RBP4-535	RBP5-535	RBP8-535
	38.0			RBP4-538	RBP5-538	RBP8-538
	40.0			RBP4-540	RBP5-540	RBP8-540
	42.0			RBP4-542	RBP5-542	RBP8-542

## Delivery in unassembled individual components.

<sup>1)</sup> When assembling solid rubber clamps, covering plates, hexagon screws and locking washers must be used.