

## 6300 LIQUIfit® Cartridge

Inch

Brass, EPDM

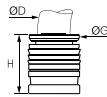

ØD		G	G1	H	L	Kg
1/4	<b>6300 56 00</b>	10.5	14.5	12.5	600	0.002
3/8	<b>6300 60 00</b>	15.5	19	17	930	0.005
1/2	<b>6300 62 00</b>	22	25	23	1038	0.011

50 cartridges per Carstick®  
5/32" (4 mm) and 5/16" (8 mm) also available.

Please consult us for detailed drawings of cavity dimensions and tolerances

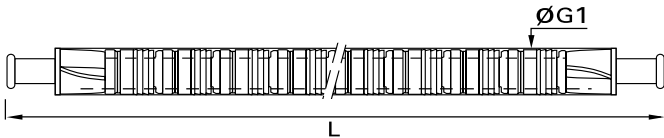

## 6579 Fixed Elbow, Male BSPT Thread

Bio-based polymer, EPDM

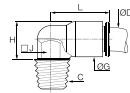

ØD	C		G	H	J	L	Kg
6	R1/8	<b>6579 06 10WP2</b>	11	14	10	19	0.002
	R1/4	<b>6579 06 13WP2</b>	11	14	10	19	0.003
	R3/8	<b>6579 06 17WP2</b>	11	14	10	19	0.004

Thread without pre-coating.

## 6579 Fixed Elbow, Male NPTF Thread

Inch

Bio-based polymer, EPDM

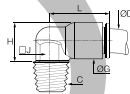

ØD	C		G	H	J	L	Kg
1/4	NPT1/8	<b>6579 56 11WP2</b>	11	22	38	18	0.009
	NPT1/4	<b>6579 56 14WP2</b>	11	26	38	18	0.003
	3/8	NPT1/4	<b>6579 60 14WP2</b>	16	32	12	26

Thread without pre-coating.

## 6579 Fixed Elbow, Male BSPT Thread

Inch

Bio-based polymer, EPDM

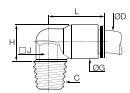

ØD	C		G	H	J	L	Kg
1/4	R1/4	<b>6579 56 13WP2</b>	11	26	10	18	0.003
3/8	R3/8	<b>6579 60 17WP2</b>	16	32	13	26	0.006

Thread without pre-coating.

## 6599 Stud Elbow, Male BSPP Thread

POM, EPDM



ØD	C		E	F	G	H	Kg
6	G1/8	<b>6599 06 10WP2</b>	6	17	15	24.5	0.007
	G1/4	<b>6599 06 13WP2</b>	8.5	18	15	33	0.008
	G1/8	<b>6599 08 10WP2</b>	6	18	17.5	26	0.010
8	G1/4	<b>6599 08 13WP2</b>	8.5	18	17.5	26	0.011
	G3/8	<b>6599 08 17WP2</b>	9	22	17.5	26	0.012
	G1/4	<b>6599 10 13WP2</b>	8.5	22	20	29.5	0.015
10	G3/8	<b>6599 10 17WP2</b>	9	22	20	29.5	0.015
	G1/2	<b>6599 10 21WP2</b>	12.5	26	20	29.5	0.019
	G3/8	<b>6599 12 17WP2</b>	9	26	23	34.5	0.023
12	G1/2	<b>6599 12 21WP2</b>	12.5	26	23	34.5	0.025

Collet technology

Thread without pre-coating; the body swivels for positioning purposes.

NSF certified fitting only

## 6509 Stud Elbow, Male BSPT Thread

Bio-based polymer, EPDM

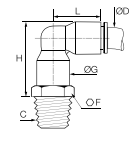

ØD	C		F	G	H	L	Kg
6	R1/8	<b>6509 06 10WP2</b>	13	10.5	28	24	0.037
	R1/4	<b>6509 06 13WP2</b>	14	10.5	28	24	0.007
	R3/8	<b>6509 06 17WP2</b>	17	10.5	28	24	0.008
8	R1/8	<b>6509 08 10WP2</b>	19	13.5	34	29.5	0.010
	R1/4	<b>6509 08 13WP2</b>	19	13.5	34	29.5	0.011
	R3/8	<b>6509 08 17WP2</b>	19	13.5	34	29.5	0.011
10	R1/4	<b>6509 10 13WP2</b>	19	16	38	34.5	0.019
	R3/8	<b>6509 10 17WP2</b>	19	16	38	34.5	0.020
	R1/2	<b>6509 10 21WP2</b>	22	16	38	34.5	0.023
12	R3/8	<b>6509 12 17WP2</b>	22	19	44	40	0.022
	R1/2	<b>6509 12 21WP2</b>	22	19	44	40	0.024

Thread without pre-coating; the body swivels for positioning purposes.

## 6509 Stud Elbow, Male NPTF Thread

Inch

Bio-based polymer, EPDM

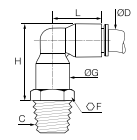

ØD	C		F	G	H	L	Kg
1/4	NPT1/8	<b>6509 56 11WP2</b>	1/2	11	28	23.5	0.003
	NPT1/4	<b>6509 56 14WP2</b>	9/16	11	28	23.5	0.004
	NPT3/8	<b>6509 56 18WP2</b>	3/4	11	28.5	23.5	0.006

Thread without pre-coating; the body swivels for positioning purposes.