

6382 Equal and Unequal Plug-In Elbow

Bio-based polymer, EPDM

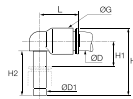

ØD	ØD1		G	H	H1	H2	L	Kg
4	4	6382 04 00WP2	8.5	23	6	15.5	15	0.003
	6	6382 04 06WP2	10.5	26.5	7	17	16.5	0.002
	6	6382 06 00WP2	10.5	26.5	7	17	17	0.003
6	4	6382 06 04WP2	10.5	25	7	15.5	17	0.001
	8	6382 06 08WP2	13.5	33.5	8	21.5	22.5	0.004
8	8	6382 08 00WP2	13.5	33.5	8	21.5	22.5	0.004
	10	6382 08 10WP2	16	39	9.5	24.5	26	0.007
10	10	6382 10 00WP2	16	39	9.5	24.5	26.5	0.004
	12	6382 10 12WP2	19	44.5	10	27	30	0.011
12	12	6382 12 00WP2	19	44.5	10	27	31	0.012

The references in diameter 4mm and 12mm are not grooved in standard version

6383 Plug-In Equal Run Tee

Bio-based polymer, EPDM

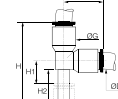

ØD	ØD1		G	H	H1	H2	L	Kg
4	4	6383 04 00WP2	8.5	33	6	15.5	15	0.002
6	6	6383 06 00WP2	10.5	38.5	7	17	18	0.002
8	8	6383 08 00WP2	13.5	49	8	21.5	23	0.005
10	10	6383 10 00WP2	16	57	10.5	25.5	26.5	0.012

6382 Equal and Unequal Plug-In Elbow

Inch

Bio-based polymer, EPDM

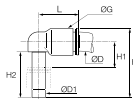

ØD	ØD1		G	H	H1	H2	L	Kg
5/16	3/8	6382 08 60WP2	16	39	10	24.5	26	0.009
1/4	1/4	6382 56 00WP2	11	30.5	11	18	18	0.002
	3/8	6382 56 60WP2	16	39	9	24.5	25.5	0.006
3/8	3/8	6382 60 00WP2	16	39	9	24.5	26.5	0.005
1/2	1/2	6382 62 00WP2	22	49	13	28.5	36	0.004

Equal plug-in elbow: 5/32" (4 mm) and 5/16" (8 mm) also available
The references in diameter 4mm and 12mm are not grooved in standard version

6388 Plug-In Equal Branch Tee

Bio-based polymer, EPDM

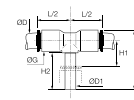

ØD	ØD1		G	H	H1	H2	L/2	Kg
4	4	6388 04 00WP2	8.5	25	6	15.5	15	0.005
6	6	6388 06 00WP2	10.5	28.5	7	17	16	0.006
8	8	6388 08 00WP2	13.5	33.5	8	21.5	23	0.005
10	10	6388 10 00WP2	16	41	9.5	24.5	26.5	0.007

6380 Plug-In 45° Equal Elbow

Bio-based polymer, EPDM

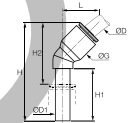

ØD	ØD1		G	H	H1	H2	L	Kg
4	4	6380 04 00WP2	8.5	33.5	19	21	13	0.001
6	6	6380 06 00WP2	11	39	21	25	14.5	0.002
8	8	6380 08 00WP2	13.5	44	21.5	25.5	19.5	0.006
10	10	6380 10 00WP2	16	53	27	32.5	23	0.004
12	12	6380 12 00WP2	19	58	27	34	26	0.012

6388 Plug-In Branch Tee

Inch

Bio-based polymer, EPDM

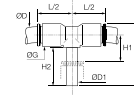

ØD	ØD1		G	H	H1	H2	L/2	Kg
1/4	1/4	6388 56 00WP2	11	30.5	11	20	18	0.002
3/8	3/8	6388 60 00WP2	16	42	12	25	25	0.008

5/32" (4 mm) and 5/16" (8 mm) also available.
For rotary applications, we recommend the use of a special grooved version, available upon request.