

6352 Stud Fitting Flat Type, Female BSPP Thread Inch

Bio-based polymer, EPDM

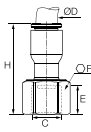

| ØD | C | | E | F | H | Kg |
|-----|------|----------------------|----|----|----|-------|
| 3/8 | G3/8 | 6352 60 17WP2 | 12 | 22 | 36 | 0.008 |
| | G1/2 | 6352 60 21WP2 | 12 | 27 | 36 | 0.011 |

6325 Faucet Connector, Female UNS Thread Inch

Bio-based polymer, EPDM

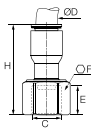

| ØD | C | | E | F | H | Kg |
|-----|------------|-----------------------|---|------|----|-------|
| 1/4 | UNS7/16-24 | 6325 56 133WP2 | 7 | 9/16 | 31 | 0.002 |

6521 Stud Standpipe, Male BSPT Thread

Bio-based polymer

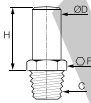

| ØD | C | | F | H | Kg |
|----|------|----------------------|----|----|-------|
| 6 | R1/8 | 6521 06 10WP2 | 13 | 19 | 0.002 |
| | R1/4 | 6521 06 13WP2 | 14 | 19 | 0.003 |
| | R3/8 | 6521 06 17WP2 | 17 | 19 | 0.004 |
| 8 | R1/8 | 6521 08 10WP2 | 19 | 23 | 0.003 |
| | R1/4 | 6521 08 13WP2 | 19 | 23 | 0.004 |
| | R3/8 | 6521 08 17WP2 | 19 | 23 | 0.004 |
| 10 | R1/4 | 6521 10 13WP2 | 19 | 25 | 0.004 |
| | R3/8 | 6521 10 17WP2 | 19 | 25 | 0.005 |
| | R1/2 | 6521 10 21WP2 | 22 | 25 | 0.008 |
| 12 | R3/8 | 6521 12 17WP2 | 22 | 28 | 0.005 |
| | R1/2 | 6521 12 21WP2 | 22 | 28 | 0.007 |

Thread without pre-coating.

6521 Stud Standpipe, Male NPTF Thread Inch

Bio-based polymer

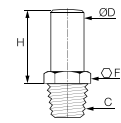

| ØD | C | | F | H | Kg |
|-----|--------|----------------------|-----|----|-------|
| 3/8 | NPT1/4 | 6521 60 14WP2 | 3/4 | 25 | 0.004 |
| | NPT3/8 | 6521 60 18WP2 | 3/4 | 25 | 0.004 |

Thread without pre-coating.

6521 Stud Standpipe, Male BSPT Thread Inch

Bio-based polymer

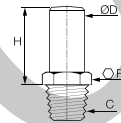

| ØD | C | | F | H | Kg |
|-----|------|----------------------|----|----|-------|
| 1/4 | R1/8 | 6521 56 10WP2 | 14 | 19 | 0.002 |
| | R1/4 | 6521 56 13WP2 | 14 | 19 | 0.002 |
| | R3/8 | 6521 56 17WP2 | 17 | 19 | 0.004 |
| 3/8 | R3/8 | 6521 60 17WP2 | 19 | 25 | 0.004 |

Thread without pre-coating.
5/16" (8mm) also available.

6300 LIQUIfit® Cartridge

Brass, EPDM

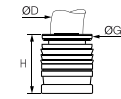

| ØD | | G | G1 | H | L | Kg |
|----|-------------------|------|------|------|------|-------|
| 4 | 6300 04 00 | 8 | 11 | 10 | 554 | 0.002 |
| 6 | 6300 06 00 | 10 | 14.5 | 11.5 | 629 | 0.002 |
| 8 | 6300 08 00 | 13 | 15 | 15 | 794 | 0.003 |
| 10 | 6300 10 00 | 15.5 | 19.5 | 17 | 930 | 0.005 |
| 12 | 6300 12 00 | 18.5 | 21 | 19.5 | 1038 | 0.010 |

50 cartridges per Carstick®

Please consult us for detailed drawings of cavity dimensions and tolerances

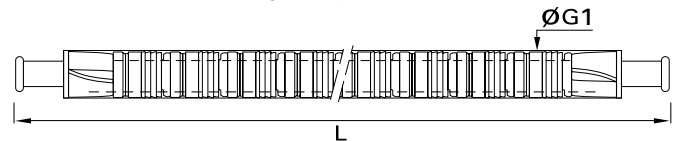

Sealing Profile for Female Thread Stud Fitting

Stud Fitting,
Female NPTF Thread
6315

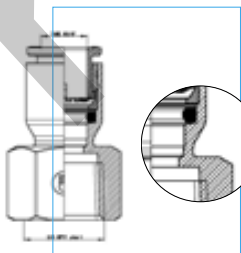

Stud Fitting Flat Type,
Female BSPP Thread,
6352

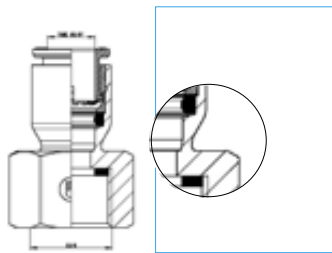

6300 Carstick+ Cartridge EPDM



| ØD | | G | G1 | H | L | kg |
|----|----------------------|-----|------|------|-----|-------|
| 4 | 6300 04 01 24 | 8.1 | 10.3 | 10.4 | 520 | 0.001 |
| 6 | 6300 06 01 24 | 9.9 | 15.3 | 11.8 | 590 | 0.002 |

6300 Carstick+ Cartridge FKM



| ØD | | G | G1 | H | L | kg |
|----|----------------------|-----|------|------|-----|-------|
| 4 | 6300 04 01 26 | 8.1 | 10.3 | 10.4 | 520 | 0.001 |
| 6 | 6300 06 01 26 | 9.9 | 15.3 | 11.8 | 590 | 0.002 |