

6366 Plug-In Reducer

Bio-based polymer, EPDM

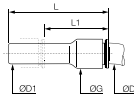

ØD	ØD1		G	L	L1	Kg
4	6	6366 04 06WP2	8.5	38	23.5	0.004
	8	6366 04 08WP2	8.5	38	19	0.004
6	8	6366 06 08WP2	10.5	38	20	0.004
	10	6366 06 10WP2	10.5	39	17.5	0.002
8	10	6366 08 10WP2	13.5	48.5	28.5	0.009
	12	6366 08 12WP2	13.5	48.5	24.5	0.004
10	12	6366 10 12WP2	16	52	33.5	0.005
	14	6366 10 14WP2	16	53	33.5	0.005

6366 Plug-In Reducer

Inch

Bio-based polymer, EPDM

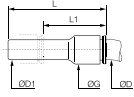

ØD	ØD1		G	L	L1	Kg
1/4	5/16	6366 56 08WP2	11	41	22.5	0.015
	3/8	6366 56 60WP2	11	41	20.5	0.002
5/16	3/8	6366 08 60WP2	13.5	48.5	29	0.003
	1/2	6366 08 62WP2	16	48.5	22	0.007
3/8	1/2	6366 60 62WP2	16	51	30	0.011

6368 Plug-In Increaser

Inch

Bio-based polymer, EPDM

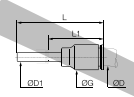

ØD	ØD1		G	L	L1	Kg
3/8	5/16	6368 60 08WP2	16	44	25.5	0.004

6326 Blanking Plug

Bio-based polymer

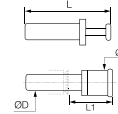

ØD		G	L	L1	Kg
4	6326 04 00WP2	6	30	15.5	0.002
6	6326 06 00WP2	8	33	16.5	0.002
8	6326 08 00WP2	10	35	17.5	0.002
10	6326 10 00WP2	12	42	21	0.003
12	6326 12 00WP2	14	45	22	0.004

6326 Blanking Plug

Inch

Bio-based polymer

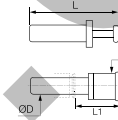

ØD		G	L	L1	Kg
1/4	6326 56 00WP2	8	36.5	22	0.002
3/8	6326 60 00WP2	11.6	42.5	22	0.002
1/2	6326 62 00WP2	14.7	48.5	21.5	0.004

5/32" (4 mm) and 5/16" (8 mm) also available

6322 Plug-In Barb Connector

Bio-based polymer

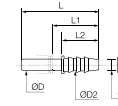

ØD	ØD1	ØD2		L	L1	L2	Kg
6	4	6	6322 06 04WP2	39	25	17	0.004
8	6	8	6322 08 06WP2	43	25	17	0.005
10	7	9	6322 10 07WP2	50	29.5	22	0.006
12	12.5	15.5	6322 12 62WP2	56	32	27.5	0.004

6322 Plug-In Barb Connector

Inch

Bio-based polymer

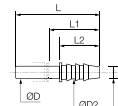

ØD	ØD1	ØD2		L	L1	L2	Kg
1/4	0.28	0.32	6322 56 56WP2	39	24.5	17	0.001
	0.33	0.38	6322 60 08WP2	50	29.5	22	0.002
3/8	0.28	0.32	6322 60 56WP2	45	24.5	17	0.008
	0.40	0.45	6322 60 60WP2	50	29	22	0.002
1/2	0.40	0.45	6322 62 60WP2	58	37.5	30	0.005