

## 6316 Equal Bulkhead Union

Bio-based polymer, EPDM

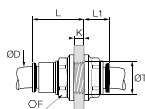

ØD		F	K max	L	L1	ØT min	Kg
4	<b>6316 04 00WP2</b>	13	5.5	15.5	10.5	10.5	0.018
6	<b>6316 06 00WP2</b>	15	8.5	20	10	12.5	0.004
8	<b>6316 08 00WP2</b>	18	14.5	27	10.5	15.5	0.007
10	<b>6316 10 00WP2</b>	22	14.5	30	13	18.5	0.012
12	<b>6316 12 00WP2</b>	26	18.5	35	15.5	22.5	0.020

## 6316 Bulkhead Union

Inch

Bio-based polymer, EPDM

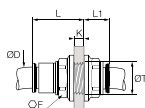

ØD		F	K max	L	L1	ØT min	Kg
1/4	<b>6316 56 00WP2</b>	15	8.5	20	10	12.5	0.004
3/8	<b>6316 60 00WP2</b>	22	14.5	29.5	12.5	18.5	0.012
1/2	<b>6316 62 00WP2</b>	29	20.5	40.5	17	25.5	0.030

5/32" (4mm) and 5/16" (8mm) also available

## 6976 Bulkhead Union

Stainless steel 316L, EPDM

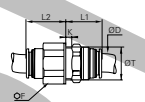

ØD		F	K max	L1	L2	ØT min	Kg
16	<b>6976 16 00</b>	32	10.5	33	30	27.5	0.166

Electrical protection/class IP55

## Complementary LIQUIfit® Range Products

The other LIQUIfit® range products are presented in the corresponding chapters of this catalogue:

**Technical Tubing and Hose**

**Advanced PE**



**Function Fittings**

**Non-Return Valves**



**Industrial Ball Valves**

**LIQUIfit® Ball Valves**

