

LF 3600 Push-In Fittings / Plug-In Accessories

3666 Plug-In Reducer

FDA chemical Nickel-plated brass, FKM

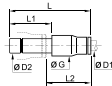

ØD1	ØD2		G	L	L1	L2	Kg
4	6	3666 04 06	10	35	19.5	18	0.008
	8	3666 04 08	10	35.5	20	18	0.009
6	8	3666 06 08	12	38	20	20.5	0.012
	10	3666 06 10	12	43.5	25	21	0.015
8	10	3666 08 10	15	44	25	21.5	0.016
	12	3666 08 12	15	44	26	20.5	0.018
10	12	3666 10 12	17.5	50	26	27	0.026
12	14	3666 12 14	19.5	53	28	28.5	0.032

3667 Plug-In Metric/Inch Adaptor

FDA chemical Nickel-plated brass, FKM

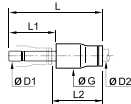

ØD1	ØD2		G	L	L1	L2	Kg
6	1/4	3667 06 56	12.5	38.5	19.5	21	0.012
10	3/8	3667 10 60	17	49.5	25	27	0.026
12	1/2	3667 12 62	20	51	26	27.5	0.030

3668 Plug-In Increaser

FDA chemical Nickel-plated brass, FKM

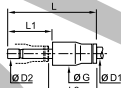

ØD1	ØD2		G	L	L1	L2	Kg
6	4	3668 06 04	12	36	17	21.5	0.010

3622 Plug-In Barb Connector

FDA chemical Nickel-plated brass

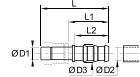

ØD1	ØD2	ØD3		L	L1	L2	Kg
4	3.2	5	3622 04 53	40.5	27	22.5	0.003
	5	7	3622 04 05	40.5	27	22.5	0.005
6	5	7	3622 06 05	43	27	22.5	0.006
8	6.3	8.3	3622 08 56	42	25	22.5	0.008
	8	10	3622 08 08	44	27	22.5	0.010
10	6.3	8.3	3622 10 56	47.5	25.5	22.5	0.011
	8	10	3622 10 08	47.5	25.5	22.5	0.011
12	8	10	3622 12 08	48.5	25.5	22.5	0.015
	10	12	3622 12 10	48.5	25.5	22.5	0.014
14	12.5	14.5	3622 14 62	57	34	29.5	0.019
	12.5	14.5	3622 14 62	57.5	33	29.5	0.022
14	14	16	3622 14 14	59.5	35	29.5	0.023

3620 Male Stem Connector

FDA chemical Nickel-plated brass

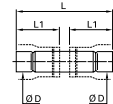

ØD		L	L1	Kg
4	3620 04 00	31	14	0.002
6	3620 06 00	36.5	17	0.005
8	3620 08 00	37.5	17.5	0.007
10	3620 10 00	47.5	22.5	0.011
12	3620 12 00	49.5	23.5	0.015
14	3620 14 00	53	25	0.016

3626 Blanking Plug

FDA chemical Nickel-plated brass

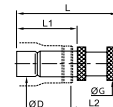

ØD		G	L	L1	L2	Kg
4	3626 04 00	6	25.5	17.5	11.5	0.004
6	3626 06 00	8	30.5	19.5	13.5	0.009
8	3626 08 00	10	33	20	16	0.009
10	3626 10 00	12	40	25	18	0.015
12	3626 12 00	14	43	26	20	0.021
14	3626 14 00	16	47	28	22.5	0.029