

# LF 3600 Push-In Fittings / Plug-In Accessories

## 3666 Plug-In Reducer

FDA chemical Nickel-plated brass, FKM

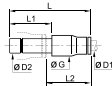

ØD1	ØD2		G	L	L1	L2	Kg
4	6	<b>3666 04 06</b>	10	35	19.5	18	0.008
	8	<b>3666 04 08</b>	10	35.5	20	18	0.009
6	8	<b>3666 06 08</b>	12	38	20	20.5	0.012
	10	<b>3666 06 10</b>	12	43.5	25	21	0.015
8	10	<b>3666 08 10</b>	15	44	25	21.5	0.016
	12	<b>3666 08 12</b>	15	44	26	20.5	0.018
10	12	<b>3666 10 12</b>	17.5	50	26	27	0.026
12	14	<b>3666 12 14</b>	19.5	53	28	28.5	0.032

## 3667 Plug-In Metric/Inch Adaptor

FDA chemical Nickel-plated brass, FKM

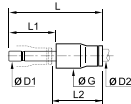

ØD1	ØD2		G	L	L1	L2	Kg
6	1/4	<b>3667 06 56</b>	12.5	38.5	19.5	21	0.012
10	3/8	<b>3667 10 60</b>	17	49.5	25	27	0.026
12	1/2	<b>3667 12 62</b>	20	51	26	27.5	0.030

## 3668 Plug-In Increaser

FDA chemical Nickel-plated brass, FKM

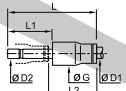

ØD1	ØD2		G	L	L1	L2	Kg
6	4	<b>3668 06 04</b>	12	36	17	21.5	0.010

## 3622 Plug-In Barb Connector

FDA chemical Nickel-plated brass

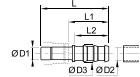

ØD1	ØD2	ØD3		L	L1	L2	Kg
4	3.2	5	<b>3622 04 53</b>	40.5	27	22.5	0.003
	5	7	<b>3622 04 05</b>	40.5	27	22.5	0.005
6	5	7	<b>3622 06 05</b>	43	27	22.5	0.006
	6.3	8.3	<b>3622 08 56</b>	42	25	22.5	0.008
8	8	10	<b>3622 08 08</b>	44	27	22.5	0.010
	6.3	8.3	<b>3622 10 56</b>	47.5	25.5	22.5	0.011
10	8	10	<b>3622 10 08</b>	47.5	25.5	22.5	0.011
	8	10	<b>3622 12 08</b>	48.5	25.5	22.5	0.015
12	10	12	<b>3622 12 10</b>	48.5	25.5	22.5	0.014
	12.5	14.5	<b>3622 12 62</b>	57	34	29.5	0.019
14	12.5	14.5	<b>3622 14 62</b>	57.5	33	29.5	0.022
	14	16	<b>3622 14 14</b>	59.5	35	29.5	0.023

## 3620 Male Stem Connector

FDA chemical Nickel-plated brass

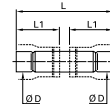

ØD		L	L1	Kg
4	<b>3620 04 00</b>	31	14	0.002
6	<b>3620 06 00</b>	36.5	17	0.005
8	<b>3620 08 00</b>	37.5	17.5	0.007
10	<b>3620 10 00</b>	47.5	22.5	0.011
12	<b>3620 12 00</b>	49.5	23.5	0.015
14	<b>3620 14 00</b>	53	25	0.016

## 3626 Blanking Plug

FDA chemical Nickel-plated brass

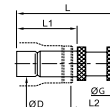

ØD		G	L	L1	L2	Kg
4	<b>3626 04 00</b>	6	25.5	17.5	11.5	0.004
6	<b>3626 06 00</b>	8	30.5	19.5	13.5	0.009
8	<b>3626 08 00</b>	10	33	20	16	0.009
10	<b>3626 10 00</b>	12	40	25	18	0.015
12	<b>3626 12 00</b>	14	43	26	20	0.021
14	<b>3626 14 00</b>	16	47	28	22.5	0.029