

# LF 3000® Push-In Fittings / Banjo Fittings

## 3124 Single Banjo, Male/Female BSPP and Metric Thread

Technical polymer, Nickel-plated brass, NBR

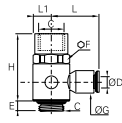

ØD	C		E	F	G	H	L	L1	Kg
4	G1/8	<b>3124 04 10</b>	4	13	8.5	25.5	18.5	7	0.015
6	G1/4	<b>3124 06 13</b>	5.5	17	10.5	33	22	9	0.029
8	G3/8	<b>3124 08 17</b>	5.5	20	13.5	37.5	29	11	0.043

This product family was developed to allow assembly of a function fitting on a cylinder.

## 3538 Single Banjo Bodies

Technical polymer, NBR

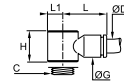

ØD	C		G	H	L	L1	Kg
4	M5x0.8	<b>3538 04 19</b>	8.5	13	16	5	0.001
	G1/8	<b>3538 04 10</b>	10.5	14.5	18.5	7	0.002
6	M5x0.8	<b>3538 06 19</b>	11	18	18.5	5	0.002
	G1/8	<b>3538 06 10</b>	10.5	14.5	20	7	0.002
8	G1/4	<b>3538 06 13</b>	13.5	18	22	9.5	0.003
	G1/8	<b>3538 08 10</b>	13.5	14.5	25	7	0.003
8	G1/4	<b>3538 08 13</b>	13.5	18	27	9.5	0.004
	G3/8	<b>3538 08 17</b>	13.5	21.5	29	11.5	0.005
10	G1/4	<b>3538 10 13</b>	16	18	29	9.5	0.005
	G3/8	<b>3538 10 17</b>	16	21.5	31	11.5	0.006
12	G3/8	<b>3538 12 17</b>	19	21.5	34.5	11.5	0.008

## 3149 Twin Banjo, Male BSPP and Metric Thread

Technical polymer, Nickel-plated brass, NBR

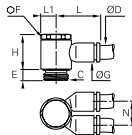

ØD	C		E	F	G	H	L	L1	N	Kg
4	M5x0.8	<b>3149 04 19*</b>	4		8.5	13	16	4.5	9	0.005
	G1/8	<b>3149 04 10</b>	4	13	10.5	16.5	18.5	7	11.5	0.018
6	G1/8	<b>3149 06 10</b>	4	13	10.5	16.5	18.5	7	11.5	0.014
	G1/4	<b>3149 06 13</b>	5.5	17	13.5	21	27	9.5	14.5	0.035
8	G1/4	<b>3149 08 13</b>	5.5	17	13.5	21	27	9.5	14.5	0.026
	G3/8	<b>3149 08 17</b>	5.5	20	16	24.5	31	11	17	0.053
10	G3/8	<b>3149 10 17</b>	5.5	20	16	24.5	31	11	17	0.042

\*With screwdriver slot

## 3539 Double Banjo Bodies

Technical polymer, NBR

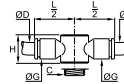

ØD	C		G	H	L/2	Kg
6	G1/8	<b>3539 06 10</b>	10.5	14.3	20	0.011
	G1/4	<b>3539 06 13</b>	13.5	18	26	0.015
8	G1/4	<b>3539 08 13</b>	13.5	18	27	0.005
	G3/8	<b>3539 08 17</b>	16	21.5	30.5	0.020
10	G3/8	<b>3539 10 17</b>	16	21.5	31	0.008

## 3119 Double Banjo, BSPP and Metric Thread

Technical polymer, Nickel-plated brass, NBR

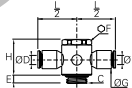

ØD	C		E	F	G	H	L/2	Kg
4	M5x0.8	<b>3119 04 19*</b>	4		8.5	13	8	0.005
	G1/8	<b>3119 06 10</b>	4	13	11	17	20	0.014
6	G1/4	<b>3119 06 13</b>	5.5	17	13.5	21	26.5	0.035
	G1/4	<b>3119 08 13</b>	5.5	17	13.5	21	27	0.026
8	G3/8	<b>3119 08 17</b>	5.5	20	16	24.5	30.5	0.053

\*With screwdriver slot

## 3549 Twin Banjo Bodies

Technical polymer, NBR

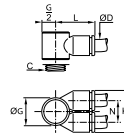

ØD	C		G	K	L	N	Kg
4	M5x0.8	<b>3549 04 19</b>	10	17.5	15.5	9	0.003
	G1/4	<b>3549 04 13</b>	18.5	28	25	14.5	0.020
6	G1/8	<b>3549 06 10</b>	14	22.5	20.5	12	0.003
	G1/4	<b>3549 06 13</b>	18.5	28	25	14.5	0.015
6	G3/8	<b>3549 06 17</b>	22.5	33	28.5	17	0.031
	G1/4	<b>3549 08 13</b>	18.5	28	26	14.5	0.006
8	G3/8	<b>3549 08 17</b>	22.5	33	29.5	17	0.020
	G3/8	<b>3549 10 17</b>	22.5	33	29.5	17	0.009