

2648N – Ultra-high pressure hose

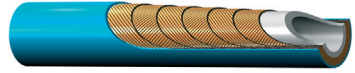

CONSTRUCTION

- Core tube** : Polyamide
- Pressure reinforcement** : Six spiral layers of maximum tensile steel wire
- Cover** : Polyamide
- Standard colour** : Blue

TEMPERATURE RANGE -10°C up to +70°C

#	Ø				Ø		Ø		Ø		Ø	
	DN	size	mm	inch	mm	MPa	psi	MPa	psi	mm	kg/m	
2648N-12V32	20	-12	19.8	3/4	33.7	160	23200	400	58000	350	2.28	
2648N-16V32	25	-16	25.0	1	40.8	150	21750	375	54375	400	3.10	



NOTES -

1C9JX / 1C9CX – Metric female swivel heavy series with O-ring

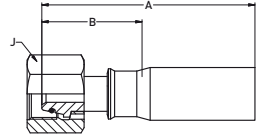

MATERIAL Nipple: very high strength stainless steel
Shell and nut: high strength carbon steel, zinc plated

#	⊙				📏	A	B	J	↻		Nipple ID	Ferrule OD
	DN	size	mm	inch					MPa	psi		
1C9JX-25-12W	20	-12	19.0	3/4	M36x2	108	50	46	160	23200	12.5	40.6
1C9CX-30-16W	25	-16	25.4	1	M42x2	121	55	55	150	21750	17.3	49.0

1AYJX / 1AYCX – Type “M” female swivel

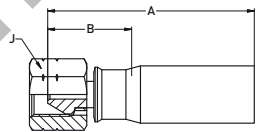

MATERIAL Nipple: very high strength stainless steel
Shell and nut: high strength carbon steel, zinc plated

#	⊙				📏	A	B	J	↻		Nipple ID	Ferrule OD
	DN	size	mm	inch					MPa	psi		
1AYJX-16-12W	20	-12	19.0	3/4	1 5/16-12UNF	90	31	41	160	23200	12.5	40.6
1AYCX-16-16	25	-16	25.4	1	1 5/16-12UNF	146	72	41	138	20000	17.3	49.0

1Y2JX / 1Y2CX – Medium pressure tube nipple

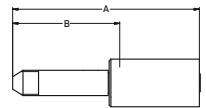

MATERIAL Nipple: very high strength stainless steel
Shell: high strength carbon steel, zinc plated

#	⊙				📏	A	B	↻		Nipple ID	Ferrule OD
	DN	size	mm	inch				MPa	psi		
1Y2JX-16-12W	20	-12	19.0	3/4	1-14 UNS LH	133	75	138	20000	12.5	40.6
1Y2CX-16-16	25	-16	25.4	1	1-14 UNS LH	146	72	138	20000	17.3	49.0

Design Factor >2:1