

2448D-TOUGH COVER – Ultra-high pressure hose

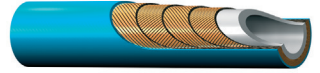







CONSTRUCTION

- Core tube** : Polyoxymethylene
- Pressure reinforcement** : Four spiral layers of maximum tensile steel wire
- Cover** : Polyamide
- Standard colour** : blue

TEMPERATURE RANGE -10°C up to +70°C

Design Factor >2:1

#												
	DN	size	mm	inch	mm	MPa	psi	MPa	psi	mm	kg/m	
2448D-025V32-TC	4	-025	4.0	5/32	9.9	301	43640	650	94240	100	0.21	



NOTES

Hoses with design factor >2:1

6YHLX – 6HYLX

6YHLX – UNF male nozzle nipple

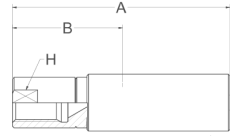

MATERIAL Stainless steel

NOTE ProLance fitting

#	⊙				⌚	A	B	R	⌚		Nipple ID	Ferrule OD
	DN	size	mm	inch					MPa	psi		
6YHLX-4-2AC-PL	4	-025	4.0	5/32	1/4 - 28 UNF	58	26	8	301	43645	1.6	11.6
6YHLX-4-2AC-PL-LH	4	-025	4.0	5/32	1/4 - 28 UNF LH	58	26	8	301	43645	1.6	11.6
6YHLX-6-2AC-PL-LH	4	-025	4.0	5/32	3/8-24 UNF LH	62	30	10	301	43645	1.6	11.6

6HYLX – UNF female for water jetting nozzle

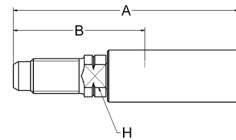

MATERIAL Stainless steel

NOTE *ProLance fitting



#	⊙				⌚	A	B	R	⌚		Nipple ID	Ferrule OD
	DN	size	mm	inch					MPa	psi		
6HYLX-4-2AC-PL	4	-025	4.0	5/32	1/4 - 28 UNF	51	19	9	301	43645	1.6	11.6
6HYLX-4-2AC-PL-LH	4	-025	4.0	5/32	1/4 - 28 UNF LH	51	19	9	301	43645	1.6	11.6
6HYLX-6-2AC-PL-LH	4	-025	4.0	5/32	3/8 - 24 UNF-LH	49	21	11	301	43645	1.6	11.6

Design Factor >2:1

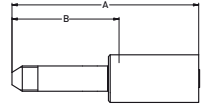
**6Y4LX – High pressure tube nipple
 UNF – LH thread**



MATERIAL Stainless steel



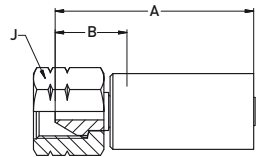

#						A	B			Nipple ID	Ferrule OD
	DN	size	mm	inch				MPa	psi		
6Y4LX-4-2AC	4	-025	4.0	5/32	1/4 - 28UNF-LH	75	44	400	58000	1.6	14.4
6Y4LX-6-2AC	4	-025	4.0	5/32	3/8 - 24UNF-LH	86	55	400	58000	1.6	14.4

Design Factor >2:1

6AYLX – Type “M” female swivel



MATERIAL Stainless steel

#						A	B				Nipple ID	Ferrule OD
	DN	size	mm	inch					MPa	psi		
6AYLX-6-2AC	4	-025	4.0	5/32	9/16 - 18 UNF	64	33	17	301	43645	1.6	14.4