

Brass Compression Fittings / Tube-to-Tube Fittings

0106 Equal Tube-to-Tube Connector

Brass

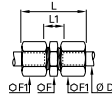

ØD		F	F1	L max	L1	Kg
4	0106 04 00	10	10	28	10	0.016
5	0106 05 00	11	12	31	11	0.023
6	0106 06 00	11	13	32	11	0.026
8	0106 08 00	13	14	36	10	0.031
10	0106 10 00	17	19	42	13	0.070
12	0106 12 00	19	22	42	13	0.091
14	0106 14 00	22	24	45	11	0.103
15	0106 15 00	22	24	45	11	0.096
16	0106 16 00	24	27	48	13	0.145
18	0106 18 00	27	30	53	14	0.190
20	0106 20 00	30	32	56	14	0.217
22	0106 22 00	32	36	60	14	0.281
28	0106 28 00	41	42	64	14	0.398

0102 Equal Elbow

Brass

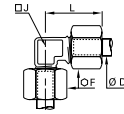

ØD		F	J	L max	Kg
4	0102 04 00	10	5	19	0.017
5	0102 05 00	12	8	21	0.025
6	0102 06 00	13	8	22	0.027
8	0102 08 00	14	10	28	0.038
10	0102 10 00	19	12	30	0.072
12	0102 12 00	22	15	30	0.097
14	0102 14 00	24	19	35	0.133
15	0102 15 00	24	19	35	0.122
16	0102 16 00	27	19	39	0.168
18	0102 18 00	30	23	41	0.236
20	0102 20 00	32	23	42	0.238
22	0102 22 00	36	27	50	0.375
28	0102 28 00	42	32	54.5	0.473

0116 Equal Bulkhead Connector

Brass

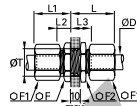

ØD		F	F1	F2	L max	L1 max	L2	L3	ØT min	Kg
4	0116 04 00	10	10	13	27	17	7	17	8.3	0.024
5	0116 05 00	13	12	14	28	18	7.5	17.5	10.3	0.035
6	0116 06 00	13	13	14	28	19	7.5	17.5	10.3	0.037
8	0116 08 00	14	14	17	29	20	7	17	12.3	0.045
10	0116 10 00	19	19	22	33	25	9	19	16.5	0.100
12	0116 12 00	22	22	22	33	25	9	19	18.5	0.121
14	0116 14 00	24	24	24	35	25	8	18	20.5	0.143
15	0116 15 00	24	24	24	35	25	8	18	20.5	0.134
16	0116 16 00	27	27	27	36	28	9.5	19.5	22.5	0.192
18	0116 18 00	27	30	30	40	30	10.5	20.5	24.5	0.238
20	0116 20 00	32	30	32	41	31	11	21	27.5	0.275
22	0116 22 00	36	36	36	42	32	11	21	30.5	0.379

0104 Equal Tee

Brass

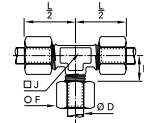

ØD		F	H	J	L/2	Kg
4	0104 04 00	10	9.5	8	19	0.029
5	0104 05 00	12	11	8	21	0.037
6	0104 06 00	13	11	8	22	0.040
8	0104 08 00	14	15	10	28	0.054
10	0104 10 00	19	14.5	12	30	0.104
12	0104 12 00	22	15	15	30	0.140
14	0104 14 00	24	18	19	35	0.190
15	0104 15 00	24	18	19	35	0.171
16	0104 16 00	27	21	19	39	0.245
18	0104 18 00	30	21.5	23	41	0.328
20	0104 20 00	32	21.5	23	42	0.336
22	0104 22 00	36	29	27	50	0.520

0142 Equal Y Piece with Mounting Boss

Brass

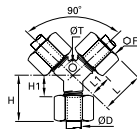

ØD		F	H max	H1	L max	L1	ØT	Kg
4	0142 04 00	10	16.5	7	26.5	17	4.2	0.031
6	0142 06 00	13	19.5	8.5	28	17	4.2	0.047
8	0142 08 00	14	21	8	30	17	6.2	0.059

0107 Equal Cross

Brass

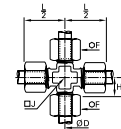

ØD		F	H	J	L/2	Kg
6	0107 06 00	13	11	8	22	0.052
8	0107 08 00	14	15	11	28	0.073
10	0107 10 00	19	14.5	14	30	0.141
12	0107 12 00	22	15	15	35	0.231
14	0107 14 00	24	18	20	35	0.244